

**Mr. Gary & Mrs Elaine Bohning.
Arltunga Prospecting & Associates.
P.O. Box 856,
ALICE SPRINGS. N.T. 0871**

**Department of Mines and Energy.
Minerals Titles Division.
G.P.O. Box 4550,
DARWIN. N.T. 0801**

Dear Team Leader,

ANNUAL REPORT M.C 157 & M.L. 30493.

Amalgamated Reporting Application # GR430

Please note that MCS 209 has been converted into ML 30493.

Title Holders.

M.C.S. 157 Gary Bohning & Elaine Bohning.

M.L. 30493 Gary Bohning.

MINERAL CLAIM 157 & MINERAL LEASE ARE BOTH

UNDER CARE AND MAINTENANCE. WITH NIL ACTIVITY.

MMP 0127-04.

1.0 PROJECT OUTLINE.

The Whites Gully Project is a small alluvial gold operation which operates on an intermittent basis when sufficient surface water is available for the simple sluice recovery process. We have been unsuccessful to locate any under groundwater supply in the general area thus far.

The project is situated in the Arltunga area, approximately 110 kms East of Alice Springs.

We have been sending reports for both MC157 and ML30493 together on one report for some time now.

2.0 MINING.

There has been NO Trenching - Costeening - Drilling - Clearing - Alluvial Workings.

Hard Rock Mining or any other activities carried out during this period of time from 01st January, 2016 to 31st December, 2016.

The only activity on site is weekly patrols by the operators to ensure that signage, locked access gate and on site plant & equipment have not been vandalized or stolen. There have been no instances of this occurring over the duration of the granting of the Mineral Claim / Mineral Lease.

3.0 HAZARD ID – RISK RATINGS AND CONTROL MEASURES.

There is no Chemicals or Hazardous materials used or stored on this site.

Diesel fuel and motor oils is kept on the lease in sealed 200 litre drums.

There is no bulk fuel held on site. Two household gas bottles for cooking held on site.

The only hazard which could occur is a vehicle (4WD) accident whilst undertaking the regular 'Care and Maintenance visits on these leases. This is rated a very low risk due to the following control measures. No other vehicles operating on the lease, our vehicles used are well maintained with current registration and operated by experienced licensed drivers, site is always visited by 2 persons. Vehicle and personnel have satellite phones with them at all times, emergency contact numbers known by both persons. We both have had First Aid training.

4. **STATUTORY OBLIGATIONS.**

1. **Have been met.**
Including the monitoring and control of weeds, feral animals, flora and fauna, fire breaks, erosion, roads and boundary lines.
Datum poles and witness posts.
2. **Regular dialogue with stake holders will continue, which include Pastoralists, other Mining Stakeholders, Parks, and Traditional Owners within the local area.**
3. **Rehabilitation .**
When any instances arise the matter will be rectified, as soon as possible.

5. **OUR OPTIONS.**

1. **Use these leases in an I.P.O. or Joint Venture.**
2. **To restart operations when appropriate.**
3. **Tourism.**

6. **MANAGEMENT STRUCTURE.**

The management structure consists of a husband and wife team of equal partnership. Both are responsible persons.
There are no other employees.
This project is a small scale manually operated mine operation.

7. **SUMMARY OF EXTRACTIVE PROGRAM.**

This mining project is a very small manually operated mining operation by two persons. Currently under a Care and Maintenance program with NIL ACTIVITY.

No activity at the Project Site is planned for 2017 for the time being. When there are plans to change the status quo we will apply for a new Mine Management Plan

8. **OTHER RELEVANT INFORMATION.**

This project is currently under care and maintenance.

Inspections are carried out on a weekly basis.

Any maintenance issues identified will be actioned within a three month period. Any issues requiring immediate action will be addressed immediately or as soon as practicable.

9. **CONTACT DETAILS.**

Owner / Operator: Gary and Elaine Bohning.

Address: P.O. Box 856, Alice Springs. N.T. 0871

Phone. (08) 89569770. Fax. (08) 89569819.

Email: Gary.Bohning@nt.gov.au

If any further information is required please do not hesitate to contact us on the above contact details.

Both titles are currently operated by Gary & Elaine Bohning trading as Arltunga Prospecting & Associates.

Project Description

Location

The Whites Gully Project is located approximately 100km by road east north east of Alice Springs in the Northern Territory. It is approximately 8km west of the Arltunga Historical Reserve on Ambalindum Pastoral Lease.

Access is by way of the Ross Highway for 75km until the turn off to Arltunga. It is then a further 35km on an unsealed road to Arltunga.

The closest populated communities are Alice Springs approximately 100km to the west south west, Santa Teresa, approximately 84km to the south west, Ross River Resort, which has a varying population, higher in the winter season is located approximately 30km to the south west. Part of the access road to Whites Gully is on the popular "Binns Track" tourist drive to Arltunga and Ruby Gap Nature Reserve.

ML
30493
8.00 Hectares

Large Hill

MC
157

The Camp site
We're situated on
a small hill

Legend

- Track -----
- Alluvial +++++
- Elluvial =====
- Creek ~~~~~
- Dam [|||||]
- Building []
- stock Pile [S.P.]

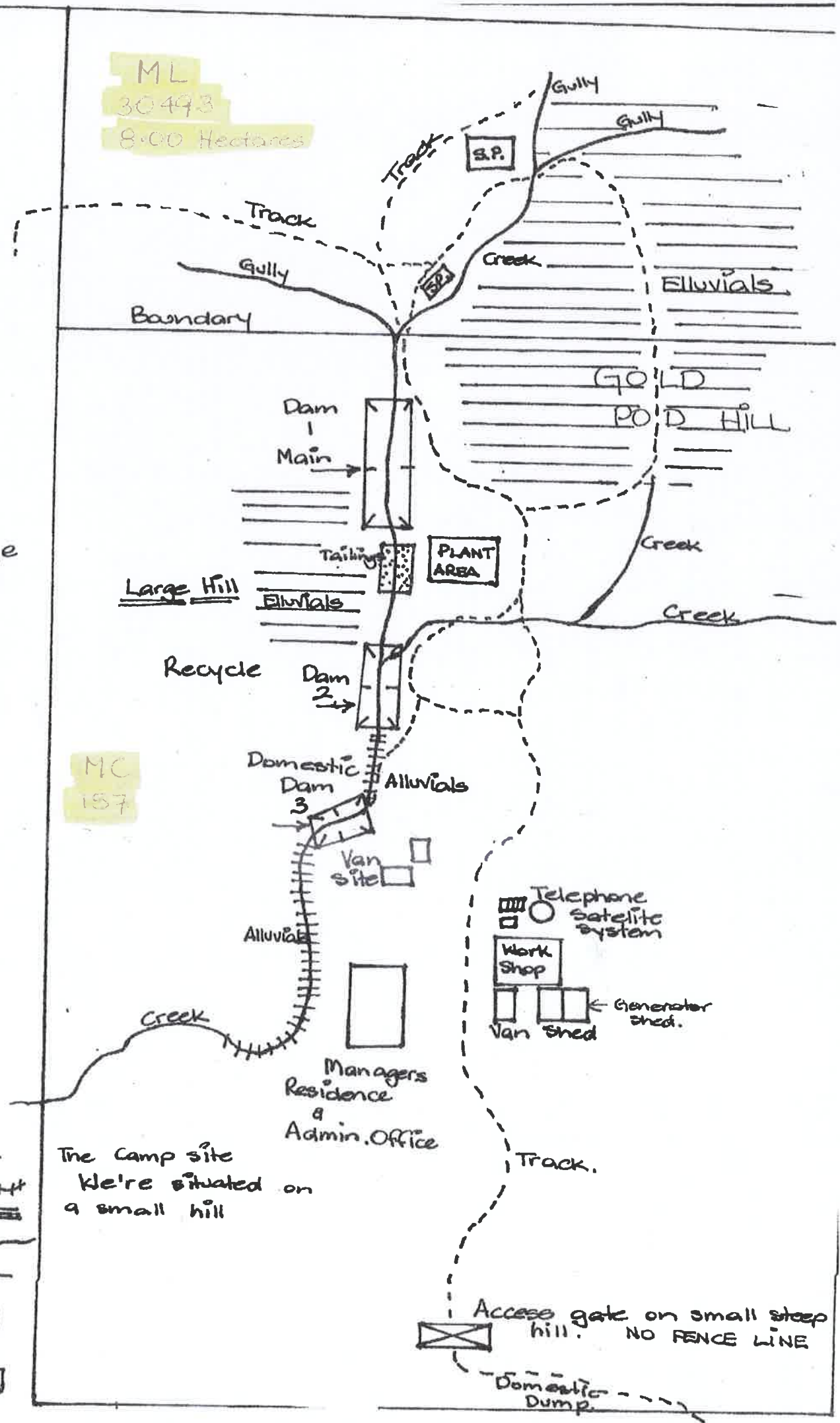

Access gate on small steep hill. NO FENCE LINE

Domestic Dump

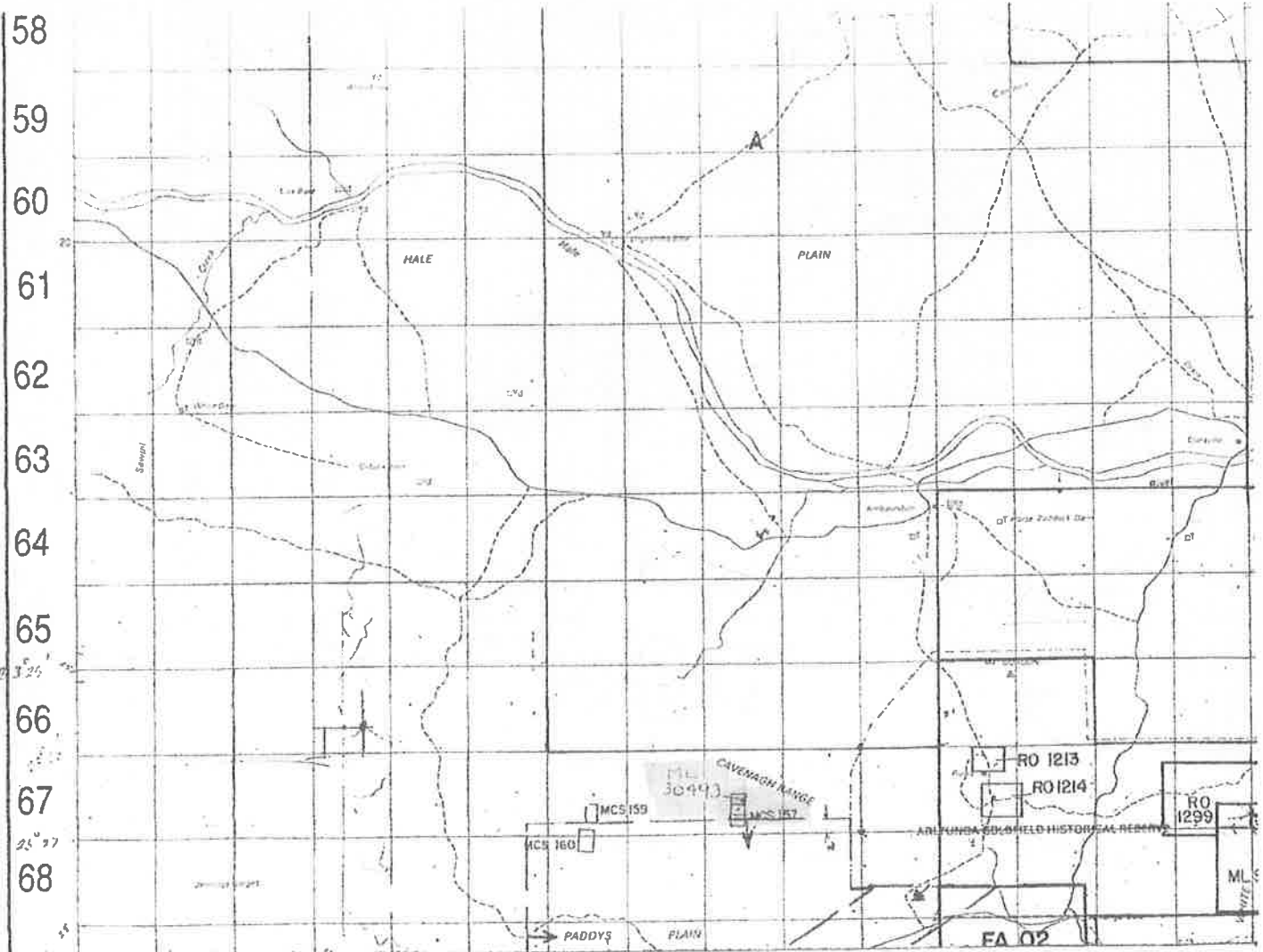

Second Schedule
(Plan of Area)

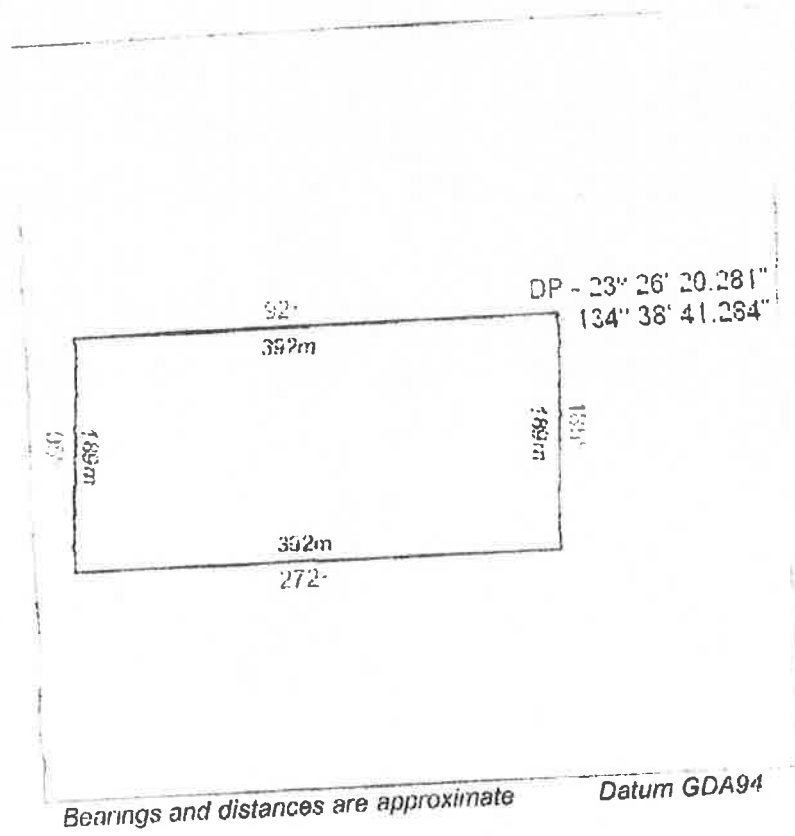

ML30493
8.00 Hectares

Whites Gully Project

6

Location Map of Whites Gully Project MLC157 & ML30493

