

Mc ARTHUR RIVER MINING

DIAMOND DRILL HOLE HEADER SUMMARY SHEET

HOLE I.D.	:98/8	LOCATION (eg.drive name)	:4B1/1
GRID AZIMUTH	:275	DESIGN DEPTH (m)	:130
COLLAR INCLINATION	:20	TOTAL DEPTH (m)	:140.5
<u>SURVEYED COLLAR CO-ORDINATES</u>		DATE STARTED	:20/02/98
EASTING	:7104.585	DATE FINISHED	:27/02/98
NORTHING	:1903.900	DRILLED BY	:LONGYEAR
RL	:9933.700	<u>CORE INTERVALS ASSAYED:</u>	
HOLE/CORE SIZE(S)	:LTK-48	N/A	
LOGGED BY	:MSF		
D/HOLE SURVEY METHOD	:EASTMAN SS	LOCAL MAG. DEV.	: + 5
		(add to downhole survey azim. reading)	

RAW DOWNHOLE SURVEY DATA

Depth (m)	Azimuth(Mag)	Dip	Depth (m)	Azimuth(Mag)	Dip
10	273	21	120	274.5	20
30	274	21	140.5	275	20
60	274	21			
90	274	20			

ASSAY SUMMARY

O/B	TT	Zn%	Pb%	Ag g/t	Fe%

Surveyed Collar & Geology Entered Into Micromine Database

☐ :NS 6/04/98

Assays Entered Into Micromine Database

☐ :N/A

Surveyed Collar & Geology Transferred Into Vulcan Database

☐ :

Assays Transferred Into Vulcan Database

☐ :

Comments: TARGETED TO INTERSECT #20B IN THE HINGE ZONE BUT INTERSECTED LARGE
(>10m) FAULT, ENDING IN WFS.
VAN RUTH SSG PACKER @ 5M DEPTH

Mc ARTHUR RIVER MINING

DIAMOND DRILL HOLE PROPOSAL FORM

HOLE I.D. : 98/8

LOCATION (eg.drive name) : 4B1/1

PROPOSED START DATE : FEB 98

DESIGN AZIMUTH (GRID) : 275

DESIGN DEPTH : 130m

DESIGN INCLINATION : +20°

ESTIMATE COLLAR CO-ORDINATES

SURVEYED COLLAR CO-ORDINATES

EASTING : 7104.3

EASTING : 7104.585

NORTHING : 1903.5

NORTHING : 1903.9

RL : 9935.0

RL : 9933.700

GEOLOGIST : SP

SURVEYOR : Jason

LOCATION SKETCH

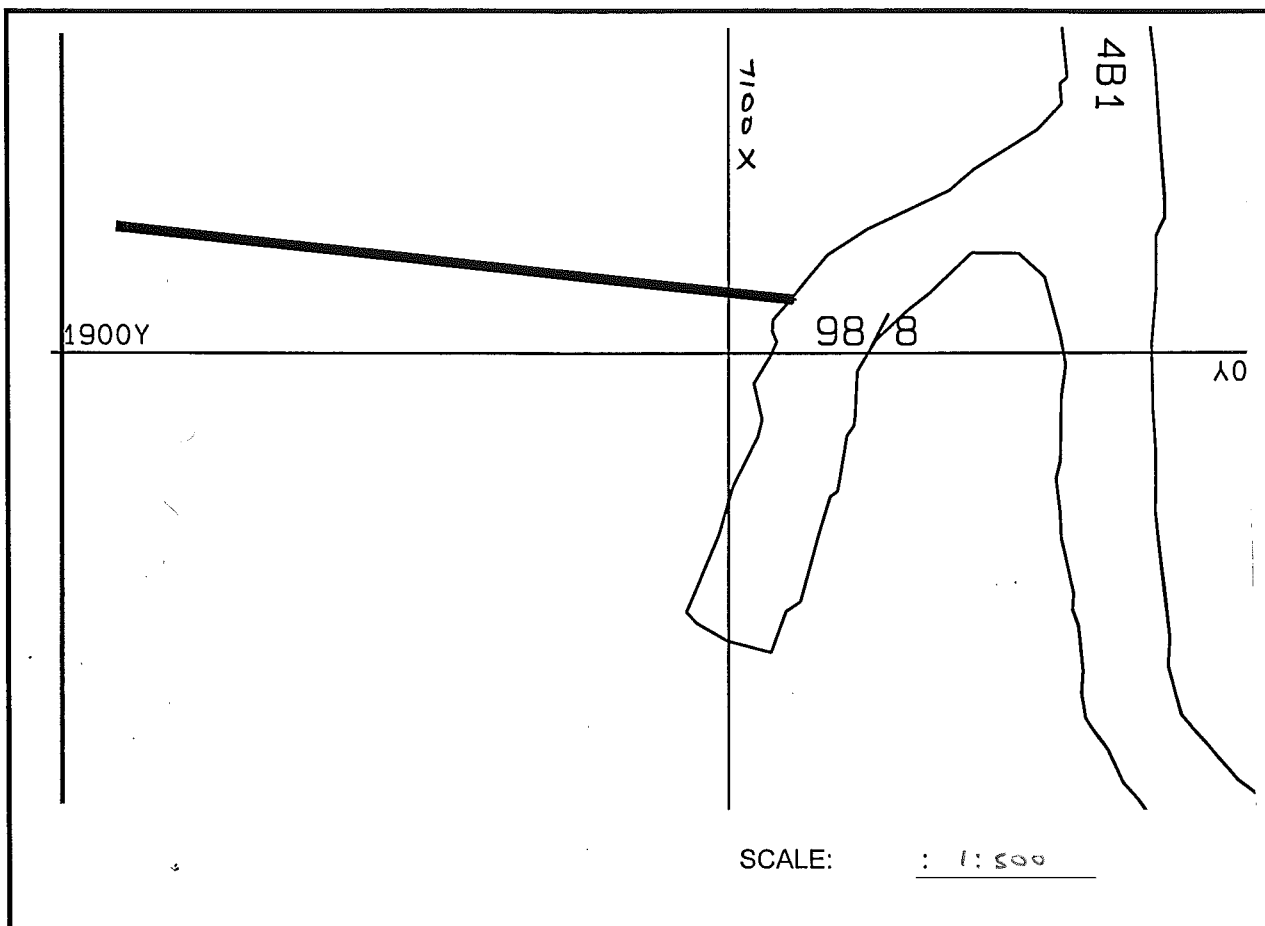

Comments:

9418 - 95 20 - 140.5
93/9 - 0.5 - 5

McARTHUR RIVER MINING GEOLOGICAL LOG SHEET																			
70298										GEO		DATE		HOLE		PAGE		VERSION	
										17/		13/3		16/01/95					
										17/		13/3		16/01/95					
										17/		13/3		16/01/95					
										17/		13/3		16/01/95					
										17/		13/3		16/01/95					
										17/		13/3		16/01/95					
										17/		13/3		16/01/95					
										17/		13/3		16/01/95					
										17/		13/3		16/01/95					
										17/		13/3		16/01/95					
										17/		13/3		16/01/95					
										17/		13/3		16/01/95					
										17/		13/3		16/01/95					
										17/		13/3		16/01/95					
										17/		13/3		16/01/95					
										17/		13/3		16/01/95					
										17/		13/3		16/01/95					
										17/		13/3		16/01/95					
										17/		13/3		16/01/95					
										17/		13/3		16/01/95					
										17/		13/3		16/01/95					
										17/		13/3		16/01/95					
										17/		13/3		16/01/95					
										17/		13/3		16/01/95					
										17/		13/3		16/01/95					
										17/		13/3		16/01/95					
										17/		13/3		16/01/95					
										17/		13/3		16/01/95					
										17/		13/3		16/01/95					
										17/		13/3		16/01/95					
										17/		13/3		16/01/95					
										17/		13/3		16/01/95					
										17/		13/3		16/01/95					
										17/		13/3		16/01/95					
										17/		13/3		16/01/95					
										17/		13/3		16/01/95					
										17/		13/3		16/01/95					
										17/		13/3		16/01/95					
										17/		13/3		16/01/95					
										17/		13/3		16/01/95					
										17/		13/3		16/01/95					
										17/		13/3		16/01/95					
										17/		13/3		16/01/95					
										17/		13/3		16/01/95					
										17/		13/3		16/01/95					
										17/		13/3		16/01/95					
										17/		13/3		16/01/95					
										17/		13/3		16/01/95					
										17/		13/3		16/01/95					
										17/		13/3		16/01/95					
										17/		13/3		16/01/95					
										17/		13/3		16/01/95					
										17/		13/3		16/01/95					
										17/		13/3		16/01/95					
										17/		13/3		16/01/95					
										17/		13/3		16/01/95					
										17/		13/3		16/01/95					
										17/		13/3		16/01/95					
										17/		13/3		16/01/95					
										17/		13/3		16/01/95					
										17/		13/3		16/01/95					
										17/		13/3		16/01/95					
										17/		13/3		16/01/95					
										17/		13/3		16/01/95					
										17/		13/3		16/01/95					
										17/		13/3		16/01/95					
										17/		13/3		16/01/95					
										17/		13/3		16/01/95					
										17/		13/3		16/01/95					
										17/		13/3		16/01/95					
										17/		13/3		16/01/95					
										17/		13/3		16/01/95					
										17/		13/3		16/01/95					
										17/		13/3		16/01/95					
										17/		13/3		16/01/95					
										17/		13/3		16/01/95					
										17/		13/3		16/01/95					
										17/		13/3		16/01/95					
										17/		13/3		16/01/95					
										17/		13/3		16/01/95					
										17/		13/3		16/01/95					
										17/		13/3		16/01/95					
										17/		13/3		16/01/95					
										17/		13/3		16/01/95					
										17/		13/3		16/01/95					
										17/		13/3		16/01/95					
										17/		13/3		16/01/95					
										17/		13/3		16/01/95					
										17/		13/3		16/01/95					
										17/		13/3		16/01/95					
										17/		13/3		16/01/95					
										17/		13/3		16/01/95					
										17/		13/3		16/01/95					

McARTHUR RIVER MINING

VERSION

16/01/95

FOR

PAGE

5

27

GC

DATE _____

GENERAL LOG SHEET

07070

IN ADDITIONAL TRAINING

DISCUSSION

11

VI

1

7102198

[illegible]

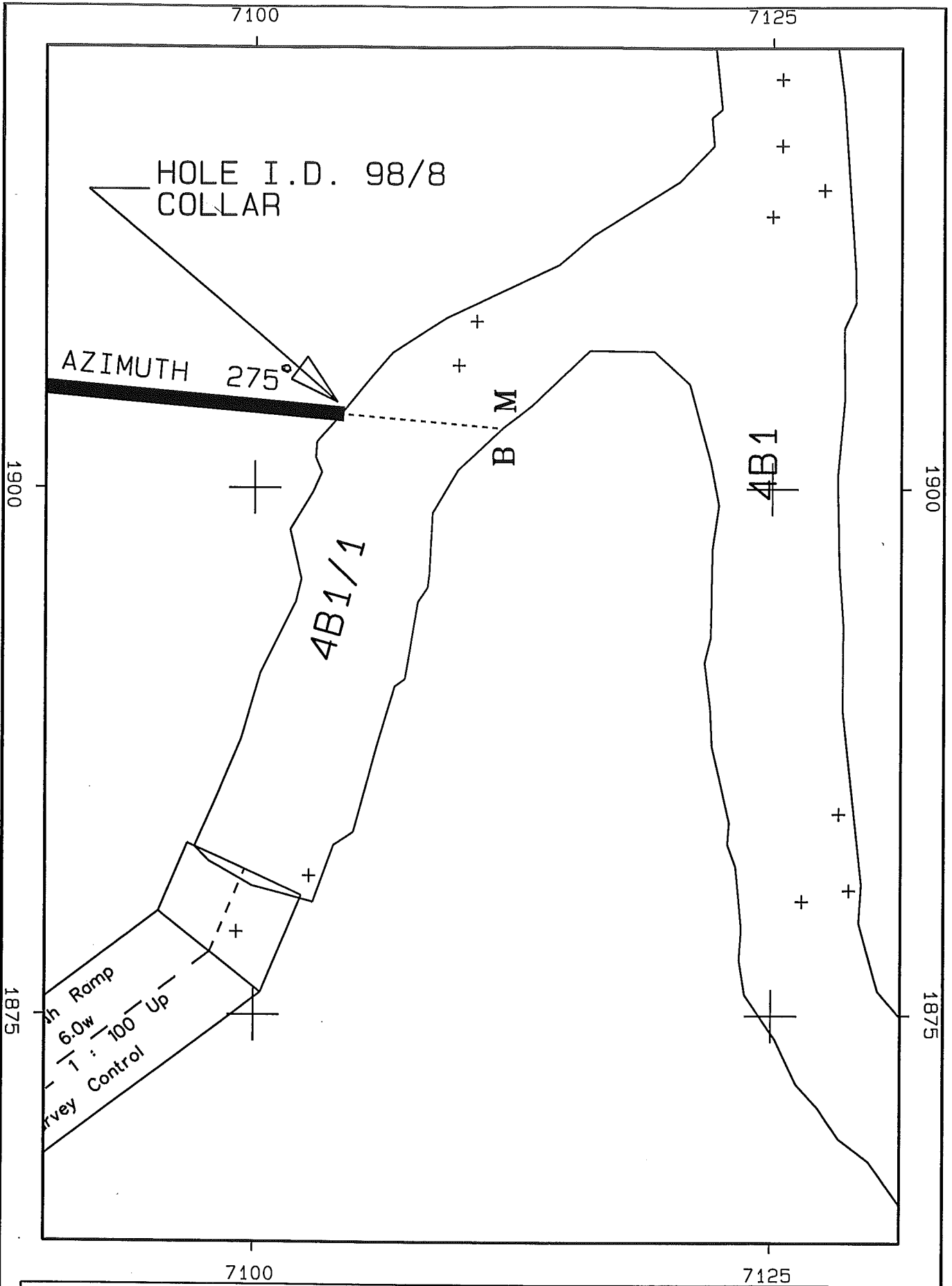

4B1/1 DRILL COLLAR

Markup Memo

DRAWING No. : 1474

Drawn : NEV

Reviewed :

Date : 8-Feb-98

Scale : 1:250

