

E.L.26951_2012_A

Titleholder: Magic Place Pty Ltd

Tenement Manager: Mr David J Langley Ph. 0427861644

Project Name: Steve's Hill

Report Title: Annual Report Year 3

Author: Mr David J Langley

Target Commodity: Gold

Date of Report: 7/9/2012

Datum/Zone GDA94/Zone 52

Map Sheet: MARRAKAI 1:50,000 (WGS 84)

Contact Details: Magic Place Pty Ltd
PO Box 100
Darwin 0801

Phone: Mr. D. Langley 0427861644
Mr. E. Chin 0418862888

Email: nt_prospector@hotmail.com
erniechin@ozemail.com.au

EXPLORATION SUMMARY E.L.26951_2012_A

Exploration work this year was centered mostly on the Magnetic dislocation on the S.E. block.. (Refer to attached Topo Map and Magnetics graphic).

Because most of the gold in the area is nuggety, we employed seven experienced men to thoroughly detect the area of the magnetic dislocation using Minelab 5000 metal detectors. The men spent seven hours in the area but no gold was detected. Rock chips and panned soil samples also showed no gold in this area. Previous work by Renison Consolidated did not cover this area.

The only significant gold results were two small nuggets that were detected in the "John's Reef" area. This reef was found and drilled by Renison about five years ago and it gave some high grade results.

Two 5 kg samples (140044 & 45) of -2mm gravel that I took 40 metres and 125 metres South West of John's Reef both showed one coarse speck and one fine speck of gold. Further trenching in this area is required. A substantial disturbance application has already been submitted.

D J Langley

 7/9/12

ASSAY RESULTS: (NOTE: Soil samples were -2mm & panned)

Sample No.	Coordinates (GDA94)		Type:	Results (Au)
140034	52 762883E.	8 588698N	Soil	Nil vis. Au
140035	52 762753E.	8 588538N	+2mm Qtz.	L
140036	52 762891E.	8 588801N	Silt Stone	L
140037	52 764555E.	8 586579N	Laterite	.01 L
140038	52 764438	8 586600N	Magnetite	L
140039	52 764430	8 586576	Qtz floater	L
140040	52 764430	8 586576	Soil	Nil vis. Au
140041	52 764960	8 586062	Qtz reef	.01
140042	52 764338	8 588 077	Qtz Reef	1.65 1.91
140043	Grab sample for 30m NNE along above reef			L
140044	52 764302	8 588058	Soil	1 coarse Au 1 fine Au
140045	52 764200	8 587982	Soil	1 Coarse Au 1 fine Au
140046	52 764 400	8 588196	Soil	Nil Au.

North Australian Laboratories fire assay results are attached next page.

NA 13683	8SAM	0SNI3COL				
DL300812		310812 Au		Au(R)	Au(R)	
DATA STORE	UNITS	ppm		ppm	ppm	
LLD's in	STORE UNITS		0.01		0.01	0.01
CO						
CO						
	140035 L					
	140036 L					
	140037		0.01 L			
	140038 L					
	140039 L					
	140041		0.01			
	140042		1.65		1.91	
	140043 L					

E.L. 26951

EL 22068

x STEVE'S HILL Au. 500 OZS.

x Au.
x John's Flat Reef Au.

x Au
x CHIN'S GULLY Au.

x Nil Au

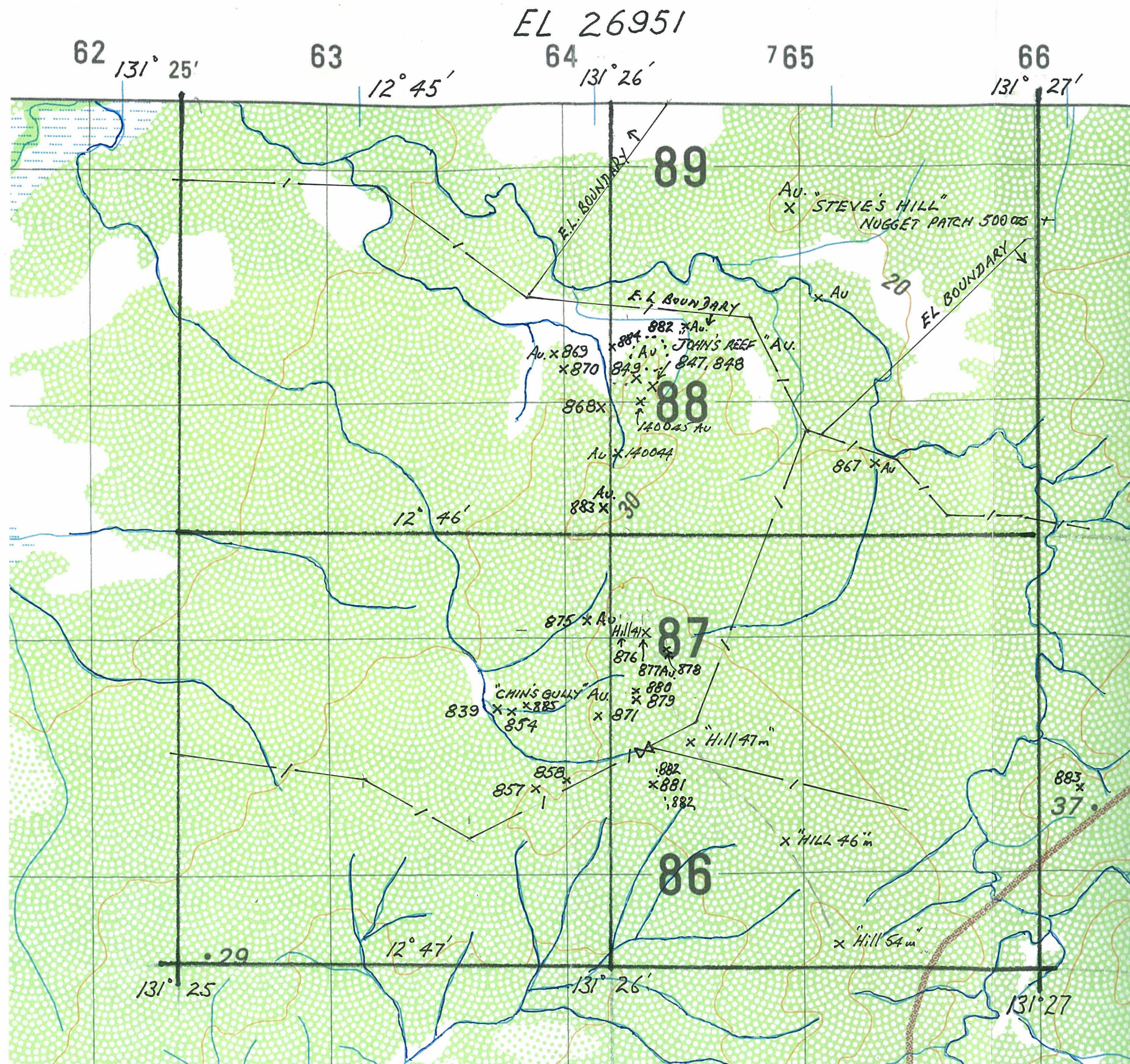

E.L. BOUNDARIES GDA 94

MAP DATUM. WGS 84

DRAWN: J. LANGLEY