

### Tennant Creek Project Location Map

**Datum:** GDA94  
**Projection:** MGA94 Zone 53  
**Drawn By:** BC  
**Date:** 31/10/2011

#### LEGEND

- Creek / River
- Principal Road
- Secondary Road
- Minor Road
- - - Track
- Park
- SOCS
- Vale Tenement
- Aus\_States



1:500,000 at A4

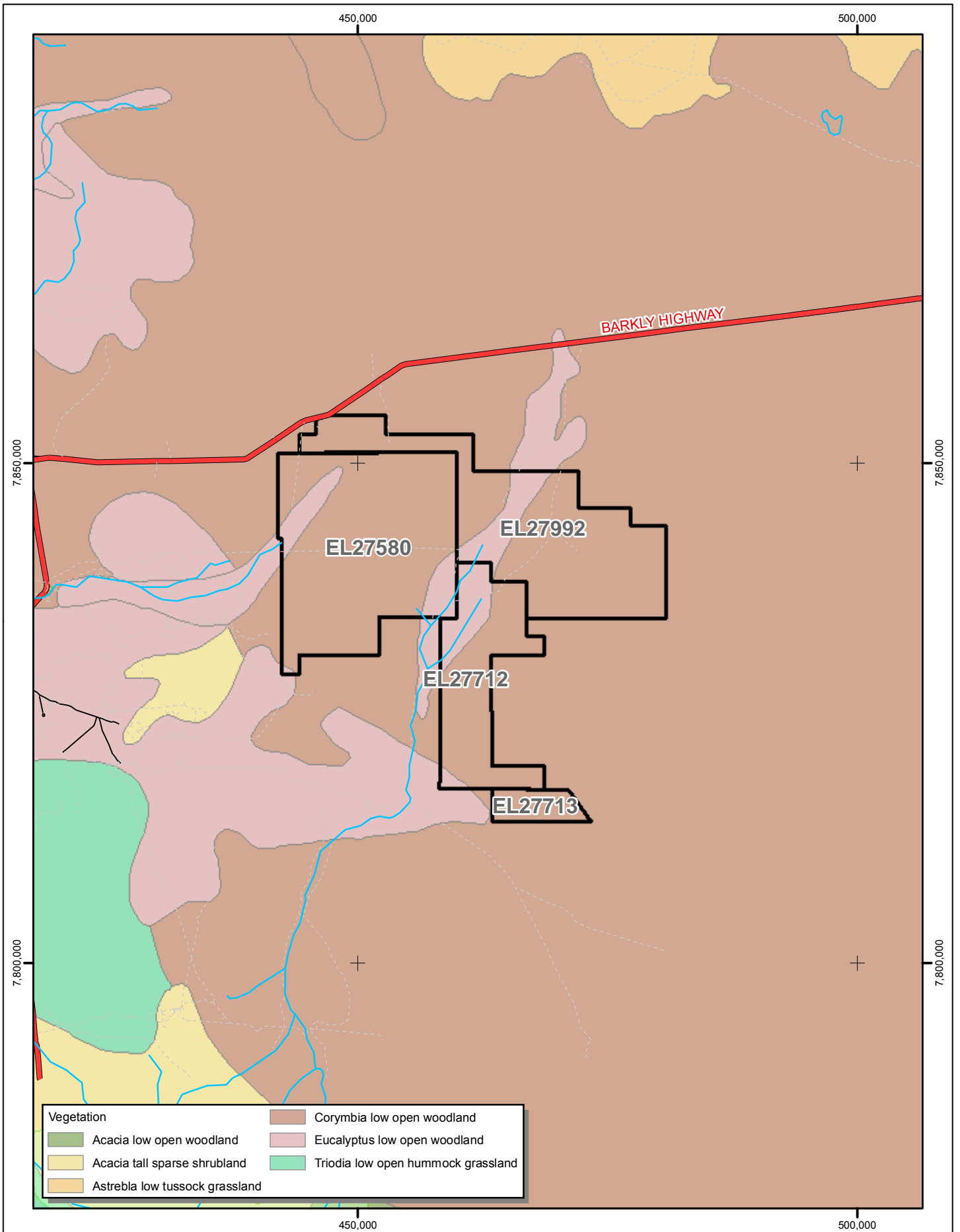

| Vegetation  |                                    |
|---|------------------------------------|
|  | Acacia low open woodland           |
|  | Acacia tall sparse shrubland       |
|  | Astrebla low tussock grassland     |
|  | Corymbia low open woodland         |
|  | Eucalyptus low open woodland       |
|  | Triodia low open hummock grassland |



### Tennant Creek Project Vegetation Map

**Datum:** GDA94  
**Projection:** MGA94 Zone 53  
**Drawn By:** BC  
**Date:** 7/11/2011

#### LEGEND

-  Creek / River
-  Principal Road
-  Minor Road
-  Track
-  Park
-  SOCS
-  Vale Tenement

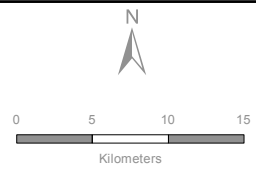

1:500,000 at A4

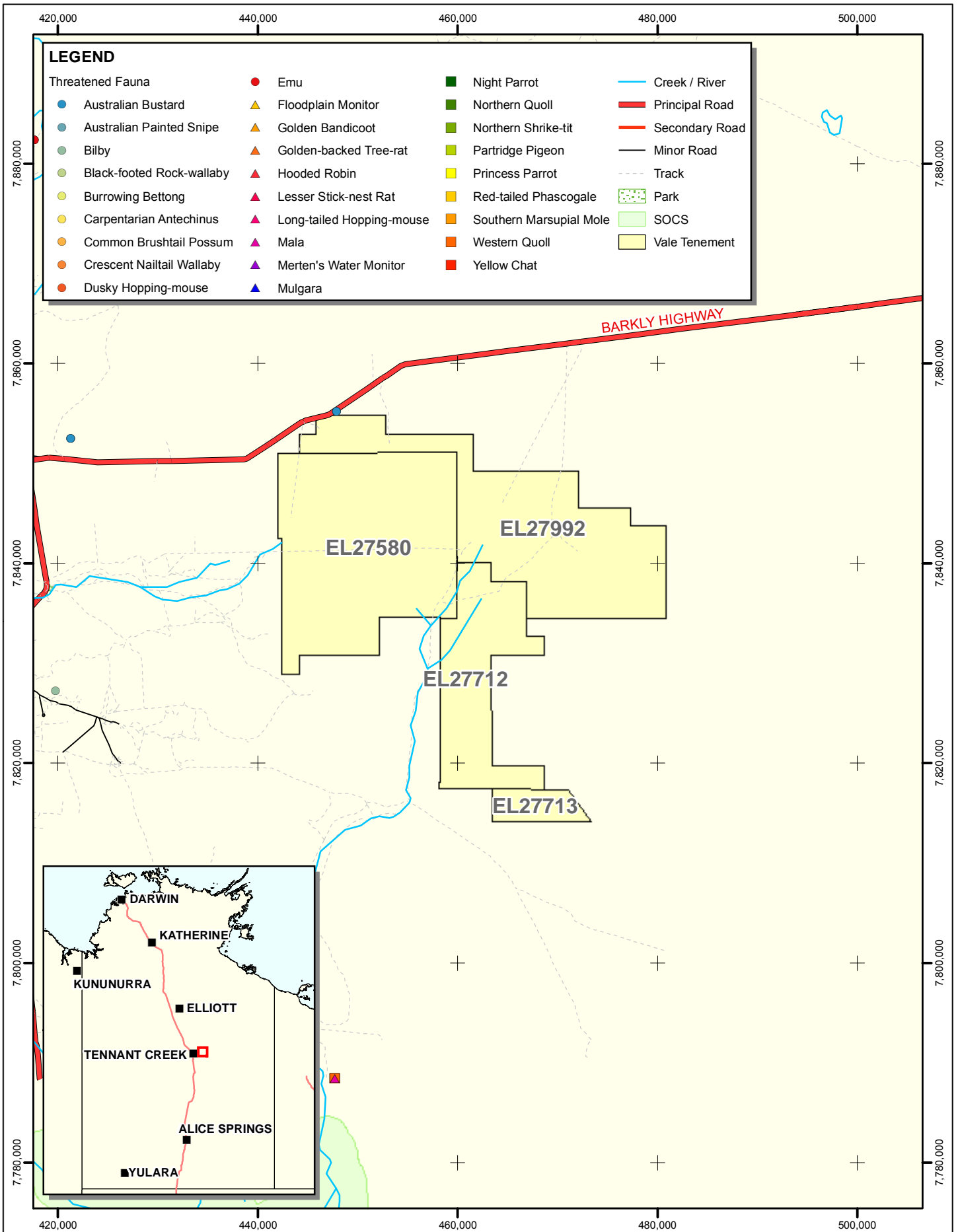

### Tennant Creek Project Fauna Map

**Datum:** GDA94  
**Projection:** MGA94 Zone 53  
**Drawn By:** BC  
**Date:** 31/10/2011

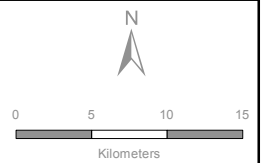

1:500,000 at A4

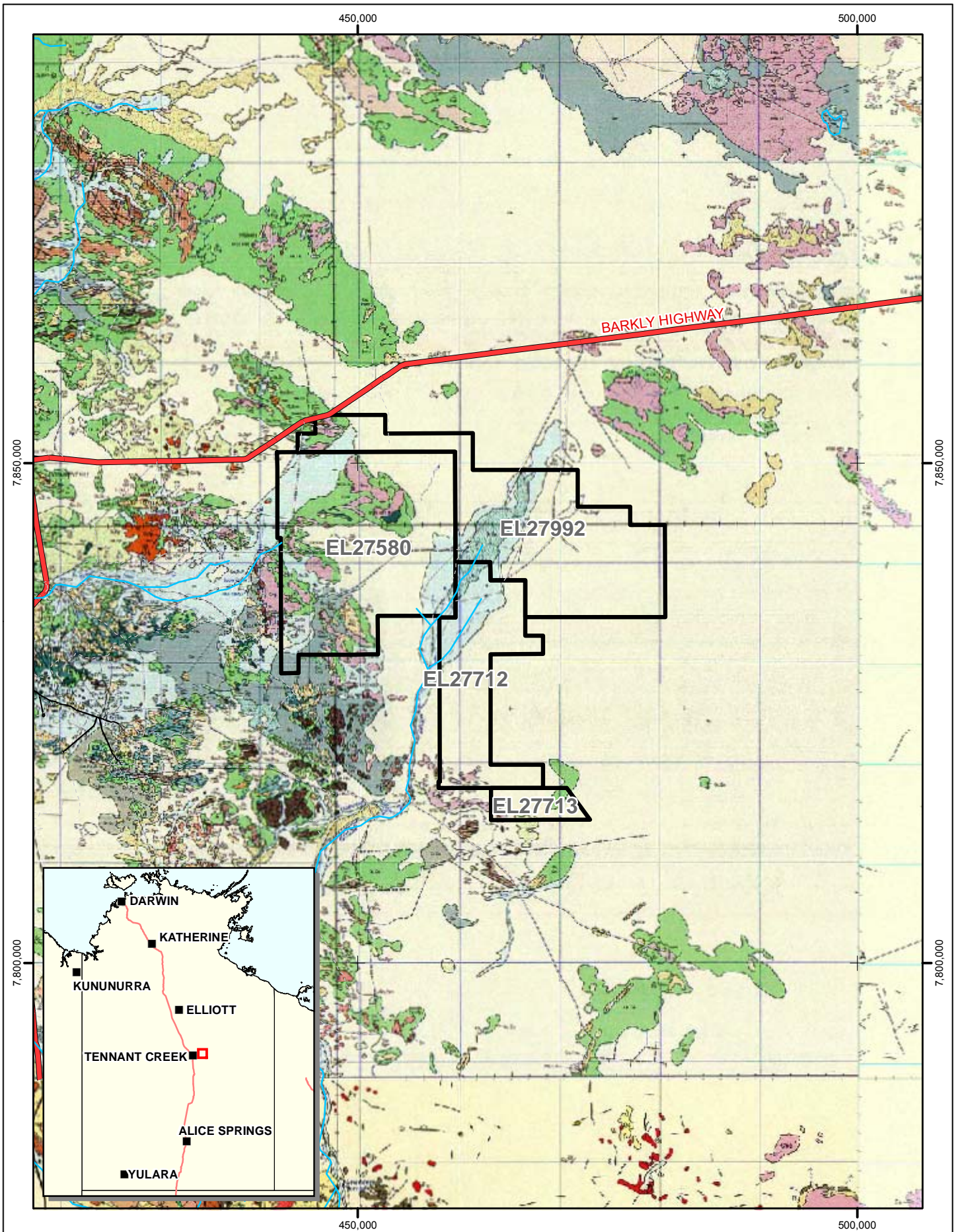

### Tennant Creek Project

Geology - NTGS Base

**Datum:** GDA94  
**Projection:** MGA94 Zone 53  
**Drawn By:** BC  
**Date:** 31/10/2011

### LEGEND

- Principal Road
- Secondary Road
- Minor Road
- Track
- Creek / River
- Vale Tenement



1:500,000 at A4

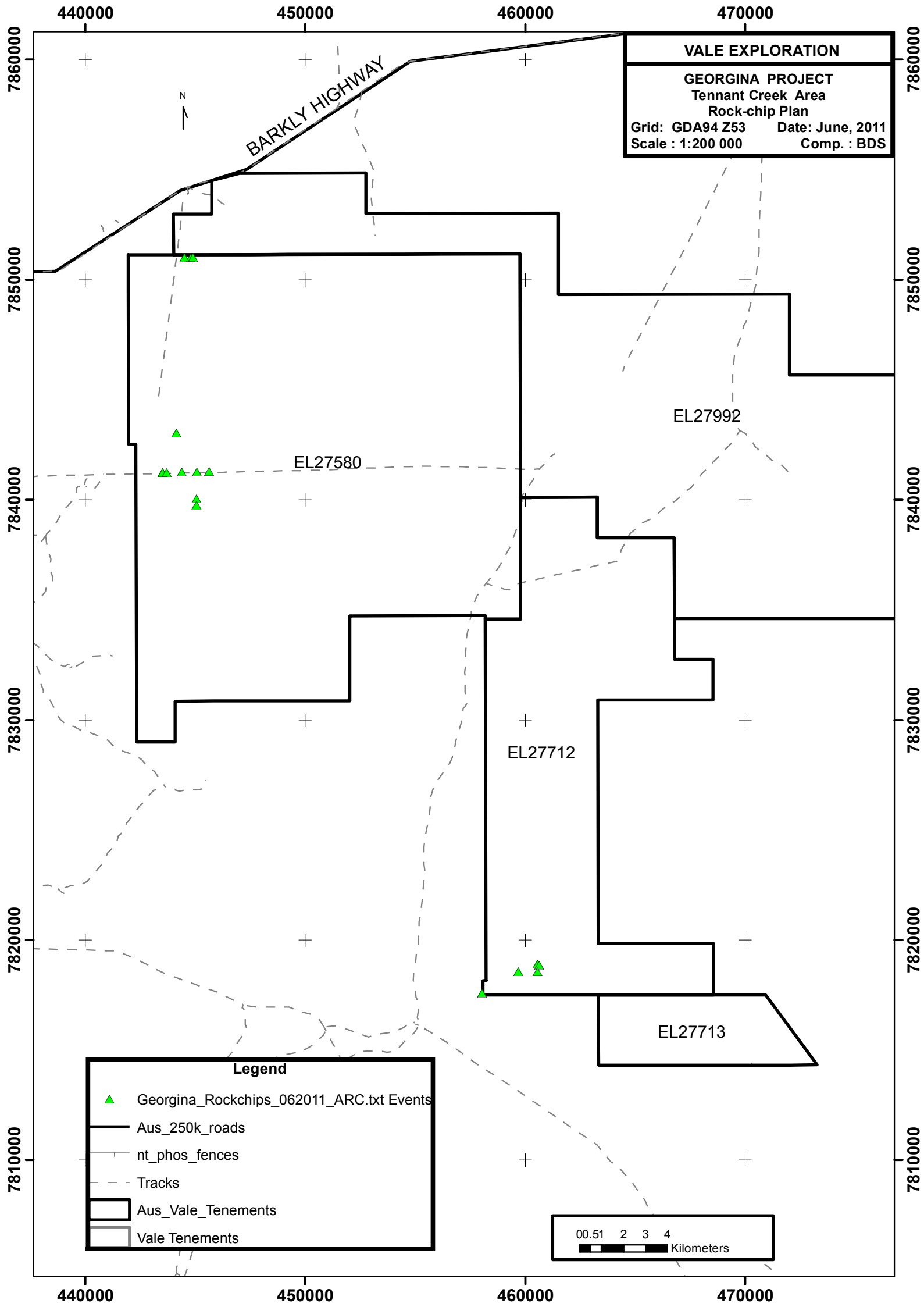

VALE EXPLORATION

GEORGINA PROJECT  
Tennant Creek Area  
Rock-chip Plan

Grid: GDA94 Z53  
Scale : 1:200 000

Date: June, 2011  
Comp. : BDS

BARKLY HIGHWAY

N

EL27992

EL27580

EL27712

EL27713

**Legend**

- ▲ Georgina\_Rockchips\_062011\_ARC.txt Events
- Aus\_250k\_roads
- nt\_phos\_fences
- Tracks
- Aus\_Vale\_Tenements
- Vale Tenements

00.51 2 3 4  
Kilometers

