

Summary of work completed on the tenements that overlap the Yamba Project Tenements (EL 28175)

Kelly Sharrad

EL 28175	Yamba Project
EL	7570
EL	22761
EL	10401
EL	5268
EL	3557
EL	3541
EL	3496
EL	4420
EL	57
EL	1342
EL	1341
EL	2618
EL	1891

Table 1: Showing the previous exploration licenses that overlap the Yamba Project Tenement (EL 28175)

## EL 7570

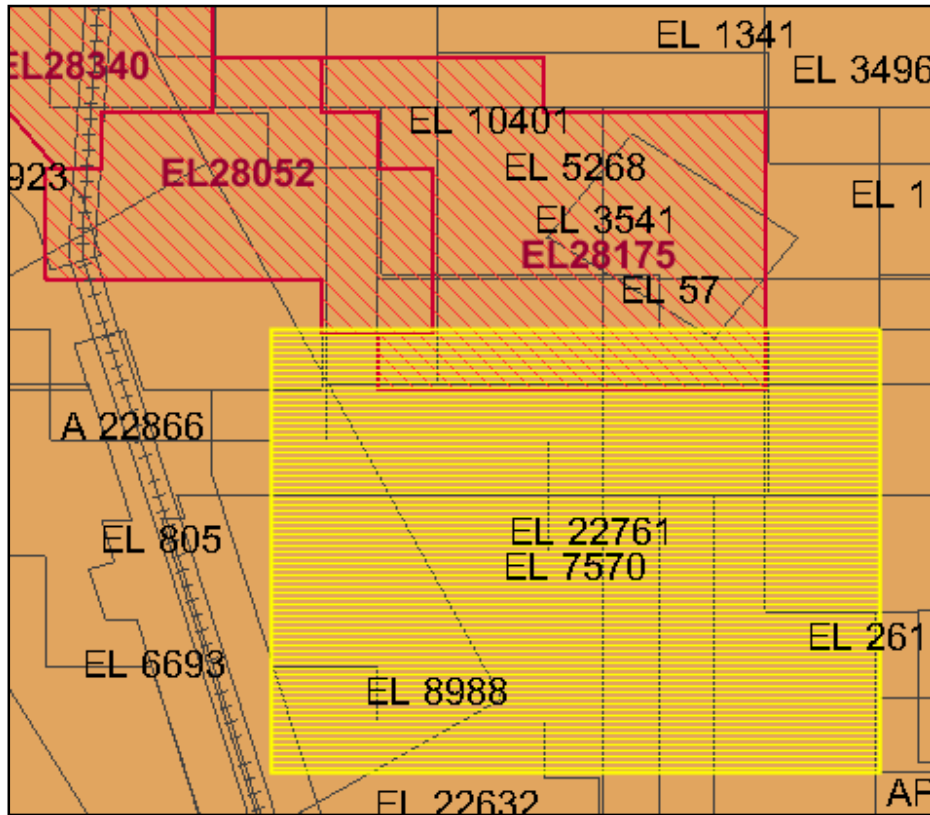

**Title:**

Annual and final report EL 7570 Alice Springs project 12 November 1991 to 11 November 1992

**Report No:**

CR1993-0086

**Author:**

Whalan, GA / Stockdale Prospecting

**Tenure:**

**EL 7570**

**Province:**

Arunta Province

**Stratigraphy:**

Sliding Rock Metamorphics / Oolbra Orthogneiss / Narbib Granulite / Enbra Granulite

**Thesaurus:**

Gold exploration Gold

**Map Sheet:**

Alice Springs SF5314 / Burt 5651

**Abstract:**

Anomalous gold concentrations appear to be associated with sporadic mineralisation in the Oolbra Orthogneiss.

## EL 22761

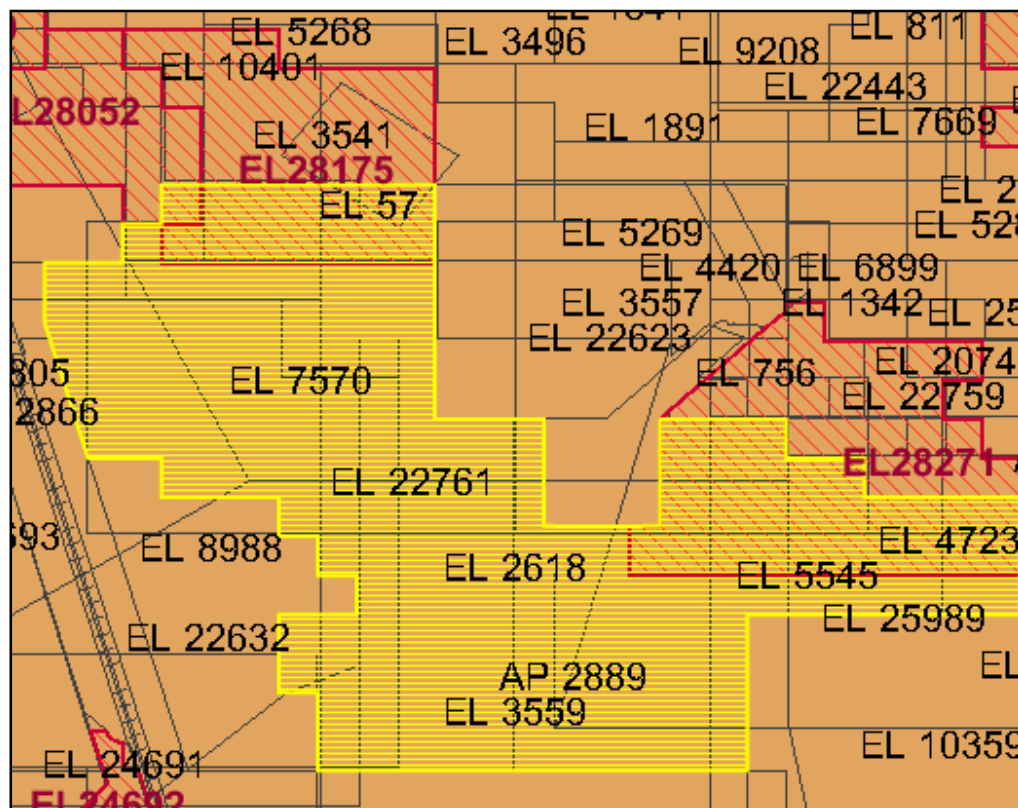

**Title:**

Final Report, EL 22761 "Harry Creek", from 2 April 2002 to 10 March 2005

**Report No:**

CR2005-0148

**Author:**

Rohde, C / Tanami Exploration

**Tenure:**

EL 22761

**Province:**

Arunta Region

**Stratigraphy:**

Strangways Metamorphic Complex

**Thesaurus:**

Gold exploration Ground magnetic surveys Rock chip sampling Soil sampling Assaying Base metal exploration Broken Hill type deposits

**Map Sheet:**

Alice Springs SF5314 / Laughlen 5751 / Burt 5651

**Abstract:**

EL 22761 'Harry Creek' is situated in Central Australia about 40 kilometres north of Alice Springs. The tenement was granted in April 2002 to Teck Cominco Australia Pty Ltd (Teck) and transferred to Tanami Exploration NL (TENL) in March 2003. TENL is a wholly owned subsidiary of Tanami Gold NL (TGNL), a publicly listed company. EL 22761 was surrendered on March 10, 2005. This report covers the exploration conducted by Teck and TENL over nearly

three years of tenure. Teck targeted Broken Hill-type (BHT) mineralisation hosted by sillimanite and garnet-bearing metasediments within the Wigley package. The target zones are rock packages associated with magnetic linears and more discrete magnetic anomalies which may represent alteration products. Within the surrendered area reconnaissance geochemical sampling and ground magnetics were carried out by the GeoDiscovery Group (consultants) for Teck. Teck considered the results for EL 22761 inconclusive due to extensive alluvial cover and lack of outcrop. No significant base metal anomalism was located. Within the reconnaissance sampling Teck also completed limited drainage sampling for heavy minerals, which were followed up by drainage sampling (3) and rock chip sampling (1) by Flinders Diamonds Limited (Flinders). TENL reviewed the work by Teck and carried out rock chip sampling to test narrow northeast trending retrograde schist zones for gold mineralization. Based on lithology, Teck's inconclusive results and TENL's disappointing rock chip results the tenement was recommended for relinquishment.

---

[Record No: 2 of 3](#)

**Title:**

First annual report for EL 22759 and EL 22761, for the year ending 1st April 2003

**Report No:**

CR2003-0163

**Author:**

McLean, N / Walters, S / Smith, T / Tanami Exploration

**Tenure:**

EL 22759 / **EL 22761**

**Province:**

Arunta Province

**Stratigraphy:**

Strangways Metamorphic Complex / Heavitree Quartzite

**Prospect/Deposit:**

Gecko Prospect

**Thesaurus:**

Ground magnetic surveys Rock chip sampling Soil sampling Assaying Base metal exploration

**Geochem:**

83 rock chip samples 150 soil samples 5 large drainage samples

**Map Sheet:**

Alice Springs SF5314 / Laughlen 5751 / Burt 5651

**Abstract:**

Work included geochemical sampling and ground magnetic surveys completed on EL 22759 area and the potential for a small to medium sized resource of Zn-Cu mineralisation at depth. along the Gecko trend. No further sampling is warranted as the surface extent of the prospective unit is well defined. A program of fixed loop EM surveying is therefore proposed to test for the potential of sulphide mineralisation at depth with the prospective horizon. Field inspection on the EL 22761 confirmed the poor outcrop but did succeed in explaining the source of the magnetic trends in the central part of the tenement as magnetite-bearing amphibolite and unrelated to alteration. The rock chip and soil sampling failed to provide any anomalous results. Although no significant results are evident from the work done the effectiveness of the program has been hindered by the poor outcrop and transported cover sediments.

---

[Record No: 3 of 3](#)

**Title:**

Partial Relinquishment Report EL 22761 'Harry Creek' Winnecke Project from 2 April 2002 to 1 April 2004

**Report No:**

CR2004-0317

**Author:**

Rohde, C / Tanami Exploration

**Tenure:**

**EL 22761**

**Province:**

Arunta Province

**Stratigraphy:**

Strangways Metamorphic Complex

**Thesaurus:**

Gold exploration Ground magnetic surveys Rock chip sampling Soil sampling Assaying Base metal exploration Broken Hill type deposits

**Geochem:**

9 rock chips, 29 soil samples

**Map Sheet:**

Alice Springs SF5314 / Laughlen 5751 / Burt 5651

**Abstract:**

EL 22761 'Harry Creek' is situated in the Arunta Province of Central Australia about 40 kilometres north of Alice Springs. The tenement was granted in April 2002 to Teck Cominco Australia Pty Ltd (Teck) and in March 2003 transferred to Tanami Exploration NL (TENL). TENL is a wholly owned subsidiary of Tanami Gold NL (TGNL), a publicly listed company. At the end of the second year of term the western section of EL 22761 was relinquished. This report covers exploration conducted within the relinquished section of the tenement by Teck and TENL. Teck targeted Broken Hill Type (BHT) mineralisation hosted by sillimanite and garnet-bearing metasediments within the Wigley package. The target zones are rock packages associated with magnetic linears and more discrete magnetic anomalies that may represent alteration products. Within the relinquished area reconnaissance geochemical sampling and ground magnetics were carried out by the GeoDiscovery Group (consultants) for Teck. Teck considered the results for EL 22761 inconclusive due to extensive alluvial cover and lack of outcrop. No significant base metal anomalism was located. TENL reviewed the work by Teck, but completed no field exploration.

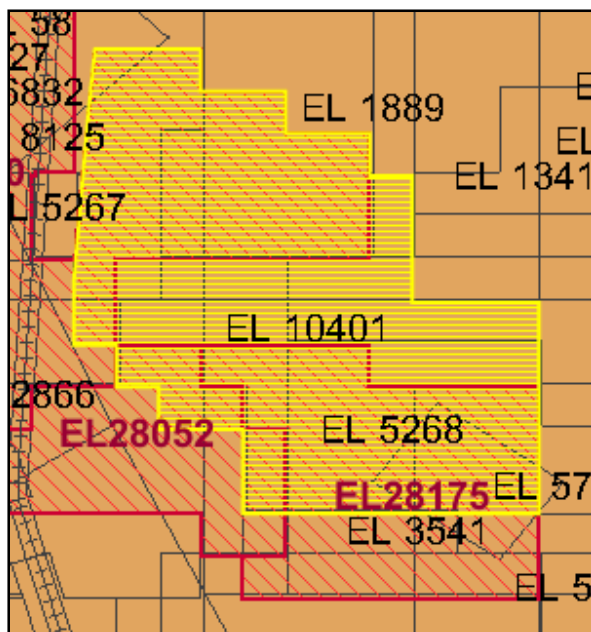
**EL 10401**

**Title:**

First annual report for EL 10359, EL 10360, EL 10401 and EL 22625, for the year ending 5th December 2002

**Report No:**

CR2002-0348

**Author:**

Kavanagh, ME / Tanami Exploration

**Tenure:**

EL 10359 / EL 10360 / **EL 10401** / EL 22625

**Province:**

Arunta Province

**Stratigraphy:**

Strangways Metamorphic Complex

**Prospect/Deposit:**

Hale River

**Thesaurus:**

Rock chip sampling Soil sampling Gold exploration

**Geochem:**

9 soil samples 6 rock chip samples

**Map Sheet:**

Alice Springs SF5314 / Laughlen 5751 / Riddoch 5851 / Burt 5651

**Abstract:**

A limited rockchip and soil sampling program was carried out along the access track into EL10404. There were no significant gold assays returned from the sampling. The company has not received a technical report from BHP Billiton/Teck Cominco from the exploration within the EL 10401. There were no other field activities in the project area.

---

[Record No: 2 of 8](#)

**Title:**

Second annual report for EL 10401 "Yambah", for year ending 5th December 2003

**Report No:**

CR2004-0053

**Author:**

Rohde, C / Tanami Exploration

**Tenure:**

**EL 10401**

**Province:**

Arunta Province

**Stratigraphy:**

Strangways Metamorphic Complex / Narwietooma Metamorphic Complex

**Prospect/Deposit:**

Tom Brauns I / Tom Brauns II / Tom Brauns III / Red Rock

**Thesaurus:**

Gold exploration Rock chip sampling Malachite

**Geochem:**

7 rock chip samples

**Map Sheet:**

Alice Springs SF5314 / Burt 5651

**Abstract:**

Second year exploration comprised a regional review, including a geophysical assessment, and a ground reconnaissance program. Two MODAT occurrences, were visited and seven rock chip samples taken. At the Tom Brauns I – III Cu occurrence a best assay result of

16% Cu, 973ppm Zn, 0.9ppm Ag and 4ppb Au was returned from a malachite and azurite stained coarse-grained pyroxenite/amphibolite (BPK002). At the Red Rock Cu-Pb-Zn Prospect a best result of 12.8% Zn was returned, together with 630ppm Pb from a coarse grained anthophyllite.

Further exploration is planned.

---

---

[Record No: 3 of 8](#)

**Title:**

Combined Annual report, Burt Plain Project, EL 10401-Yambah, From 6 December 2003 to 5 December 2004 & EL 22923-Strangways, from 28 August 2003 to 5 December 2004

**Report No:**

CR2004-0665

**Author:**

Rohde, C / Tanami Exploration

**Tenure:**

**EL 10401** / EL 22923

**Province:**

Arunta Region

**Prospect/Deposit:**

Harry Creek / Tom Brauns II

**Thesaurus:**

Gold exploration Rock chip sampling Massive sulphide deposits

**Geochem:**

15 rock chips in EL 10401, 4 rock chips in EL 22923

**Map Sheet:**

Hermannsburg SF5313 / Alice Springs SF5314 / Alcoota SF5310 / Bushy Park 5652 / Anburla 5551 / Burt 5651

**Abstract:**

Exploration Licences 10401 'Yambah' and 22923 'Strangways' form the Burt Plain Project, and are

situated within the Arunta Region of the North Australian Craton approximately 60 kilometres north of

Alice Springs. Both tenements are registered to Tanami Exploration NL (TENL), a wholly owned subsidiary of Tanami Gold NL (TGNL), a publicly listed company. This is the first combined

report for the Burt Plain project, and describes exploration by TENL in the 2003-04 period.

Targets for exploration are Gecko-Rankins-style polymetallic, metamorphosed massive sulphide

deposits as recognised at the Red Rock Prospect, and epigenetic copper-gold mineralisation within

greenschist- facies retrograde shear zones.

Exploration during the reporting period comprised two ground reconnaissance trips to locate and sample

known mineral occurrences as shown in MODAT. 15 rock chips were collected in EL 10401 and 4 in EL 22923. At Tom Brauns II Cu occurrence, a best result of 16 % Cu, 973 ppm Zn, 0.9 ppm Ag and 4 ppb Au was returned from a malachite- and azurite-stained coarse-grained pyroxenite/amphibolite (BPK002). At the Harry Creek Cu-Pb-Zn prospect, a best result of 12.8 % Zn and 630 ppm Pb was returned from a coarse-grained anthophyllite-rich rock.

---

---

[Record No: 4 of 8](#)

**Title:**

Combined annual report for EL 10401 and EL 22923

**Report No:**

CR2005-0559

**Author:**

Graham, A / Tanami Gold

**Tenure:**

**EL 10401** / EL 22923

**Province:**

Arunta Region

**Thesaurus:**

Gold exploration Base metal exploration

**Map Sheet:**

Hermannsburg SF5313 / Alice Springs SF5314 / Alcoota SF5310 / Bushy Park 5652 / Anburla 5551 / Burt 5651

**Abstract:**

These ELs were included in a review of the base metal prospects in the Arunta region. A brief field visit was undertaken to familiarize new staff with the region. All other work was office-based.

---

[Record No: 5 of 8](#)

**Title:**

Relinquishment report for EL 10401 "Yambah", from 6 December 2001 to 5 December 2005

**Report No:**

CR2005-0632

**Author:**

Rohde, C / Tanami Exploration

**Tenure:**

**EL 10401**

**Province:**

Arunta Region

**Stratigraphy:**

Strangways Metamorphic Complex / Wuluma Granite

**Thesaurus:**

Gold exploration Geochemical sampling Rock chip sampling

**Geochem:**

2 rock chip samples

**Map Sheet:**

Alice Springs SF5314 / Burt 5651

**Abstract:**

Exploration Licence 10401 'Yambah' forms part of the Burt Plain Project, which is situated approximately 60 km north of Alice Springs within the Arunta region of the North Australian Craton. EL 10401 was granted on 6 December 2001 and at the end of the fourth year of term the central portion of EL 10401 was relinquished. This report outlines the work undertaken on the relinquished portion. The registered holder of EL 10401 is Tanami Exploration NL (TENL), a wholly owned subsidiary of Tanami Gold NL (TGNL), a publicly listed company. Exploration on the relinquished tenement area comprised a regional geological interpretation and ground reconnaissance sampling including rockchips from a retrograde shear zone. No encouraging results were returned.

---

[Record No: 6 of 8](#)



**Title:**

Annual report for EL 10360 and EL 10401

**Report No:**

CR2006-0539

**Author:**

McBain, G / Deep Yellow

**Tenure:**

EL 10360 / **EL 10401**

**Province:**

Arunta Region

**Thesaurus:**

Uranium exploration Land access

**Map Sheet:**

Hermannsburg SF5313 / Alice Springs SF5314 / Alcoota SF5310 / Bushy Park 5652 / Anburla 5551 / Burt 5651

**Abstract:**

The Annual Reports in respect of the above licences for the year ending 5 December 2006 are due to be lodged by 5 January 2007. We ask that this letter be accepted as a nil report in respect of these tenements. No field work was conducted during the reporting period by the previous holder, Tanami Exploration NL (TENL), or by Deep Yellow Ltd (DYL). Exploration Licences 10360 and 10401 are included in a number of Exploration Licences acquired by DYL from TENL with the transfer being registered on 5 December 2006. Both tenements are the subject of a Deed of Covenant dated 20 May 2003 incorporating them into the Harts Range ILUA between TENL and the Central Land Council (CLC). The ILUA was registered by the National Native Title Tribunal on 5 September 2002. However, the ILUA only relates to exploration for gold and therefore required Tanami or its assignee, DYL, to present a new exploration proposal to cover uranium exploration prior to conducting any programmes. A proposal for uranium exploration was forwarded to the CLC on 30 October 2006. Approval has not yet been received. Whilst DYL is keen to conduct its exploration programme, given the timing it was impossible to conduct an exploration programme prior to the end of the anniversary year.

---

[Record No: 7 of 8](#)

**Title:**

Annual report on EL 10401

**Report No:**

CR2007-0708

**Author:**

McBain, G / Deep Yellow

**Tenure:**

**EL 10401**

**Province:**

Arunta Region

**Thesaurus:**

Uranium exploration Land access

**Map Sheet:**

Alice Springs SF5314 / Burt 5651

**Abstract:**

A transfer in respect of a 50% interest in the tenement was lodged by McColl Exploration & Mining Title Services Pty Ltd (McColl) on 20 December 2007 on behalf of the incoming party, Rum Jungle Uranium Ltd (RJU). In addition to acquiring a 50% interest, RJU are now

managers of the tenement pursuant to the terms of a Joint Venture Agreement dated 28 November 2007 between RJU and Deep Yellow Ltd (DYL). Expenditure during the year ended 5 December 2007 was limited to planning a drill program, discussions with the Central Land Council (CLC) and lodgement of an application for an Authorisation under the Mining Management Act. The tenement is subject to an ILUA between the CLC and the previous registered holder, Tanami Exploration NL. Deep Yellow Ltd (DYL) lodged a proposal to conduct a drilling program with the CLC. DYL requested a site clearance subject to the ILUA, however approval to drill was not given prior to the end of the tenement year.

---

[Record No: 8 of 8](#)

**Title:**

Final report on EL 10401 "Yambah" 6 December 2001 to 13 May 2008 and EL 22923 "Strangways" 28 August 2002 to 13 May 2008, Burt Plain Project

**Report No:**

CR2008-0321

**Author:**

Rohde, J / Deep Yellow

**Tenure:**

**EL 10401** / EL 22923

**Province:**

Arunta Region

**Thesaurus:**

Uranium exploration Gold exploration Base metal exploration

**Geochem:**

12 rock chip samples

**Map Sheet:**

Alice Springs SF5314 / Burt 5651

**Abstract:**

Exploration Licences 10401 Yambah and 22923 Srangways formed part of Tanami Gold NL's (TGNL) Burt Plain Project, and are situated within the Arunta Region of the North Australian Craton approximately 60 kilometres north of Alice Springs. Targets for exploration were Gecko-Rankins-style polymetallic, metamorphosed massive sulphide deposits as recognised at the Red Rock Prospect, and epigenetic copper-gold mineralisation within greenschist- facies retrograde shear zones. Both tenements were acquired by Deep Yellow Ltd (DYL) under the terms of an Agreement dated 28 June 2005 between DYL, Tanami Exploration NL (TENL) and TGNL. This report outlines the work undertaken prior to the final surrender of EL 10401 and EL 22923. Exploration on the surrendered tenement areas comprised regional geological interpretation and ground reconnaissance by TENL including twelve rockchip samples. No encouraging results were returned.

## EL 5268

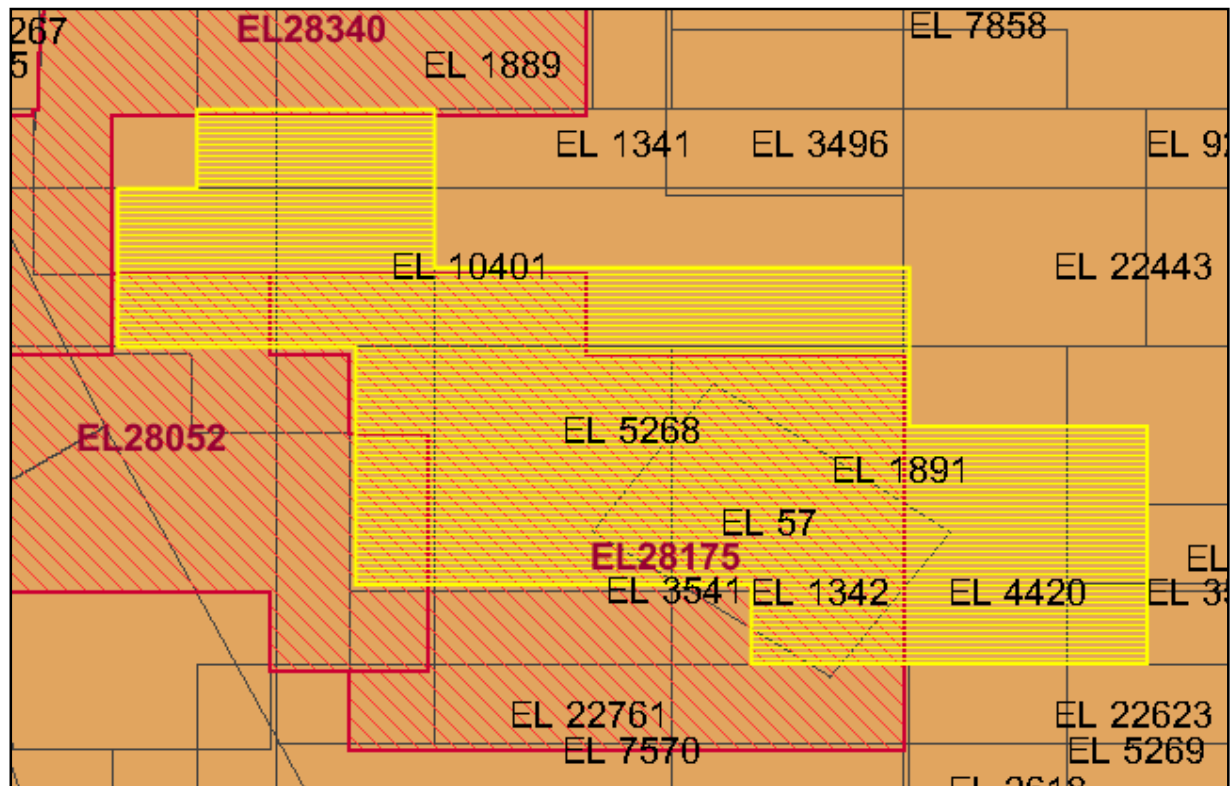

**Title:**

First and final report EL 5268 (Harrys Creek) year ending 10-12-1988

**Report No:**

CR1989-0058

**Author:**

Macmahon Construction

**Tenure:**

EL 5268

**Province:**

Arunta Province

**Prospect/Deposit:**

Harry Creek

**Map Sheet:**

Alice Springs SF5314 / Burt 5651 / Laughlen 5751

**Abstract:**

EM37 on EL5268 disproved the presence of a conductive sulphide body except possibly at great depth. Results are disappointing and it was decided to relinquish EL5268 Includes interpretation report for a transient electromagnetic survey on EL5267.

## **EL 3557**

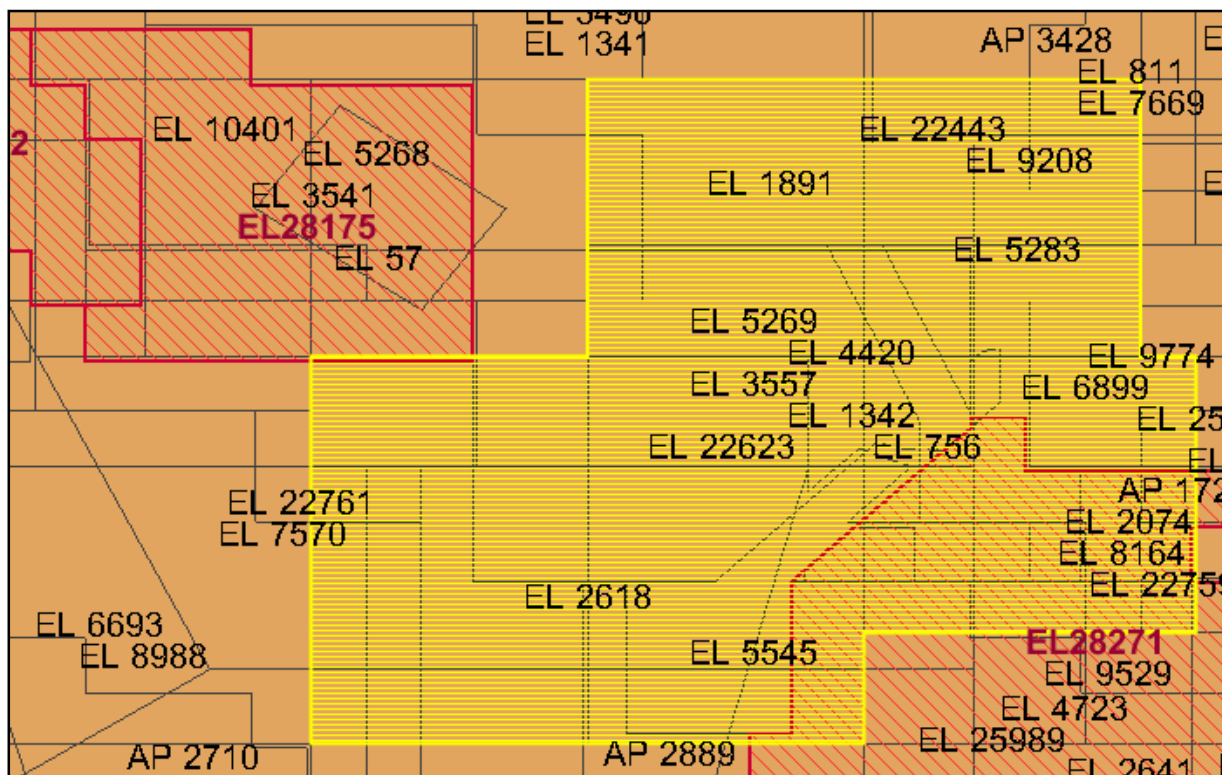

**Title:**

First and final report on Alice Springs NT 11 May 1982 to 10 May 1983.

**Report No:**

CR1983-0190

**Author:**

Booth, L / Taylor, KS / x

**Tenure:**

**EL 3557**

**Province:**

Arunta Province

**Thesaurus:**

Geophysics Radioactivity surveys Radiometric anomalies Geological surveys Uranium Base metals Allanite

**Map Sheet:**

Alice Springs SF5314 / Riddoch 5851

**Abstract:**

Radiometric anomaly has a thorium bias.

## **EL 3541**

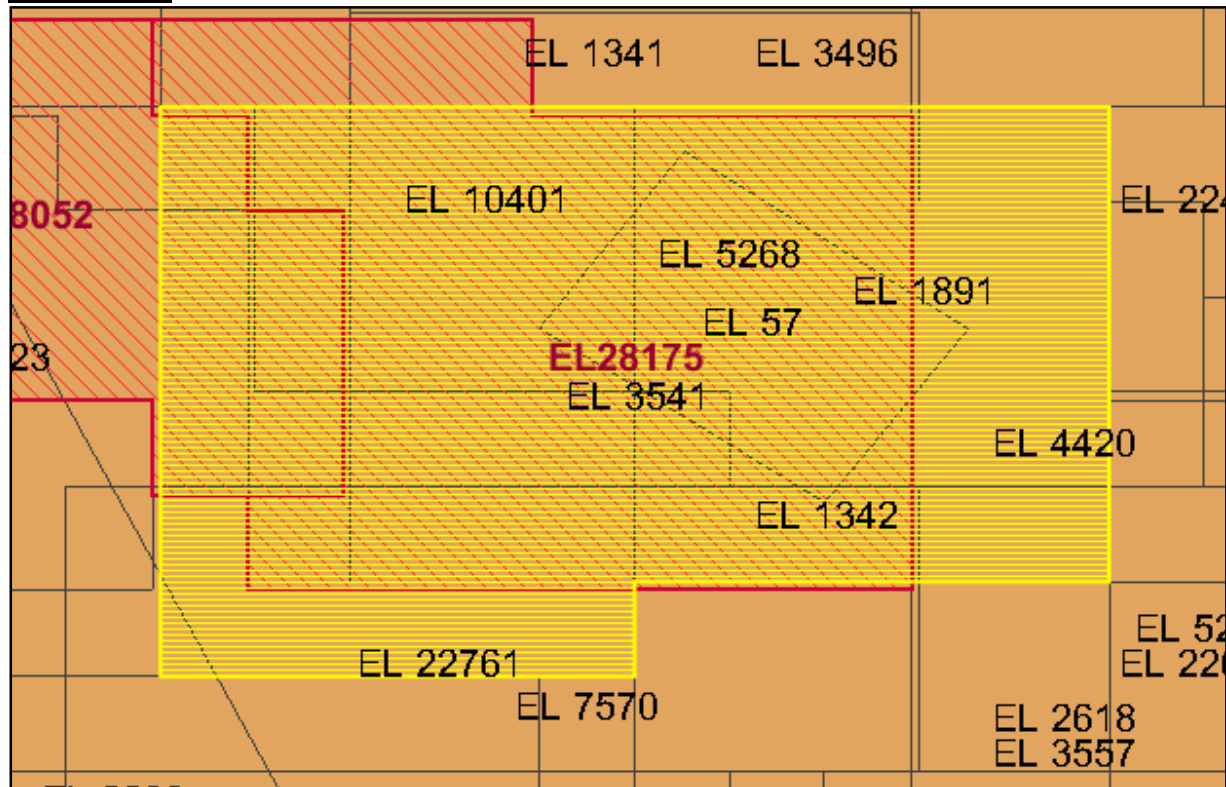

**Title:**

Annual report for period ending 19 April 1983, Harry Creek

**Report No:**

CR1983-0153

**Author:**

Harvey, BE / Jenke, GP / x

**Tenure:**

**EL 3541**

**Province:**

Arunta Province

**Map Sheet:**

Alice Springs SF5314 / Burt 5651

**Abstract:**

Negative results for both base metals and diamonds so far.

---

[Record No: 2 of 2](#)

**Title:**

Final report, Harry Creek, Arunta Block

**Report No:**

CR1983-0229

**Author:**

Harvey, BE / CRA Exploration

**Tenure:**

**EL 3541**

**Province:**

Arunta Province

**Thesaurus:**

Diamonds Base metals Heavy media separation

**Map Sheet:**

Alice Springs SF5314 / Burt 5651

**Abstract:**

Negative results for diamonds and base metals.

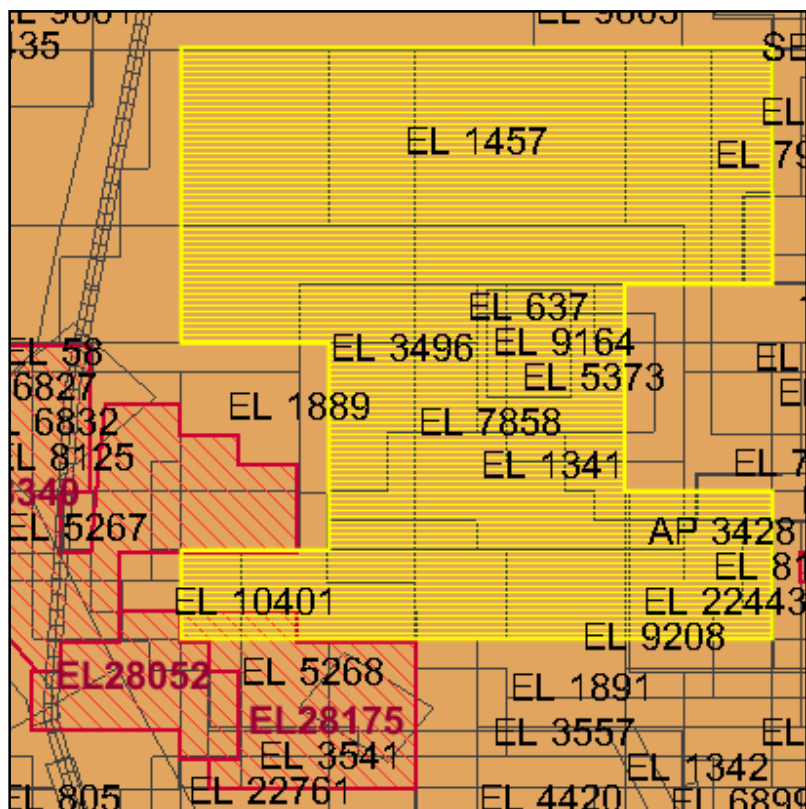
**EL 3496****Title:**

Interim Report on 1983 Investigation near Alice Springs, NT

**Report No:**

CR1983-0197

**Author:**

Negri River Corporation

**Tenure:**

EL 3496 / EL 3498

**Province:**

Arunta Province

**Thesaurus:**

Geochemistry Fluvial sediments Geochemical anomalies Photogeology Diamonds Literature reviews Landsat Proterozoic

**Map Sheet:**

Alcoota SF5310 / Alice Springs SF5314 / Bushy Park 5652 / Alcoota 5752 / Delny 5852 / Burt 5651 / Laughlen 5751 / Riddoch 5851

**Abstract:**

Weak anomalous metal values reported from five sites. Heavy mineral results not available at time of writing

---

---

[Record No: 2 of 3](#)

**Title:**

Exploration Report on Reduction of EL 3496 and EL 3498 NT

**Report No:**

CR1984-0169

**Author:**

Lohan, AJ / Negri River Corporation

**Tenure:**

**EL 3496** / EL 3498

**Province:**

Arunta Province

**Thesaurus:**

Geochemistry Fluvial sediments Heavy minerals Kimberlite Garnet Ilmenite Spinel Chrome diopside

**Map Sheet:**

Alcoota SF5310 / Alice Springs SF5314 / Bushy Park 5652 / Alcoota 5752 / Burt 5651 / Laughlen 5751

**Abstract:**

None of the heavy mineral samples examined contained grains whose morphologic characteristics suggested a possible kimberlitic origin.

---

---

[Record No: 3 of 3](#)

**Title:**

Final report on exploration activities for Bushy Park, Central Australia

**Report No:**

CR1985-0259

**Author:**

Marshall, B / Negri River Corporation

**Tenure:**

**EL 3496** / EL 3498

**Province:**

Arunta Province

**Prospect/Deposit:**

Mud Tank

**Map Sheet:**

Alcoota SF5310 / Alice Springs SF5314 / Bushy Park 5652 / Alcoota 5752 / Burt 5651 / Laughlen 5751

**Abstract:**

The results from the 1983-84 program failed to substantiate the results from the previous year. No kimberlitic indicators were found. The area was relinquished.

## EL 4420

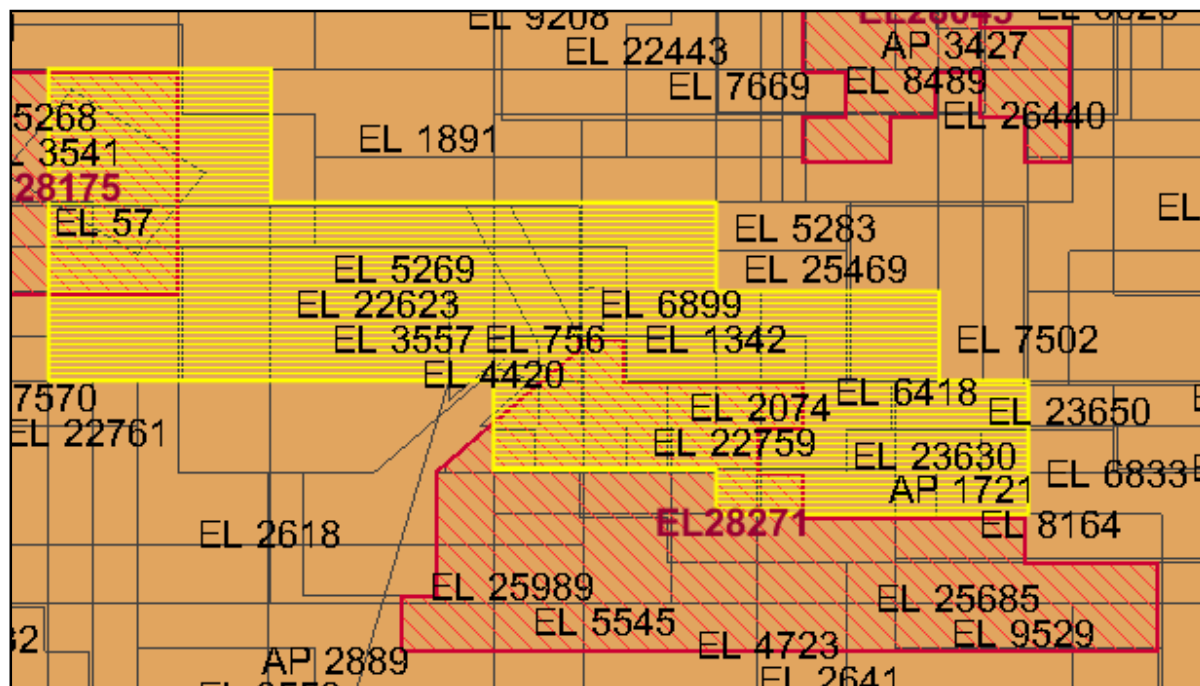

**Title:**

Annual Report on Sliding Rock Well period ending 18-10-1987.

**Report No:**

CR1987-0230

**Author:**

Bubner, GJ / Colliver, IC / CRA Exploration

**Tenure:**

**EL 4420**

**Province:**

Amadeus Basin

**Prospect/Deposit:**

Sloans Gully / Sliding Rock

**Thesaurus:**

Gold exploration Diamonds Aerial magnetic surveys Aerial radioactivity surveys Soil sampling Rock chip sampling Assaying Stratigraphy Reconnaissance Logging Gold Mineralization Trenching Radioactivity surveys

**Map Sheet:**

Alice Springs SF5314 / Laughlen 5751

**Abstract:**

Old gold working in the Sliding Rock Well are were examined and sampled. Encouraging gold mineralisation was observed at the Sloan's Gully Prospect.

---

[Record No: 2 of 5](#)

**Title:**

Annual report on Sliding Rock Well, NT period ending 19-10-1985 to 18-10-1986

**Report No:**

CR1986-0311



**Author:**

Aurotech

**Tenure:**

**EL 4420**

**Province:**

Arunta Province

**Prospect/Deposit:**

Old Times Prospect / Sloans Gully

**Thesaurus:**

Gold exploration

**Map Sheet:**

Alice Springs SF5314 / Laughlen 5751

**Abstract:**

Samples was collected from a sericite altered shear zone in Heavitree Quartzite. Detectable gold geochemical values were reported in five samples. The best value reported was 1g-t gold.

---

[Record No: 3 of 5](#)

**Title:**

Final report Sliding Rock Well period to 18 October 1988

**Report No:**

CR1989-0089

**Author:**

Graham, BJ / CRA Exploration

**Tenure:**

**EL 4420**

**Province:**

Arunta Province

**Prospect/Deposit:**

Sloans Gully / Sliding Rock

**Thesaurus:**

Gold exploration Diamond drilling

**Drilling:**

yes Diamond drill holes DD87 sg 1-4

**Map Sheet:**

Alice Springs SF5314 / Laughlen 5751

**Abstract:**

Report contains a summary of exploration over the 5 tenure years. The results of drilling were generally poor across the EL. In Sloans Gully only narrow zones of gold mineralisation were intersected. Therefore EL4420 has been downgraded as an area of potential significant gold mineralisation.

---

[Record No: 4 of 5](#)

**Title:**

Exploration licence 4420 Sliding Rock Well annual report to the Northern Territory Department of Mines and Energy for the period ending 18th October 1984

**Report No:**

CR1985-0007

**Author:**

Pigott, GF / McLennan, RM / Australian Anglo American

**Tenure:**

**EL 4420****Province:**

Arunta Province

**Stratigraphy:**

Sliding Rock Metamorphics / Heavitree Quartzite / Bitter Springs Formation

**Prospect/Deposit:**

Old Times Prospect / Sliding Rock / Sloans Gully / Harry Creek / Rankins

**Thesaurus:**

Gold exploration Sampling Stream sediment sampling Rock chip sampling

**Geochem:**

173 Stream sediment samples 16 Rock samples

**Map Sheet:**

Alice Springs SF5314 / Burt 5651 / Laughlen 5751

**Abstract:**

173 Stream sediment samples were collected, however only four samples were obtained above the detection limit of 0.01ppm Au, the highest being 1.6 g/t Au. and indicated previously located mineralisation . Three costeans were sampled with the better result obtained at the Old Times Prospect ie 16m @ 1.5 g/t Au. The report contains detailed account of previous work completed in the area.

Stratigraphic unit explored includes the Ankala Gneiss

---

[Record No: 5 of 5](#)

**Title:**

Annual report on Sliding Rock Well for the period ending 18-10-1985

**Report No:**

CR1985-0290

**Author:**

Piggot, K / Metwell

**Tenure:**

**EL 4420**

**Province:**

Arunta Province

**Prospect/Deposit:**

Harry Creek / Rankins / Gecko / Johannsens Phlogopite Mine / Gumtree

**Map Sheet:**

Alice Springs SF5314 / Burt 5651 / Laughlen 5751

**Abstract:**

The potential for precious metal mineralisation associated with the stratabound base metal occurrences in the area has been downgraded by this work. Further investigation is required in some areas.

## EL 57

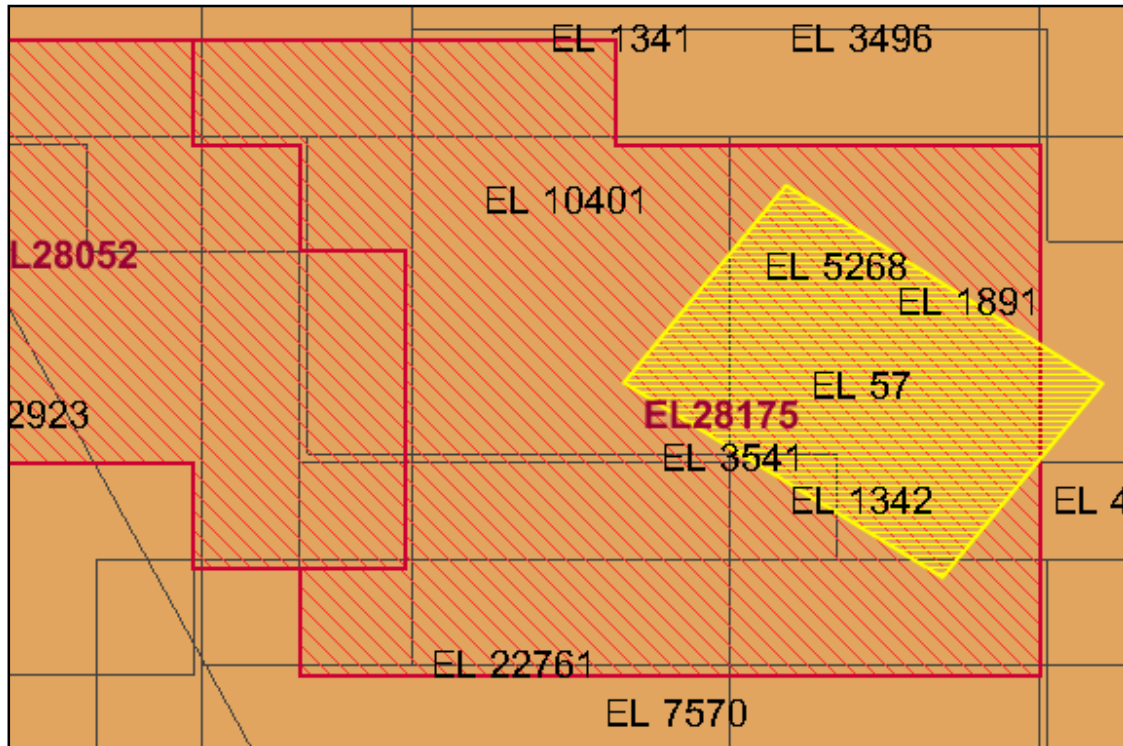

**Title:**

Final report, Victoria River Downs, NT

**Report No:**

CR1973-0099

**Author:**

Hooker Mining / Australasian Minerals

**Tenure:**

EL 73 / **EL 75** / EL 76 / EL 77 / EL 78 / EL 79 / EL 80 / EL 342 / EL 451

**Province:**

Victoria-Birrindudu Basin

**Stratigraphy:**

Skull Creek Formation / Bullita Group

**Prospect/Deposit:**

Charles

**Thesaurus:**

Base metals

**Map Sheet:**

Victoria River Downs SE5204 / Delamere SD5216 / Waterloo SE5203 / Auvergne SD5215 / Humbert 5065 / Victoria River Downs 5165 / Mount Sanford 5064 / Auvergne 4966 / Stokes 5066 / Baines 4965 / Wickham River 4964

**Abstract:**

From this field work, eighteen localities were selected for detailed mapping and sampling. Although IP and percussion drilling were carried out at 4 localities no significant base metal deposits were found. Report provides a detailed rundown of the geology and stratigraphy of the area under licence.

---

Record No: 2 of 2

**Title:**

Induced polarization survey and resistivity survey, Victoria River Downs.

**Report No:**

CR1972-0076

**Author:**

Starkey, LJ / Hooker Mining / Australasian Minerals

**Tenure:**

EL 73 / **EL 75** / EL 76 / EL 77 / EL 78 / EL 79 / EL 80 / EL 341 / EL 342 / EL 451

**Province:**

Victoria-Birrindudu Basin

**Stratigraphy:**

Skull Creek Formation / Bullita Group

**Prospect/Deposit:**

colt

**Thesaurus:**

Geophysics IP surveys Resistivity surveys Base metals

**Map Sheet:**

Victoria River Downs SE5204 / Auvergne SD5215 / Waterloo SE5203 / Humbert 5065 / Victoria River Downs 5165 / Mount Sanford 5064 / Auvergne 4966 / Stokes 5066 / Baines 4965 / Wickham River 4964

**Abstract:**

A Combined Induced Polarization and Resistivity Survey was conducted over three areas within the authority to prospect at Victoria River Downs. The area is under a joint venture agreement by LJ Hooker and Australasian Minerals Incorporated, a subsidiary of Alcoa of America. The present survey was conducted over two areas outlined by an airborne electro magnetic survey carried out during the winter of 1971. The remaining area of the Colt prospect was outlined by Geological Mapping. Recommended drilling over 3 anomalous zones.

## **EL 1342**

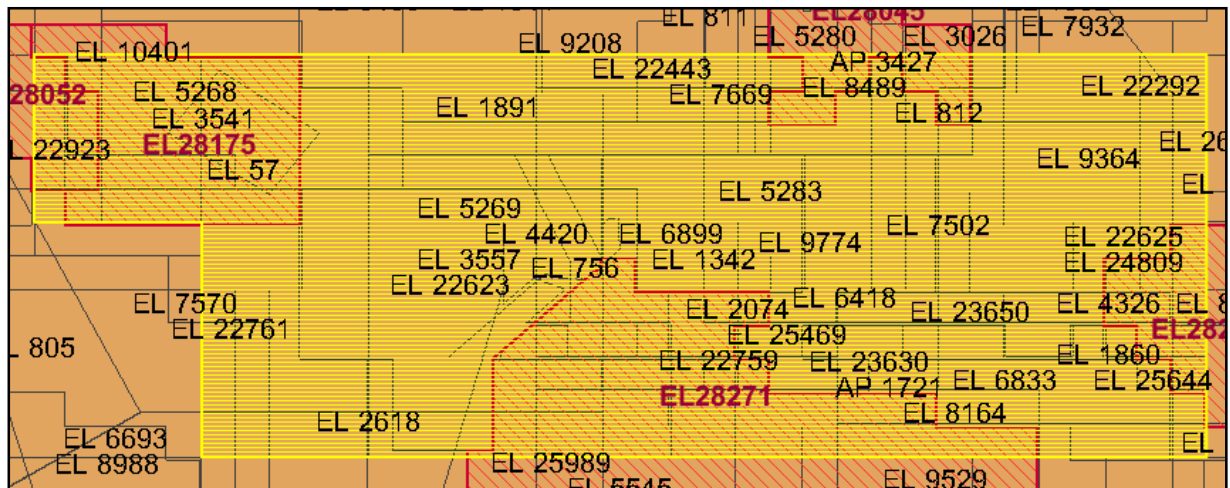

**Title:**

Strangways Range and Hale River, Arunta Complex, NT final report

**Report No:**

CR1977-0139

**Author:**

Dampier Mining

**Tenure:**

EL 1341 / EL 1342

**Province:**

Arunta Province

**Prospect/Deposit:**

Harry Creek / Rankins / Gheko Prospect / Johannsens Phlogopite Mine / Marlgara Range

**Map Sheet:**

Alice Springs SF5314 / Burt 5651 / Laughlen 5751

**Abstract:**

In all cases mineralisation investigated is low grade and appears very small in size.

**EL 1341**

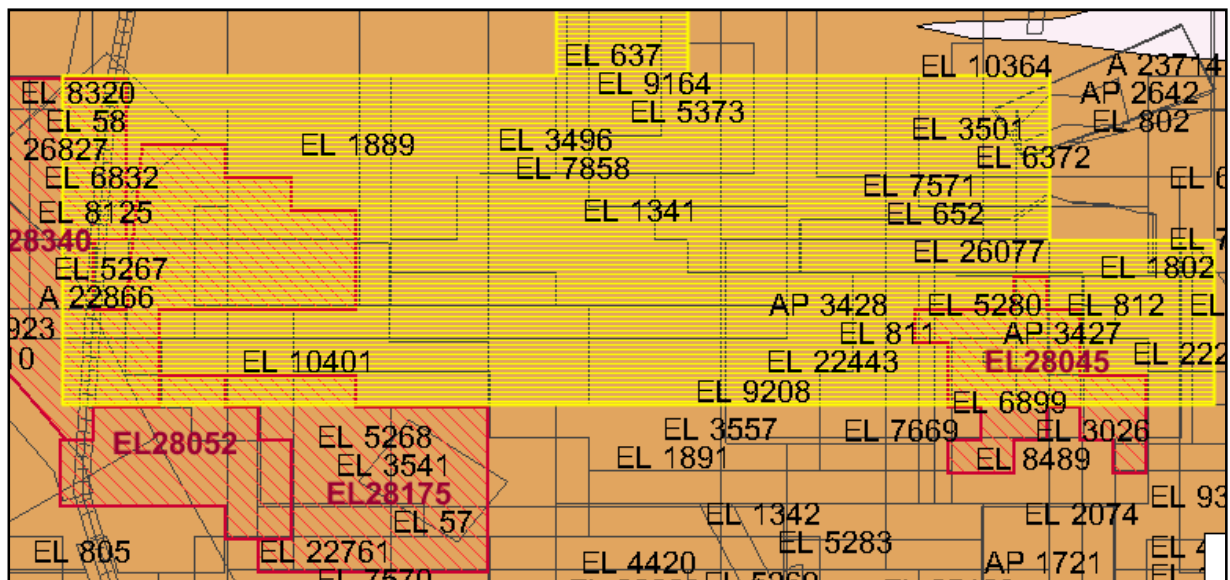

**Title:**

Strangways Range and Hale River, Arunta Complex, NT final report

**Report No:**

CR1977-0139

**Author:**

Dampier Mining

**Tenure:**

EL 1341 / EL 1342

**Province:**

Arunta Province

**Prospect/Deposit:**

Harry Creek / Rankins / Gheko Prospect / Johannsens Phlogopite Mine / Marlgara Range

**Map Sheet:**

Alice Springs SF5314 / Burt 5651 / Laughlen 5751

**Abstract:**

In all cases mineralisation investigated is low grade and appears very small in size.

**EL 2618**

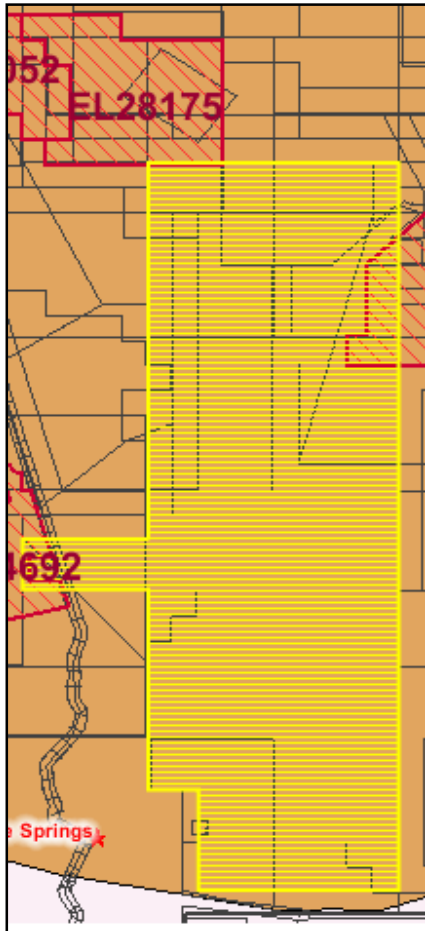

**Title:**

Annual report Bond Springs, Brumby Bore, Whistle Duck

**Report No:**

CR1982-0175

**Author:**

White Industries

**Tenure:**

EL 2618 / EL 2648 / EL 2641

**Province:**

Arunta Province

**Prospect/Deposit:**

Brumby Bore / Bond Springs / Whistle Duck

**Thesaurus:**

Photogeology Diamonds Kimberlite Carbonatite Geological structures Anomalies

**Map Sheet:**

Alice Springs SF5314 / Burt 5651 / Laughlen 5751 / Riddoch 5851 / Alice Springs 5650 /  
Undoolya 5750

**Abstract:**

Photogeological study identified 29 anomalous structures, 6 of which were considered to be of kimberlitic origin. Only 19 were in the licence area.

**EL 1891**

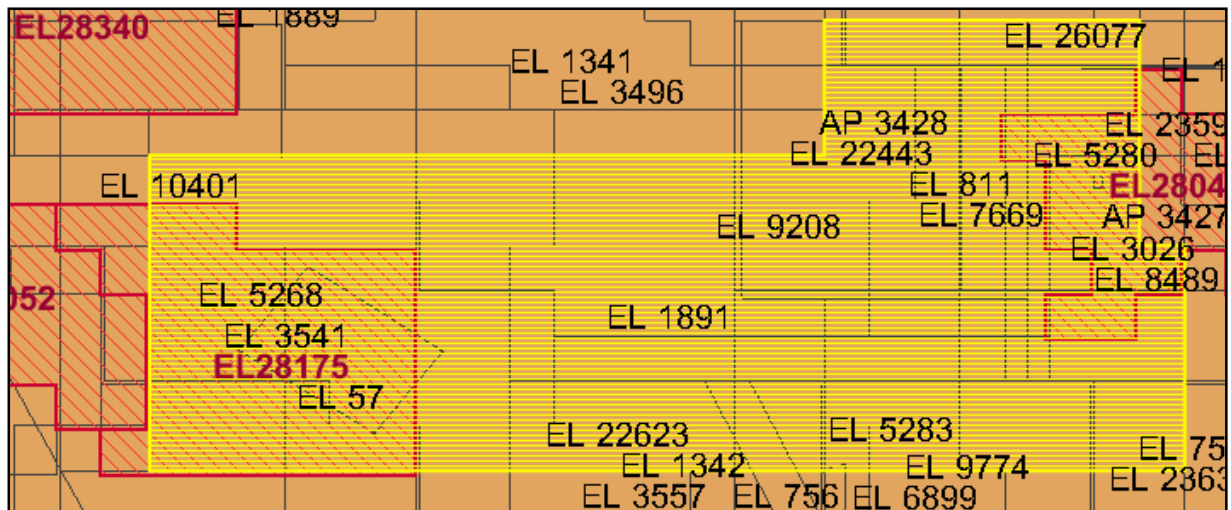

**Title:**

Quarterly Report period ending 4 October 1979 EL 1889 Yambah and EL 1891 Harry Creek Strangways Range.

**Report No:**

CR1979-0161

**Author:**

Close, RJ / Triako Mines

**Tenure:**

EL 1889 / **EL 1891**

**Province:**

Arunta Province

**Stratigraphy:**

Strangways Metamorphic Complex

**Prospect/Deposit:**

Red Rock Bore / Harry Creek / Burt Creek

**Thesaurus:**

Base metals

**Map Sheet:**

Alice Springs SF5314 / Burt 5651 / Laughlen 5751

**Abstract:**

Red Rock Bore, Harry Creek and Burt Creek base metal deposits were geologically investigated and covered by geochemical and geophysical surveys. Follow up shallow percussion drilling is planned for Red Rock Bore and Harry Creek prospects.

Quarterly Report period ending 4 April 1979 EL 1889 Yambah and EL 1891 Harry's Creek, Strangways Range.

**Report No:**

CR1979-0057

**Author:**

Close, RJ / Triako Mines

**Tenure:**

EL 1889 / **EL 1891**

**Province:**

Arunta Province

**Stratigraphy:**

Strangways Metamorphic Complex

**Prospect/Deposit:**

Rankins / Johnnies Reward Prospect / Edwards Creek / Oonagalabi / Red Rock Bore Prospect / Harry Creek / Gheko Prospect

**Thesaurus:**

Base metals

**Map Sheet:**

Alice Springs SF5314 / Burt 5651 / Laughlen 5751

**Abstract:**

Preliminary evaluation of base metal prospects in the Harts and Strangways Ranges. Work completed include literature search and two weeks field examination of area.

---

[Record No: 3 of 5](#)

**Title:**

Quarterly Report qe 4 July 1980 EL 1889 Yambah and EL 1891 Harry Creek Strangways Range.

**Report No:**

CR1980-0151

**Author:**

Bennett, G / Triako Mines

**Tenure:**

EL 1889 / **EL 1891**

**Province:**

Arunta Province

**Stratigraphy:**

Strangways Metamorphic Complex

**Prospect/Deposit:**

Red Rock Bore Prospect

**Thesaurus:**

Base metals

**Drilling:**

DDH4 and DDH5.

**Map Sheet:**

Alice Springs SF5314 / Burt 5651 / Laughlen 5751

**Abstract:**

Diamond drilling programme at Red Rock Bore intersected 0.47% lead, 1.69% zinc, 6.3g-t silver and 0.42% copper between 213 and 224m.

---

[Record No: 4 of 5](#)

**Title:**



Annual Report year ending 4 January 1980 EL 1889 Yambah and EL 1891 Harry Creek Strangways Range.

**Report No:**

CR1980-0009

**Author:**

Close, RJ / Triako Mines

**Tenure:**

EL 1889 / **EL 1891**

**Province:**

Arunta Province

**Stratigraphy:**

Strangways Metamorphic Complex

**Prospect/Deposit:**

Red Rock Bore / Harry Creek / Burt Creek

**Map Sheet:**

Alice Springs SF5314 / Burt 5651 / Laughlen 5751

**Abstract:**

Detailed exploration at Red Rock Bore and Harry's Creek prospects has outlined significant zone of coincident geophysical and geochemical anomalism. Follow up percussion and diamond drilling is planned.

---

[Record No: 5 of 5](#)

**Title:**

Quarterly Report qe 4 April 1980 EL 1889 Yambah and EL 1891 Harry Creek Strangways Range.

**Report No:**

CR1980-0095

**Author:**

Close, RJ / Triako Mines

**Tenure:**

EL 1889 / **EL 1891**

**Province:**

Arunta Province

**Stratigraphy:**

Strangways Metamorphic Complex

**Prospect/Deposit:**

Red Rock Bore Prospect

**Thesaurus:**

Base metals

**Map Sheet:**

Alice Springs SF5314 / Burt 5651 / Laughlen 5751

**Abstract:**

Commence diamond drilling of the Red Rock Bore prospect DDH4 has reached a depth of 56m. No mineralisation has been encountered.