

**Figure 1 E29883 Regional Location** *(Shown in Blue)*

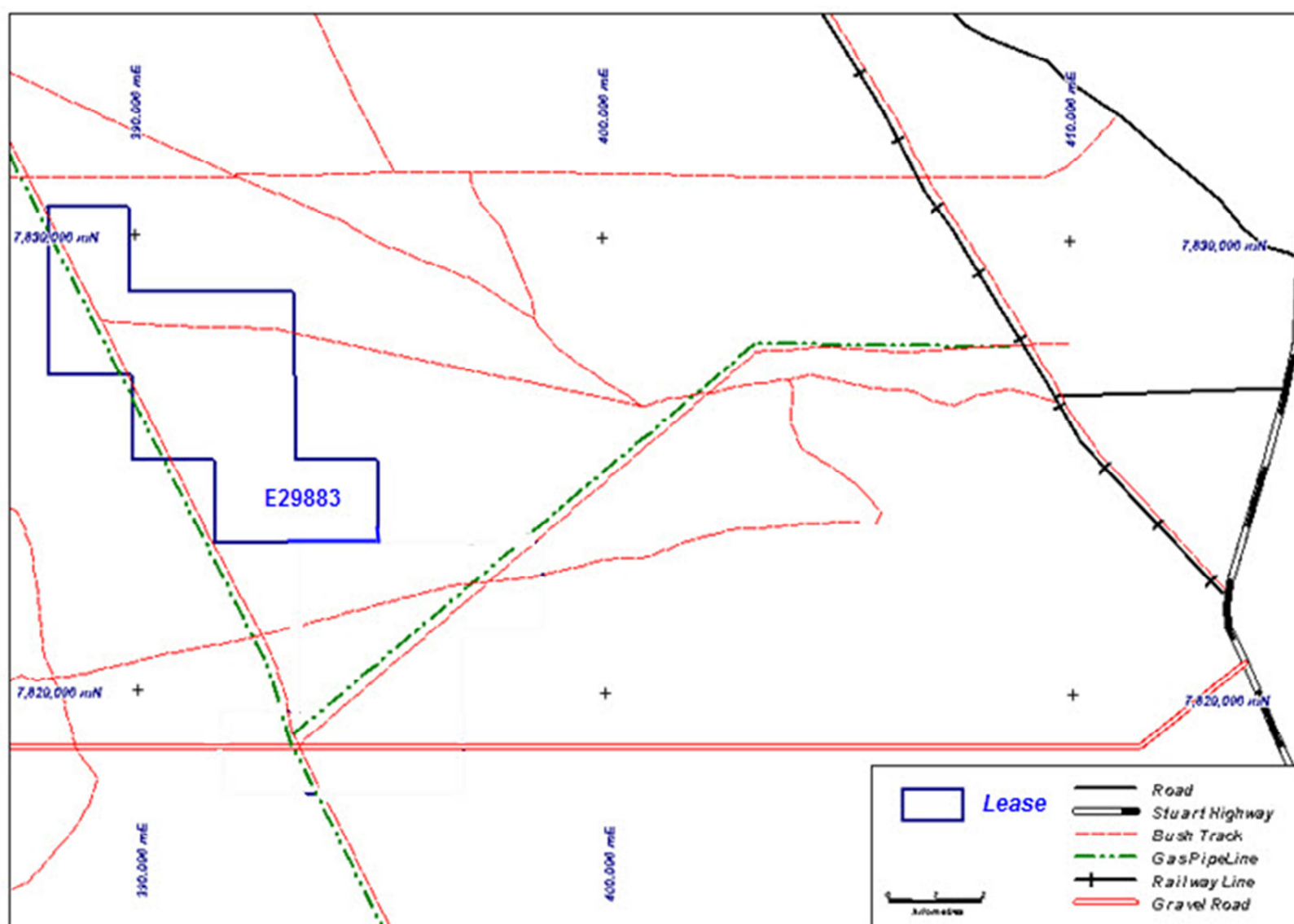

Figure 2 E29883 Local Access

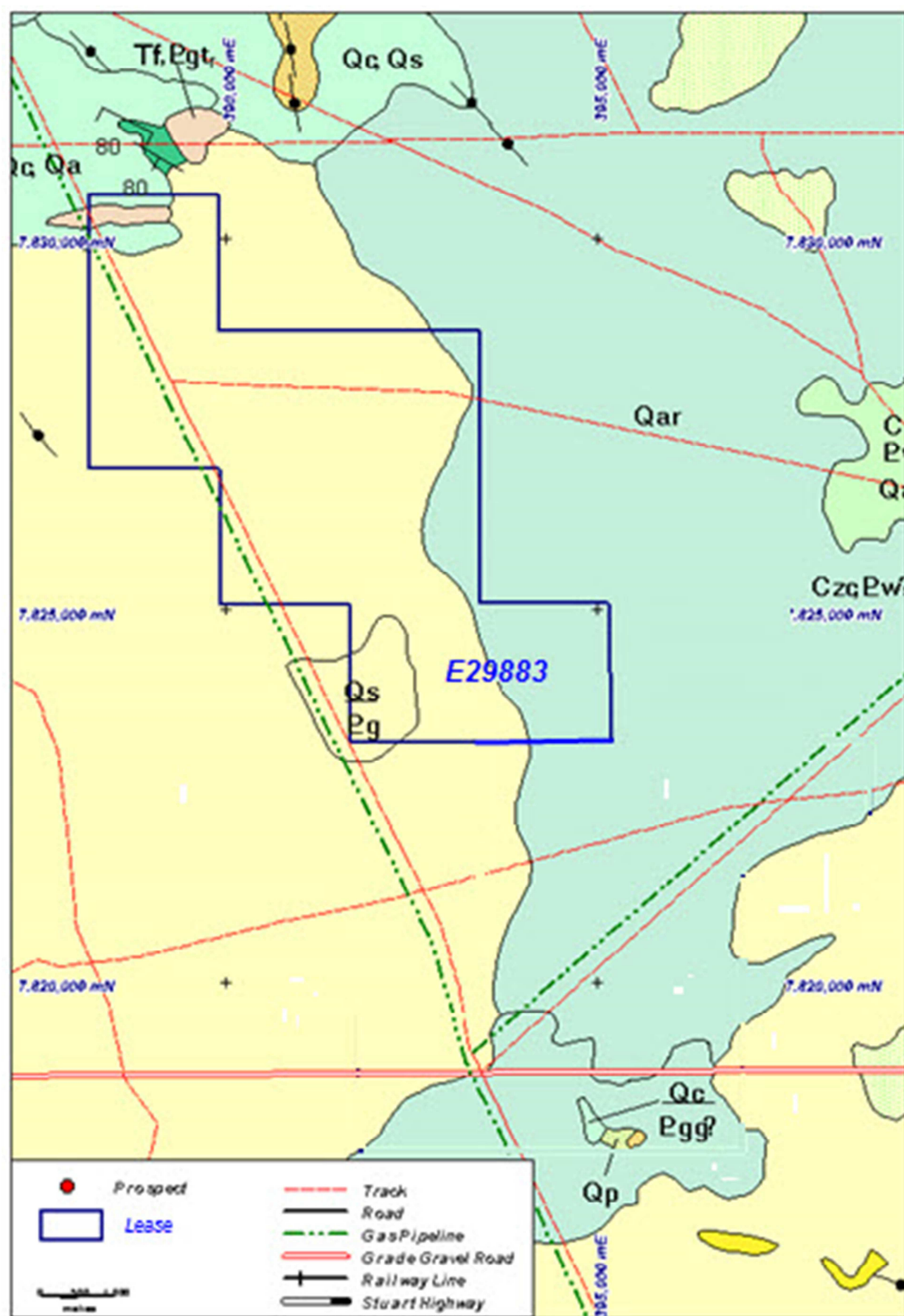

Figure 3 E29883 NTGS 1:250 000 Mapping



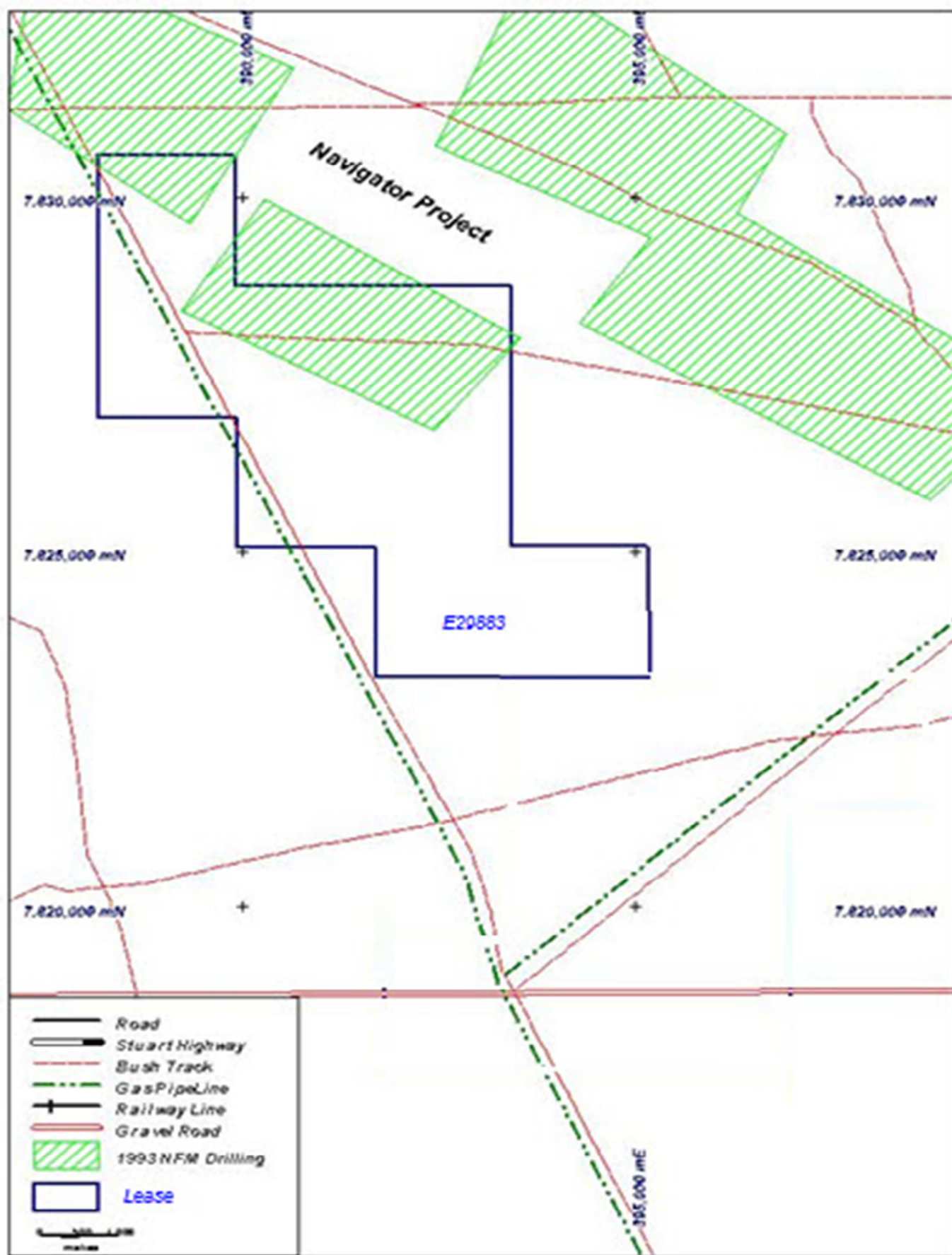
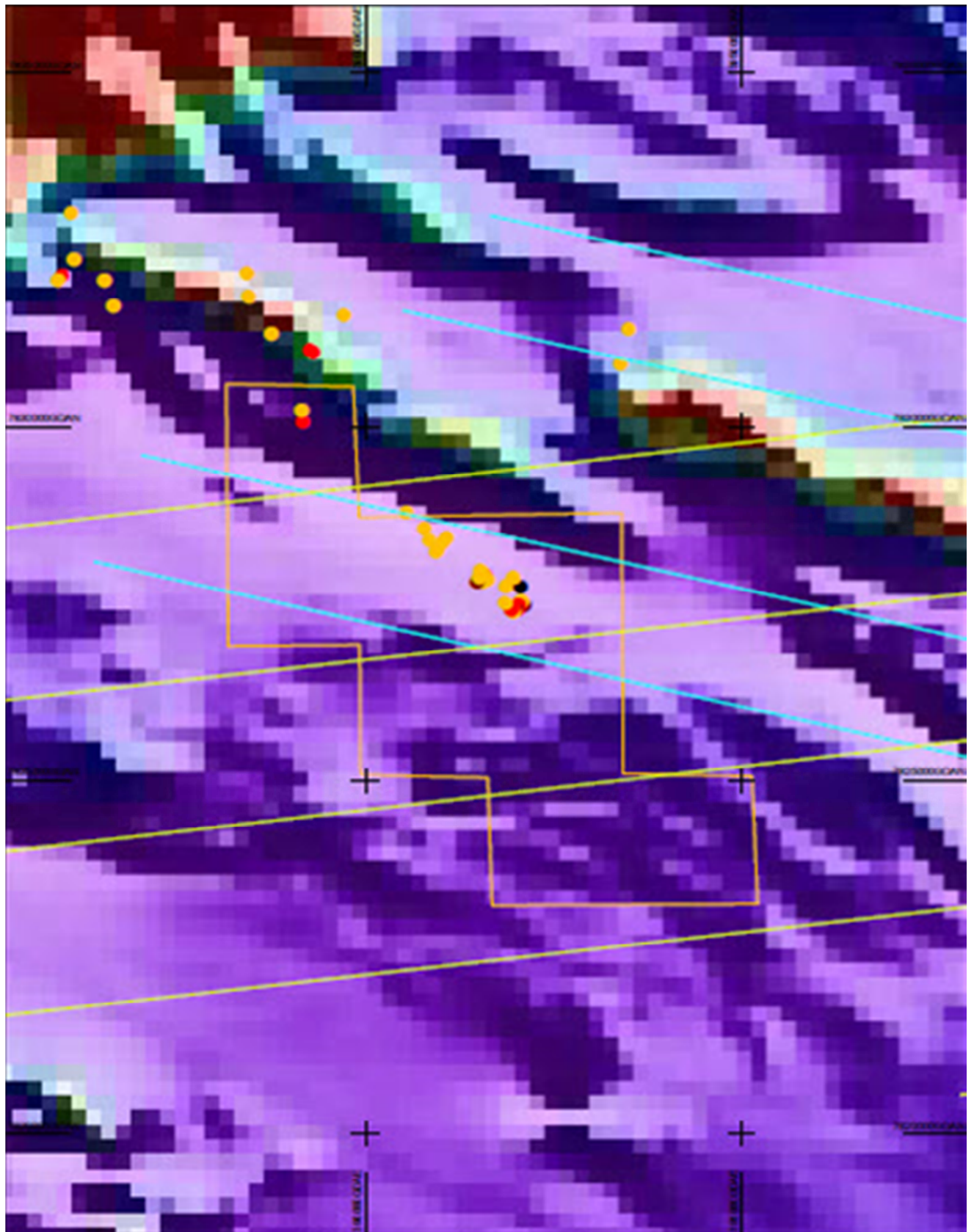

Figure 4 EL27145 Previous Exploration





**Figure 5 E29883 2013-2014 Geological Interpretations over Regional Aeromagnetics**  
(Colored Dots are historical Drill holes, blue & yellow lines are interpreted regional structural lin