

E.L. 26951 ANNUAL REPORT: Year 2

Titleholder:	Magic Place Pty Ltd.
Tenement Manager:	David J Langley
Title:	E.L. 26951
Project name:	"Steve's Hill"
Report Title & Date:	Annual Report Year 2. 27/8/11
Author:	David J Langley
Target commodity:	Gold
Datum/Zone:	GDA94/Zone 52
Map Sheet:	Marrakai 1:50,000 - WGS 84
Contact details:	Magic Place Pty Ltd PO Box 100 Darwin 0801
Phone:	Mr. D.Langley 0427861644 Mr. E. Chin 0418862888
Email:	nt_prospector@hotmail.com erniechin@ozemail.com.au

EXPLORATION SUMMARY EL.26951 (Steve's Hill") Year 2

The source of the nuggety gold on this E.L has not been discovered during this year's exploration. Because of the general lack of exploration success in the area by previous Mining Companies and the E.L holders, we decided to change tactics. There are very few outcrops in the area and the coarse, nuggety nature of the gold makes it difficult to narrow down the search using normal soil and rock chip sampling and assay methods. We therefore decided to use eight experienced friends to help by detecting the area using the latest metal detectors from Minelab. Two of the visitors were from W.A. and one from Qld. The visitors found numerous small nuggets with the largest weighing 12.5 grams. Myself and E.L partner Steve Lewis spent most of our time soil and rock chip sampling. Because of the coarse nature of the gold, I decided to take large (7kg) samples of rock chips and mill them in my portable sample mill and then pan them in clean water. This was the method used by NT Gold Pty Ltd and myself when finding the economic coarse gold "Marrakai Reef" 16 km S.W. along strike about fifteen years ago. On this occasion, none of the rock samples showed gold even when nuggets were found nearby. Several of the soil samples did show a little gold. Please refer to the attached sample information and the attached topographical map. (Marrakai 1: 50,000 – WGS 84).

E.L 26951 SAMPLES YEAR 2

Sample No.	Coordinates (GDA 94)		
127872	65677 E	87389 N	Soil. Nil Au
127873	64627 E	87000 N	3 nuggets, biggest 2.1 gm
127874	64185 N	86950 E	Rock Chips. Nil Au
127875	64203 E	88085 E	Magnetite, Nil Au
127876	64559 E	88067 N	Qtz, S,St, breccia Nil Au
127877	64779 E	88288 N	Qtz, FE, S,St. Nil Au.
127878	64254 E	87406 N	Nugget 1.3 gm
127879	64288 E	87254 N	Fine Au in Qtz.
127880	64220 E	87440 N	Nugget + Fe 1.5 gm.
127881	63536 E	87440 N	Qtz reef. Nil Au
127882	65627 E	85666 N	Creek gravel. Nil Au
127883	65932 E	85750 N	Creek gravel,. Nil Au

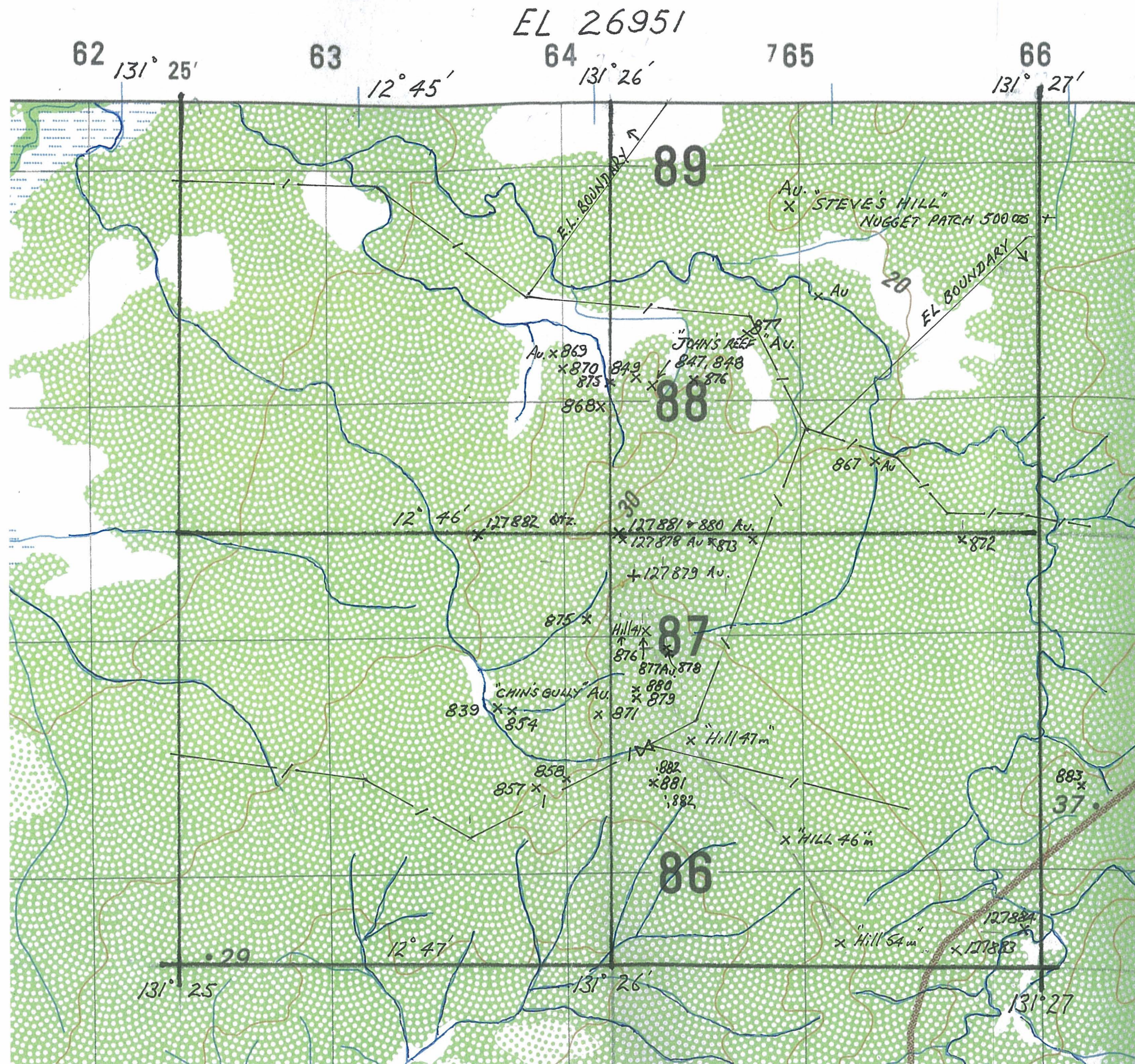

E.L. BOUNDARIES G3A 94

MAP DATUM. WGS 84

DRAWN: J. LANGLEY