



# GIANTS REEF EXPLORATION

A.B.N. 58 009 200 346

58 PEKO ROAD TENNANT CREEK NT 0860

PO BOX 1244 TENNANT CREEK NT 0861

Telephone 08 8962 1330 Facsimile 08 8962 2900

Email: email@giantsreef.com.au Website: www.giantsreef.com.au

## EXPLORATION LICENCE 10077

*WHIPPET EAST*

## EXPLORATION LICENCE 10101

*BINARY*

## EXPLORATION LICENCE 22165

*COPERNICUS*

## EXPLORATION LICENCE 22583

*MORNING STAR*

## EXPLORATION LICENCE 22589

*WHIPPET HILL*

## EXPLORATION LICENCE 22590

*STUART HIGHWAY*

### SECOND COMBINED ANNUAL REPORT

25 SEPTEMBER 2002 – 24 SEPTEMBER 2003

*LICENSEE:*

**GIANTS REEF EXPLORATION PTY LTD**

A.C.N. 009 200 346

*AUTHOR:*

J.L. CAHILL

October 2003

#### DISTRIBUTION:

Department of Business Industry & Resource Development  
Central Land Council  
Giants Reef Exploration Pty Ltd  
Giants Reef Mining Limited

☐  
☐  
☐  
☐

SE53-14  
TENNANT CREEK 1:250 000  
5759  
Flynn 1:100 000

## SUMMARY

Exploration Licences 10077 *Whippet Hill*, 10101 *Binary*, 22165 *Copernicus*, 22583 *Morning Star*, 22589 *Whippet Hill* and EL 22590 *Stuart Highway*, were acquired by Giants Reef Exploration Pty Ltd (Giants Reef) to search for Tennant Creek style ironstone-related gold-copper deposits.

This combined report records the exploration work done on EL's 10077, 10101, 22165, 22583, 22589, and 22590 during their second year of tenure from the 25<sup>th</sup> September 2002 to the 24<sup>th</sup> September 2003.

All six Licences were granted to Giants Reef Exploration Pty Ltd on 20<sup>th</sup> October 2001, for a period of 6 years each.

The EL's are subject to an Indigenous Land Use Agreement signed in September 2000 between the Native Title holders of the Tennant Creek region, represented by the Central Land Council, and Giants Reef.

The combined Licence area is considered by Giants Reef as having the potential to host shallow, high grade oxide gold within haematite-magnetite ironstone. At present little work has been conducted over the EL's by Giants Reef, and a thorough assessment of the Licence areas will be made in the next tenure year to identify target areas with the view to reducing the size of the EL's, and retaining only the areas of definite interest.

In September 2003, Giants Reef advertised for a Project Geologist to join the exploration team. This person will be responsible for the exploration of a number of tenements including Exploration Licences 10077, 10101, 22165, 22583, 22589, and 22590. Additionally, the geology of the Licence areas will be assessed to decide whether a close spaced, high resolution gravity survey is warranted over the area.

By the end of the second year of tenure of the EL's, no further analysis, target generation or on-ground exploration was carried out over the EL's, due to Giants Reef's commitments being focussed elsewhere in the Tennant Creek goldfield.

## CONTENTS

	PAGE
SUMMARY .....	i.
CONTENTS.....	ii.
1. INTRODUCTION.....	1.
2. LOCATION .....	1.
3. TENURE.....	1.
4. GEOLOGY .....	2.
4.1 Regional Geology .....	1.
4.2 Local Geology .....	2.
5. WORK DONE DURING THE YEAR.....	2.
5.1 Targets and Concepts.....	2.
5.2 EL 10077 <i>Whippet East</i> .....	3.
5.3 EL 10101 <i>Binary</i> .....	3.
5.4 EL 22165 <i>Copernicus</i> .....	4.
5.5 EL 22583 <i>Morning Star</i> .....	4.
5.6 EL 22589 <i>Whippet Hill</i> .....	4.
5.7 EL 22590 <i>Stuart Highway</i> .....	5.
5.8 Exploration by Giants Reef .....	5.
6. REHABILITATION.....	5.
7. CONCLUSIONS .....	6.
8. EXPENDITURE.....	7.
8.1 EL 10077 <i>Whippet East</i> .....	7.
8.2 EL 10101 <i>Binary</i> .....	7.
8.3 EL 22165 <i>Copernicus</i> .....	8.
8.4 EL 22583 <i>Morning Star</i> .....	8.
8.5 EL 22589 <i>Whippet Hill</i> .....	9.
8.6 EL 22590 <i>Stuart Highway</i> .....	9.
9. PROPOSED PROGRAM AND EXPENDITURE FOR YEAR 3 .....	10.
9.1 EL 10077 <i>Whippet East</i> .....	10.
9.2 EL 10101 <i>Binary</i> .....	10.
9.3 EL 22165 <i>Copernicus</i> .....	10.
9.4 EL 22583 <i>Morning Star</i> .....	11.
9.5 EL 22589 <i>Whippet Hill</i> .....	11.
9.6 EL 22590 <i>Stuart Highway</i> .....	11.

## FIGURES

1. Location Map
2. EL 10077 *Whippet East* Year 2 Licence Area
3. EL 10101 *Binary* Year 2 Licence Area
4. EL 22165 *Copernicus* Year 2 Licence Area
5. EL 22583 *Morning Star* Year 2 Licence Area
6. EL 22589 *Whippet Hill* Year 2 Licence Area
7. EL 22590 *Stuart Highway* Year 2 Licence Area

## 1. INTRODUCTION

Exploration Licences 10077 *Whippet Hill*, 10101 *Binary*, 22165 *Copernicus*, 22583 *Morning Star*, 22589 *Whippet Hill* and EL 22590 *Stuart Highway*, were acquired by Giants Reef Exploration Pty Ltd (Giants Reef) to search for Tennant Creek style ironstone-related gold-copper deposits.

This combined report records the exploration work done on EL's 10077, 10101, 22165, 22583, 22589, and 22590 during their second year of tenure from the 25<sup>th</sup> September 2002 to the 24<sup>th</sup> September 2003.

## 2. LOCATION

Exploration Licences 10077, 10101, 22165, 22583, 22589, and 22590 cover an irregularly shaped tract of country spanning the Stuart Highway 35km north of Tennant Creek Township.

The principal access to the general Licence area from Tennant Creek is north via the Stuart Highway and then east or west by various dirt roads and fence lines tracks. However, much of the Licence areas are rocky, without tracks and difficult to reach, even in a 4x4 vehicle. The unsealed tracks become impassable during the wet season.

Figure 1 shows the location of these Licences with respect to Tennant Creek town.

## 3. TENURE

Tenure details for the six Exploration Licences are as follows:

Exploration Licence	Licence Holder	Blocks & part-blocks	Area (km <sup>2</sup> )	Date of Grant	Period of Grant
10077 Whippet Hill	Giants Reef Exploration Pty Ltd	5	16.21	25 September 2002	6 years
10101 Binary	Giants Reef Exploration Pty Ltd	12	33.47	25 September 2002	6 years
22165 Copernicus	Giants Reef Exploration Pty Ltd	6	19.45	25 September 2002	6 years
22583 Morning Star	Giants Reef Exploration Pty Ltd	19	61.57	25 September 2002	6 years
22589 Whippet Hill	Giants Reef Exploration Pty Ltd	11	31.63	25 September 2002	6 years
22590 Stuart Highway	Giants Reef Exploration Pty Ltd	3	9.05	25 September 2002	6 years

The six Exploration Licences lie within NT Portion 408, Phillip Creek, Perpetual Pastoral Lease 946.

All six EL's are subject to an Indigenous Land Use Agreement (ILUA), signed in September 2000 between the Native Title holders of the Tennant Creek region, represented by the Central Land Council, and Giants Reef.

At the end of the second year a waiver of reduction for each EL was applied for to retain the full Licence areas for the third year of tenure.

Figures 2, 3, 4, 5, 6 and 7 show the individual Licence areas as they were during Year 2.

#### 4. GEOLOGY

##### 4.1 Regional Geology

The reader is referred to AusIMM Monograph 14 (Geology of the Mineral Deposits of Australia and Papua New Guinea), Volume 1, pp. 829-861, to gain a good introduction to the regional geology and styles of gold-copper mineralisation of the area.

In 1995 the Northern Territory Geological Survey released a geological map and explanatory notes on the Flynn 1:100,000 sheet. The rocks of the Warramunga Formation host most of the orebodies in the region and underlie most of the Mineral Lease.

##### 4.2 Local Geology

The project area is on the northern fringe of the established Tennant Creek goldfield. Except in a few localities, bedrock geology within the Licence area is not well revealed due to the discontinuous nature of sparse outcrops. Much of the combined Licence area is underlain by the predominantly felsic volcanics or volcanically derived sedimentary rocks of the Flynn Sub-group, while the more northern areas consist of sediments of the lower Tomkinson Creek Sub-group.

The geology in the southern and eastern Licence areas consists of scattered outcrops of weathered siltstone and greywacke of the Palaeoproterozoic Warramunga Formation.

Quaternary sand and gravel covers most bedrock exposures to the east of the Stuart Highway however outcrop occurrence tends to increase to the west of the Stuart Highway.

There are a number of intermittent outcrops of granite, metamorphosed sediments and ironstone throughout the western part of the combined Licence area.

#### 5. WORK DONE DURING THE YEAR

##### 5.1 Targets and Concepts

Exploration within EL's 10077, 10101, 22165, 22583, 22589, and 22590 is aimed at discovering typical Tennant Creek style gold deposits or gold-copper deposits within ironstone of the Warramunga Formation.

This type of deposit is well documented, of which there are many examples in the region, including Warrego, White Devil, Orlando, Gecko and North Star mines, as well as many other smaller mines. These all take the form of ironstone (magnetite and/or haematite) masses with associated chloritic alteration and bodies of gold and/or copper mineralisation.

There are numerous old mines and prospects of this type within the central part of EL 22583, held under Mineral Claims and Licences by Santexco Pty Ltd (subsidiary of Giants Reef Mining Limited). These include the Golden Slipper, Queen of Sheba, Ria's Revenge (also known as Queen Alexandria) and Morning Star. The Whippet mine (production 13,624t @ 32.68 g/t Au) is contained within EL 22589. There are also a number of other ironstone outcrops, and magnetic anomalies that probably represent non-outcropping ironstone masses, scattered throughout most of the EL's.

The discovery of the non-magnetic, haematite-rich Chariot deposit in 1998 has resulted in a broader exploration model by Giants Reef, which allows for the presence of extensive ore grade mineralisation hosted within primary, non-magnetic (haematite-rich) ironstones. Discoveries by Giants Reef of high grade mineralisation associated with haematite dominant ironstone at Marathon and Billy Boy, although small, are further examples of this style of mineralisation.

The potential for the haematite ironstones to host mineralisation in non magnetic areas essentially opens up the whole Tennant Creek goldfield to new target review. Along with the previously identified magnetic anomalies the Licence areas have the potential to host significant haematite mineralization either as new targets or as mineralization extensions. At present there are no gravity maps for the Tennant Creek goldfield considered detailed enough to identify non-magnetic, haematitic gravity targets. In the next tenure year the geology of the combined Licence area will be assessed to decide whether a close spaced, high resolution gravity survey is warranted over the area.

## 5.2 EL 10077 Whippet East

Exploration Licence 10077 was initially applied for to cover a dipole magnetic feature identified in a 1993 Western Mining (WMC) aeromagnetic survey. The magnetic feature is located between 134° 18' 00", 19° 18' 00" and 134° 19' 00", 19° 19' 00" and was subsequently called the "Whipped East" magnetic anomaly by Giants Reef.

In the first tenure year Frank Lindeman, of Lindeman Geophysics Pty Ltd Melbourne, modelled the Whippet East anomaly using the 1998 AGSO aeromagnetic data. Mr Lindeman's preliminary assessment was not encouraging. He suggested that a ground magnetic survey should be completed over the anomaly which would provide detailed data which he could then model with more confidence.

An assessment was made of the exploration potential and prospectivity of the Licence area in the second year. The presence of the Whippet Hill mine which produced 18,800 oz Au, located approximately 2km to the west of the anomaly within a highly gold-productive corridor that includes Edna Beryl, Troy, Marathon and others upgrades the anomaly substantially.

The review recommended the Whippet East magnetic anomaly for magnetic modelling, and subsequent drilling if warranted.

The proposed magnetic modelling was not undertaken in the second tenure year due to Giants Reef's commitments being elsewhere in the Tennant Creek goldfield.

## 5.3 EL 10101 Binary

Exploration Licence 10101 was initially applied to cover an area to the south of known mineralisation within Giants Reef's Marathon, Troy and Edna Beryl prospects.

A literature review of EL 10101 in the first tenure year identified 3 target areas that require further investigation.

- A possible trend of mineralisation from Giants Reef's North Star mine, running east-northeast through the northwest corner of the Licence into adjoining EL 22165.
- The Rhodes magnetic anomaly east of the Stuart Highway, centred at 415700mE 7861300mN (AMG AGD84). Western Mining completed a large ground magnetic survey over this anomaly but decided not to drill it because it is in an area of low gravity, and not on a gravity ridge. This anomaly remains unexplained.
- Another aeromagnetic anomaly 1.5km southeast of Rhodes, at 417100mE 7860800mN (AMG AGD84). This anomaly was called Rhodes South by Giants Reef. Research indicates no work has been done on this anomaly, even though it appears to be stronger than Rhodes, and more importantly, lies on a northeast-trending gravity ridge which is clearly defined in WMC's regional gravity survey. This gravity feature, though not as broad as the North Star to Whippet ridge, could well represent a narrower band of concealed Warramunga Formation rocks.

Establishment of an AMG AGD 94 grid over the Rhodes and the Rhodes South anomalies, further geophysical assessment, modelling and the collection of soil and rock samples was proposed for the target areas.

The proposed exploration over the anomalies was not undertaken in the second tenure year due to Giants Reef's commitments being elsewhere in the Tennant Creek goldfield.

#### 5.4 EL 22165 *Copernicus*

Exploration Licence 22165 was initially applied to cover a prospective area of land surrounding the North Star mine (102 000t @ 7.9 g/t Au) group of mineral claims that at the time of grant were owned by Normandy Tennant Creek Pty Ltd. These Mineral Claims and Leases cover approximately 40% of Licence area.

In the first tenure year Giants Reef's contract geophysicist Mr Frank Lindeman of Lindeman Geophysics Pty Ltd, Melbourne geophysically assessed the Licence area. Mr Lindeman's assessment of the 1998 AGSO aeromagnetic data covering the Licence area was encouraging with several low order magnetic anomalies identified for drill testing. The potential for gold-copper mineralisation in haematite dominant ironstone is considered high and acquisition of detailed gravity data over the area was suggested by Mr Lindeman.

Further geophysical assessment of the EL was not undertaken in the second tenure year due to Giants Reef's commitments being elsewhere in the Tennant Creek goldfield.

#### 5.5 EL 22583 *Morning Star*

Exploration Licence 22583 was initially applied to cover a prospective area of Warramunga Formation and coincident gravity ridge running from North Star mine southwesterly to the Queen of Sheba and Gecko mines. It includes an old prospect called the Morning Star (also known as Queen Alexandria or Ria's Revenge) as well as Golden Slipper and Last Princess.

In the first year of tenure a detailed literature review was conducted over the area covered by the Licence. Newmont explored this area during 1987 to 1990 under EL 5066 in a Joint Venture with Posgold. Later, Posgold held the area under EL 8748. Six RAB holes (327m) were drilled at Morning Star by Posgold, with a two-metre best interval of 9.58 g/t Au from 27 metres. The other holes returned no significant result.

Further assessment of the EL and target generation was not undertaken in the second tenure year due to Giants Reef's commitments being elsewhere in the Tennant Creek goldfield.

#### 5.6 EL 22589 *Whippet Hill*

Exploration Licence 22589 was initially applied to cover a prospective area of Warramunga Formation and coincident gravity ridge running approximately east-west from North Star through Edna Beryl to the Whippet mine. The historical high-grade producing mine, Whippet is contained within this EL.

Geological review of the Licence area in the first year of tenure identified several deep regional aeromagnetic anomalies also exist along this gravity ridge in an area of soil cover and no outcrop. Three targets were identified in the Licence.

- Mother of Olympus – Geophysical assessment found that this magnetic anomaly has a large lateral extent and a peak amplitude of 30 nT. Mr Lindeman interpreted the Mother of Olympus target as going to be deep (he suggested 450-500m to the top) and expensive to explore.



- Whippet Mine area – Frank Lindeman conducted a magnetic modelling exercise over the Whippet mine area during the reporting period. Mr Lindeman's results indicated that *"although a shallow, steeply dipping and depth-limited magnetic body appears to quite accurately represent the known and mined ironstone body, a deeper and presumably untested weakly magnetic body appears to exist, just east of the mine"*.
- Whippet South – Review found that this magnetic anomaly occurs as a strong east-west magnetic anomaly in the southeastern corner of EL 22589. Several RC drill holes were drilled by WMC in late 1980 however they all failed to reach target depth. The magnetic anomaly also has a coincident gravity anomaly.

Further assessment of the EL and magnetic anomalies was not undertaken in the second tenure year due to Giants Reef's commitments being elsewhere in the Tennant Creek goldfield.

#### 5.7 EL 22590 Stuart Highway

In the first year of tenure Giants Reef's consultant geophysicist Mr Lindeman of Lindeman Geophysics Pty Ltd, Melbourne completed a brief geophysical appraisal of the EL area. No gravity or magnetic anomalies worthy of follow up on-ground exploration were identified.

Further assessment of the EL and target generation was not undertaken in the second tenure year due to Giants Reef's commitments being elsewhere in the Tennant Creek goldfield.

#### 5.8 Exploration by Giants Reef

During the 2003 field season a program of immediate-priority definition drilling of the Chariot gold deposit prevented further geological review over the Licence areas. The exploration focus by Giants Reef for 2003 was on developing a model and exploration strategy for discovering high grade mineralisation associated with haematite dominant ironstone. This involved ground gravity surveys, geophysical modelling and drilling of gravity targets, over and adjacent to the Chariot gold deposit. The outcomes of the gravity targeting have proven successful, and Giants Reef intends to utilise this method of exploration over prospective ground in the future.

In September 2003, Giants Reef advertised for a Project Geologist to join the exploration team. This person will be responsible for the exploration of a number of tenements including Exploration Licences 10077, 10101, 22165, 22583, 22589, and 22590. Additionally, the geology of the Licence areas will be assessed to decide whether a close spaced, high resolution gravity survey is warranted over the area.

The focus on gravity testing, and the definition drilling at Chariot gold deposit prevented Giants Reef from undertaking the proposed target generation and exploration over the Licence areas in the second tenure year.

The combined Licence area is considered by Giants Reef as having the potential to host shallow, high-grade oxide gold within haematite-magnetite ironstone. At present little work has been conducted over the EL's by Giants Reef, and a thorough assessment of the Licence areas will be made in the next tenure year to identify target areas with the view to reducing the size of the EL's, and retaining only the areas of definite interest.

### 6. REHABILITATION

None of the work done on EL's 10077, 10101, 22165, 22583, 22589, and 22590 has required any rehabilitation measures.

## 7. CONCLUSIONS

Exploration within EL's 10077, 10101, 22165, 22583, 22589, and 22590 is aimed at discovering typical Tennant Creek style gold deposits or gold-copper deposits within ironstone of the Warramunga Formation.

The combined Licence area is considered by Giants Reef as having the potential to host shallow, high grade oxide gold within haematite-magnetite ironstone. At present little work has been conducted over the EL's by Giants Reef, and a thorough assessment of the Licence areas will be made in the next tenure year to identify target areas with the view to reducing the size of the EL's, and retaining only the areas of definite interest.

In September 2003, Giants Reef advertised for a Project Geologist to join the exploration team. This person will be responsible for the exploration of a number of tenements including Exploration Licences 10077, 10101, 22165, 22583, 22589, and 22590. Additionally, the geology of the Licence areas will be assessed to decide whether a close spaced, high resolution gravity survey is warranted over the area.

By the end of the second year of tenure of the EL's, no further analysis, target generation or on-ground exploration was carried out over the EL's, due to Giants Reef's commitments being focussed elsewhere in the Tennant Creek goldfield.

## 8. EXPENDITURE

### 8.1 EL 10077 *Whippet East*:

The proposed expenditure for the second year of tenure was \$6,500. Actual expenditure was as follows:

	\$
1. Geology .....	207
2. Geophysics .....	0
3. Geochemistry .....	0
4. Surveying .....	0
5. Data integration .....	0
6. Analytical .....	0
7. Drilling .....	0
8. Tenure maintenance .....	965
9. Administration and overheads .....	201
10. Rehabilitation .....	0
<b>TOTAL</b>	<b>\$1,373</b>

Total expenditure amounted to an approximate \$1,373. As the expenditure covenant was not met, an application for variation of the minimum expenditure accompanies this report.

### 8.2 EL 10101 *Binary*:

The proposed expenditure for the second year of tenure was \$8,000. Actual expenditure was as follows:

	\$
1. Geology .....	0
2. Geophysics .....	0
3. Geochemistry .....	0
4. Surveying .....	0
5. Data integration .....	0
6. Analytical .....	0
7. Drilling .....	0
8. Tenure maintenance .....	332
9. Administration and overheads .....	238
10. Rehabilitation .....	0
<b>TOTAL</b>	<b>\$570</b>

Total expenditure amounted to an approximate \$570. As the expenditure covenant was not met, an application for variation of the minimum expenditure accompanies this report.

### 8.3 EL 22165 *Copernicus*:

The proposed expenditure for the second year of tenure was \$6,000. Actual expenditure was as follows:

	\$
1. Geology .....	92
2. Geophysics .....	0
3. Geochemistry .....	0
4. Surveying .....	0
5. Data integration .....	0
6. Analytical .....	0
7. Drilling .....	0
8. Tenure maintenance .....	240
9. Administration and overheads .....	0
10. Rehabilitation .....	0
<b>TOTAL</b>	<b>\$332</b>

Total expenditure amounted to an approximate \$332. As the expenditure covenant was not met, an application for variation of the minimum expenditure accompanies this report.

### 8.4 EL 22583 *Morning Star*:

The proposed expenditure for the second year of tenure was \$9,000. Actual expenditure was as follows:

	\$
1. Geology .....	92
2. Geophysics .....	0
3. Geochemistry .....	0
4. Surveying .....	0
5. Data integration .....	0
6. Analytical .....	0
7. Drilling .....	0
8. Tenure maintenance .....	300
9. Administration and overheads .....	0
10. Rehabilitation .....	0
<b>TOTAL</b>	<b>\$392</b>

Total expenditure amounted to an approximate \$392. As the expenditure covenant was not met, an application for variation of the minimum expenditure accompanies this report.

#### 8.5 EL 22589 *Whippet Hill*:

The proposed expenditure for the second year of tenure was \$9,000. Actual expenditure was as follows:

	\$
1. Geology .....	92
2. Geophysics .....	0
3. Geochemistry .....	0
4. Surveying .....	0
5. Data integration .....	0
6. Analytical .....	0
7. Drilling .....	0
8. Tenure maintenance .....	480
9. Administration and overheads .....	0
10. Rehabilitation .....	215
<b>TOTAL</b>	<b>\$787</b>

Total expenditure amounted to an approximate \$787. As the expenditure covenant was not met, an application for variation of the minimum expenditure accompanies this report.

#### 8.6 EL 22590 *Stuart Highway*:

The proposed expenditure for the second year of tenure was \$3,500. Actual expenditure was as follows:

	\$
1. Geology .....	0
2. Geophysics .....	0
3. Geochemistry .....	0
4. Surveying .....	0
5. Data integration .....	0
6. Analytical .....	0
7. Drilling .....	0
8. Tenure maintenance .....	122
9. Administration and overheads .....	0
10. Rehabilitation .....	0
<b>TOTAL</b>	<b>\$122</b>

Total expenditure amounted to an approximate \$122. As the expenditure covenant was not met, an application for variation of the minimum expenditure accompanies this report.

## 9. PROPOSED PROGRAM AND EXPENDITURE FOR YEAR THREE

### 9.1 EL 10077 Whippet East:

	\$
Geology .....	500
<i>planning and supervision</i>	
Geophysics .....	2,500
<i>assessment of geophysical data</i>	
Analytical .....	0
Drilling .....	0
Rehabilitation .....	0
Tenure Maintenance .....	1,000
Administration and Overheads .....	500

TOTAL \$4,500

### 9.2 EL 10101 Binary:

	\$
Geology .....	500
<i>planning and supervision</i>	
Geophysics .....	1,500
<i>assessment of geophysical data</i>	
Analytical .....	2,000
<i>assaying</i>	
Drilling .....	2,500
Rehabilitation .....	500
Tenure Maintenance .....	500
<i>(incl. CLC costs)</i>	
Administration and Overheads .....	1,000

TOTAL \$8,500

### 9.3 EL 22165 Copernicus:

	\$
Geology .....	1,500
<i>planning and assessment</i>	
Geophysics .....	2,500
<i>assessment of geophysical data</i>	
Analytical .....	0
Drilling .....	0
Rehabilitation .....	0
Tenure Maintenance .....	1,000
<i>(incl. CLC costs)</i>	
Administration and Overheads .....	500

TOTAL \$5,500

9.4 EL 22583 Morning Star:

	\$
Geology .....	1,500
<i>assessment and planning</i>	
Geophysics .....	2,500
<i>assessment of geophysical data</i>	
Analytical .....	1,000
<i>assaying</i>	
Drilling .....	2,500
RC	
Rehabilitation.....	500
Tenure Maintenance.....	1,000
<i>(incl. CLC costs)</i>	
Administration and Overheads .....	1,000
	TOTAL \$10,000

9.5 EL 22589 Whippet Hill:

	\$
Geology .....	1,000
<i>assessment and planning</i>	
Geophysics.....	1,500
<i>assessment of geophysical data</i>	
Analytical .....	1,000
<i>assaying</i>	
Drilling .....	3,000
RC	
Rehabilitation.....	500
Tenure Maintenance.....	1,000
<i>(incl. CLC costs)</i>	
Administration and Overheads .....	500
	TOTAL \$8,500

9.5 EL 22590 Stuart Highway:

	\$
Geology .....	1,000
<i>assessment and planning</i>	
Geophysics.....	1,000
<i>assessment of geophysical data</i>	
Analytical .....	0
Drilling .....	0
Rehabilitation.....	0
Tenure Maintenance.....	300
<i>(incl. CLC costs)</i>	
Administration and Overheads .....	200
	TOTAL \$2,500

Exploration programs are affected by the results achieved as the work progresses, and while these are the proposed programs and expenditures for the coming year, some changes may become necessary.

JUSTINE CAHILL  
*EXPLORATION GEOLOGIST*



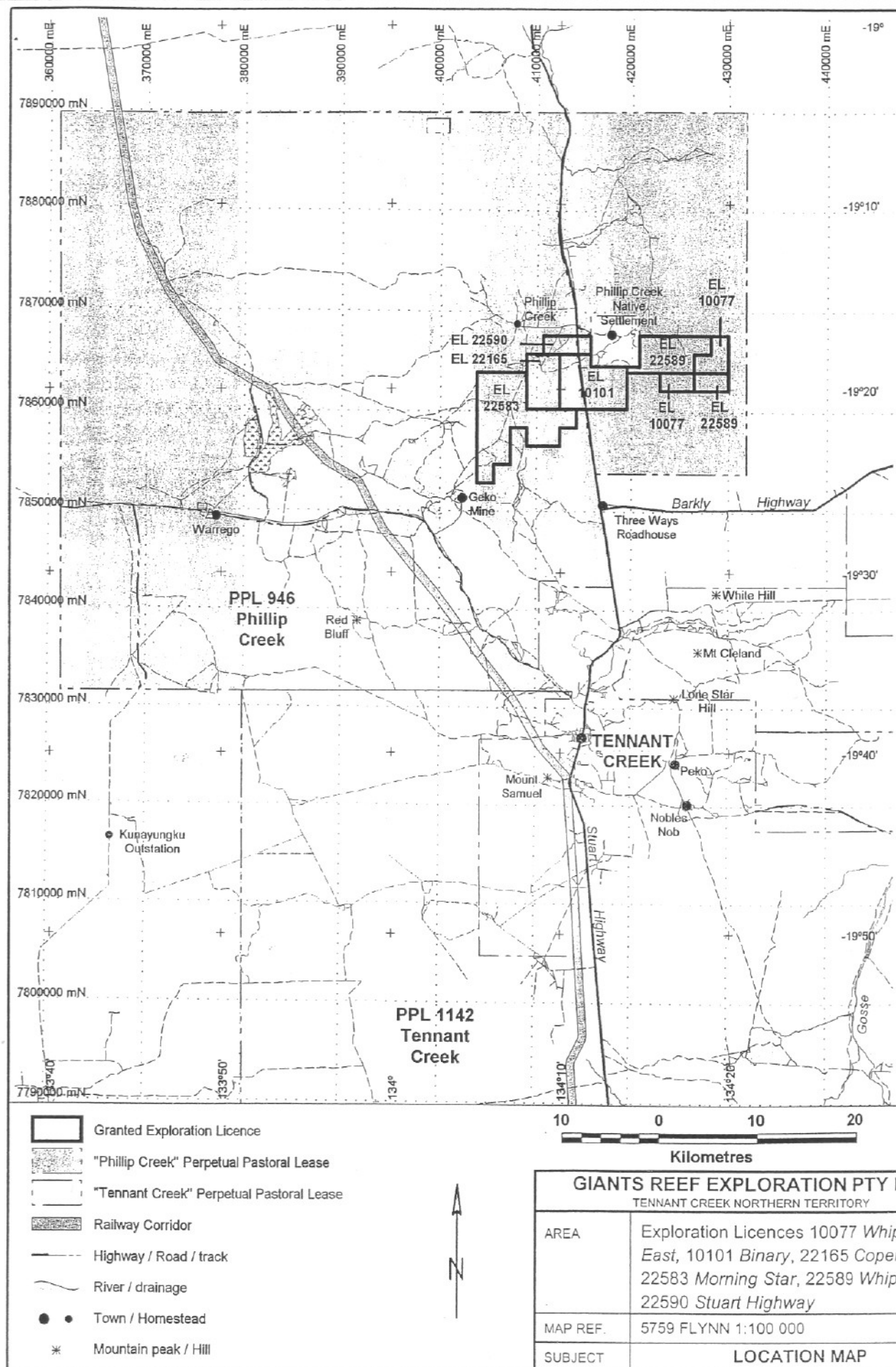

GIANTS REEF EXPLORATION PTY LTD			
TENNANT CREEK NORTHERN TERRITORY			
AREA	Exploration Licences 10077 Whippet East, 10101 Binary, 22165 Copernicus, 22583 Morning Star, 22589 Whippet Hill, 22590 Stuart Highway		
MAP REF.	5759 FLYNN 1:100 000		
SUBJECT	LOCATION MAP		
DATE	AUTHOR	SCALE	
MAR 2002			FIGURE 1



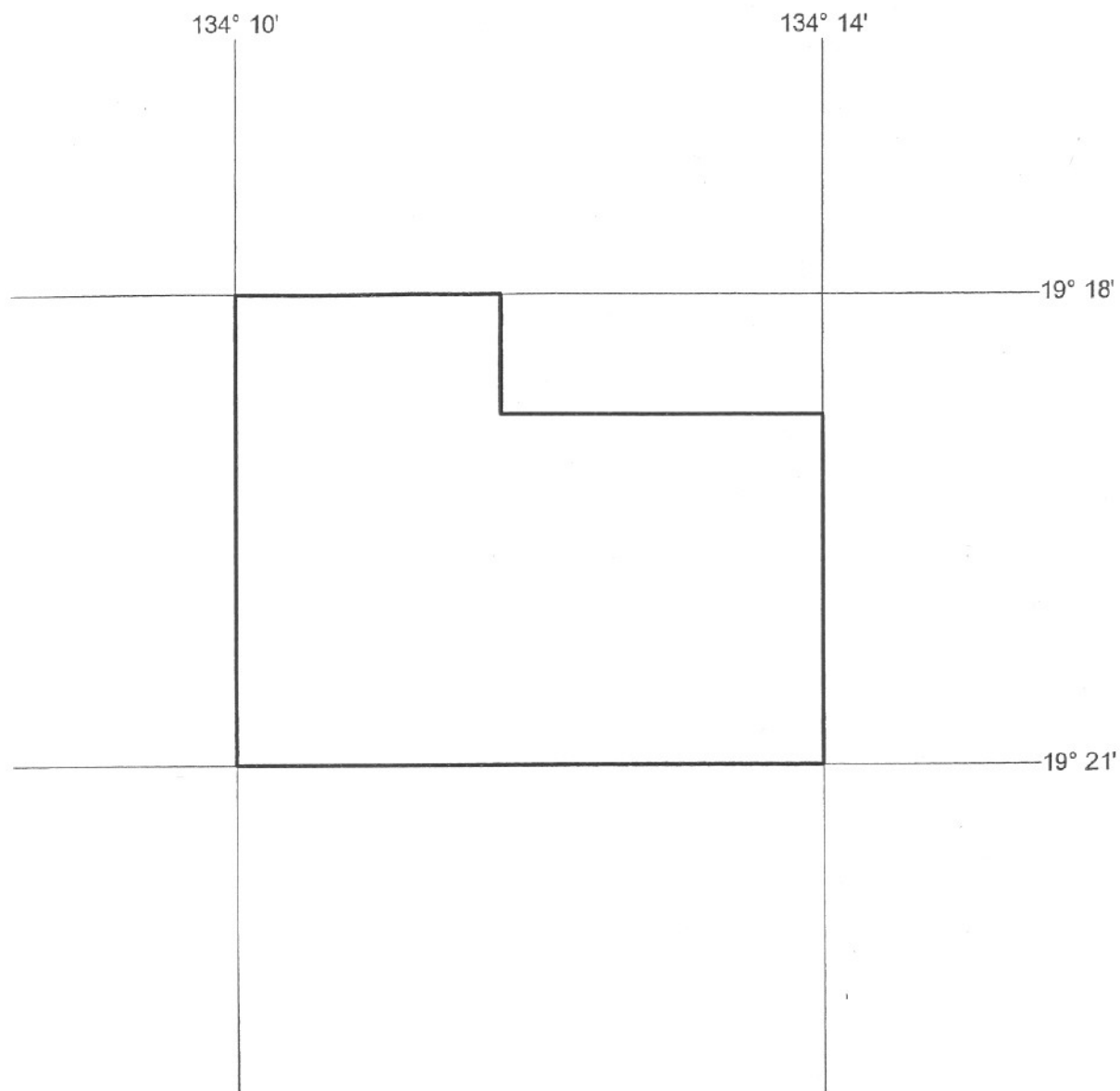

**EL 10101**  
**12 BLOCKS**  
**33.47 sq kms**

GIANTS REEF EXPLORATION PTY LTD			
TENNANT CREEK NORTHERN TERRITORY			
AREA	EL 10101 <i>Binary</i>		
MAP REF.	5759 FLYNN 1:100 000		
SUBJECT	Year 2 Licence Area <i>Extract DME SECOND SCHEDULE</i>		
DATE	AUTHOR	SCALE	
SEPT 2001	DBIRD		<b>FIGURE 3</b>

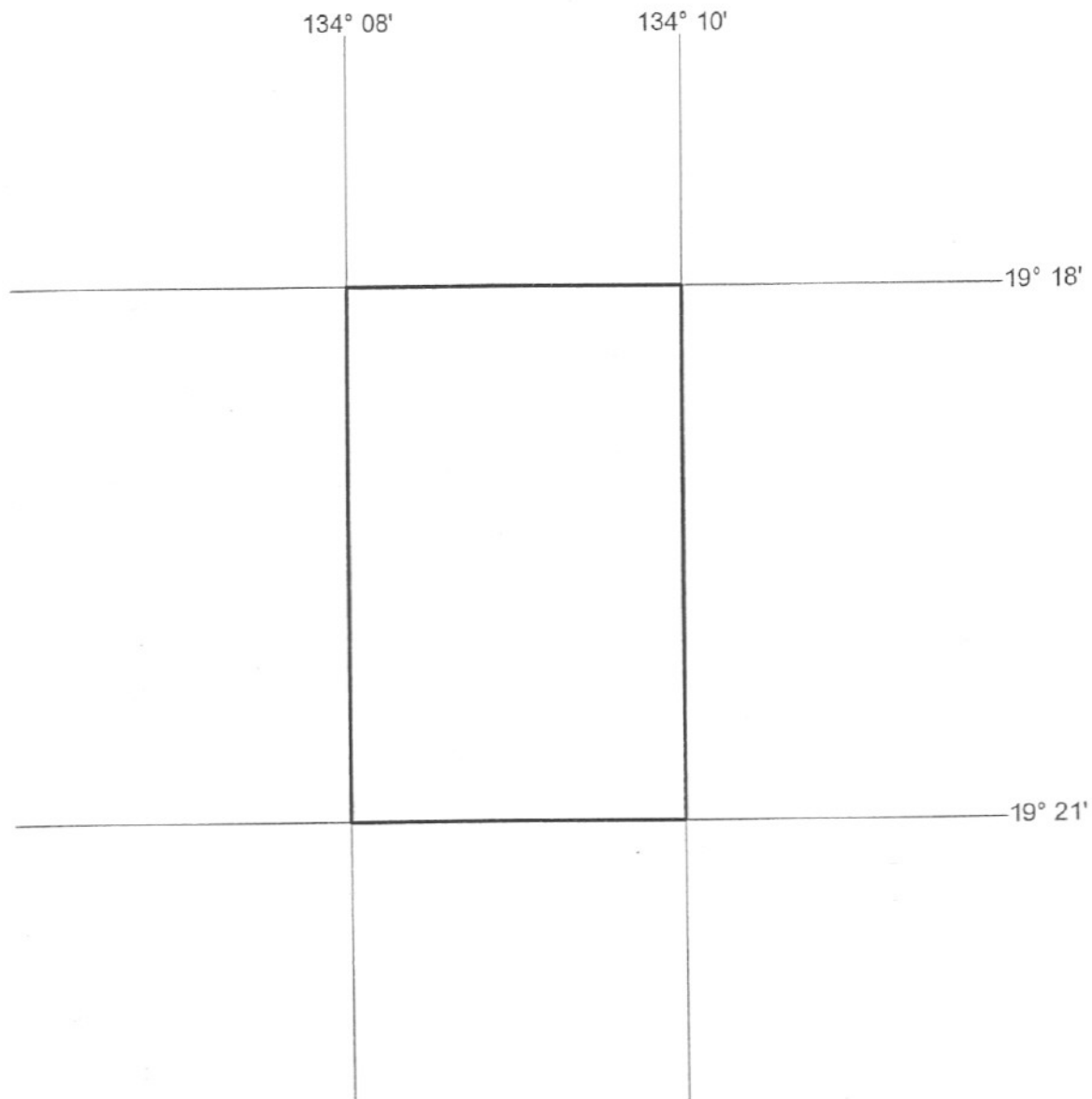

**EL 22165**  
**6 BLOCKS**  
**19.45 sq kms**

GIANTS REEF EXPLORATION PTY LTD			
TENNANT CREEK NORTHERN TERRITORY			
AREA	EL 22165 <i>Copernicus</i>		
MAP REF.	5759 FLYNN 1:100 000		
SUBJECT	Year 2 Licence Area <i>Extract DME SECOND SCHEDULE</i>		
DATE	AUTHOR	SCALE	
SEPT 2001	DBIRD		<b>FIGURE 4</b>

**EL 22583**  
**19 BLOCKS**  
**61.57 sq kms**

GIANTS REEF EXPLORATION PTY LTD			
TENNANT CREEK NORTHERN TERRITORY			
AREA	EL 22583 <i>Morning Star</i>		
MAP REF.	5759 FLYNN 1:100 000		
SUBJECT	Year 2 Licence Area <i>Extract DME SECOND SCHEDULE</i>		
DATE	AUTHOR	SCALE	FIGURE 5
SEPT 2001	DBIRD		

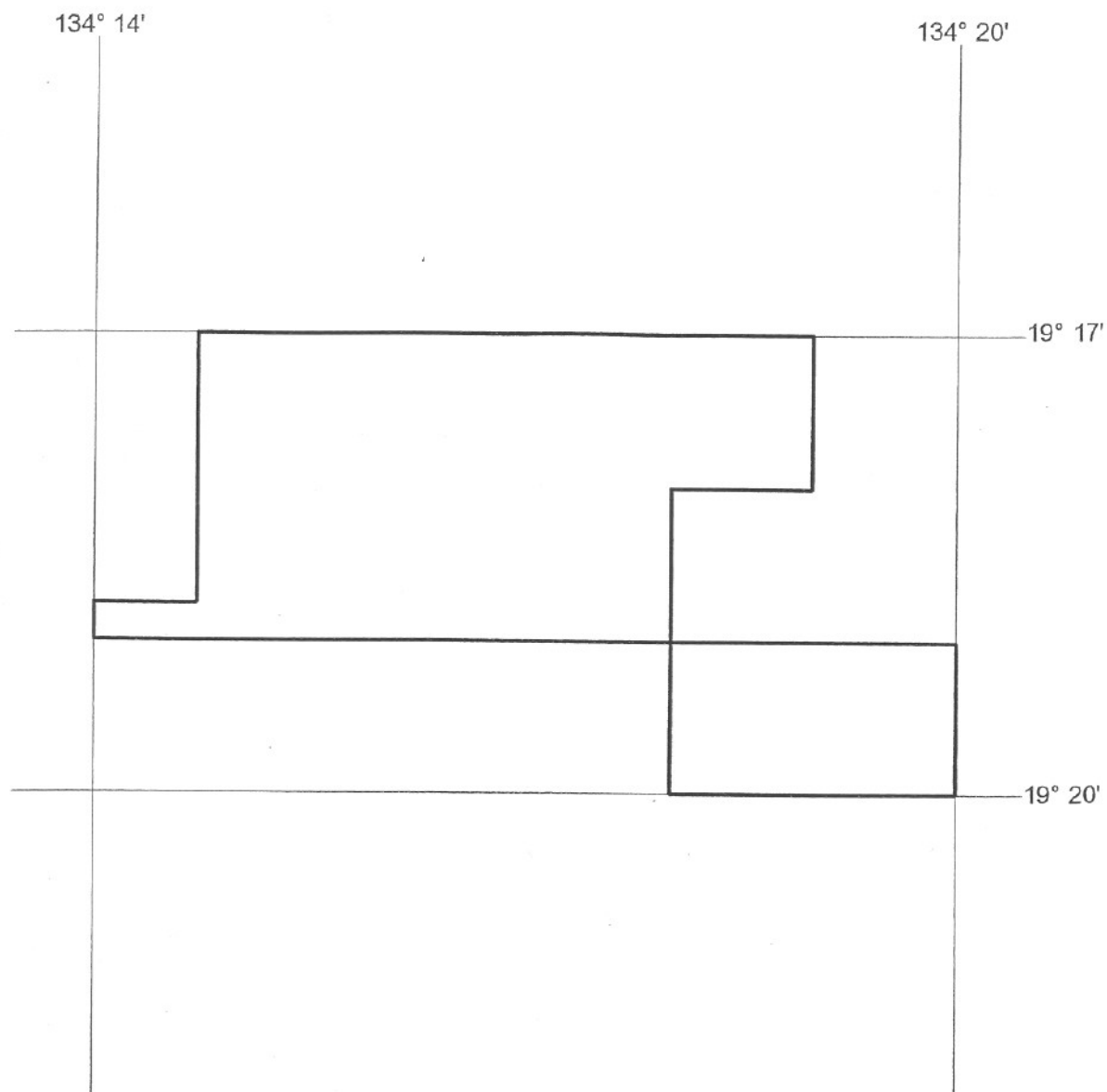

**EL 22589**  
**11 BLOCKS**  
**31.63 sq kms**

GIANTS REEF EXPLORATION PTY LTD			
TENNANT CREEK NORTHERN TERRITORY			
AREA	EL 22589 Whippet Hill		
MAP REF.	5759 FLYNN 1:100 000		
SUBJECT	Year 2 Licence Area Extract DME SECOND SCHEDULE		
DATE	AUTHOR	SCALE	
SEPT 2001	DBIRD		<b>FIGURE 6</b>

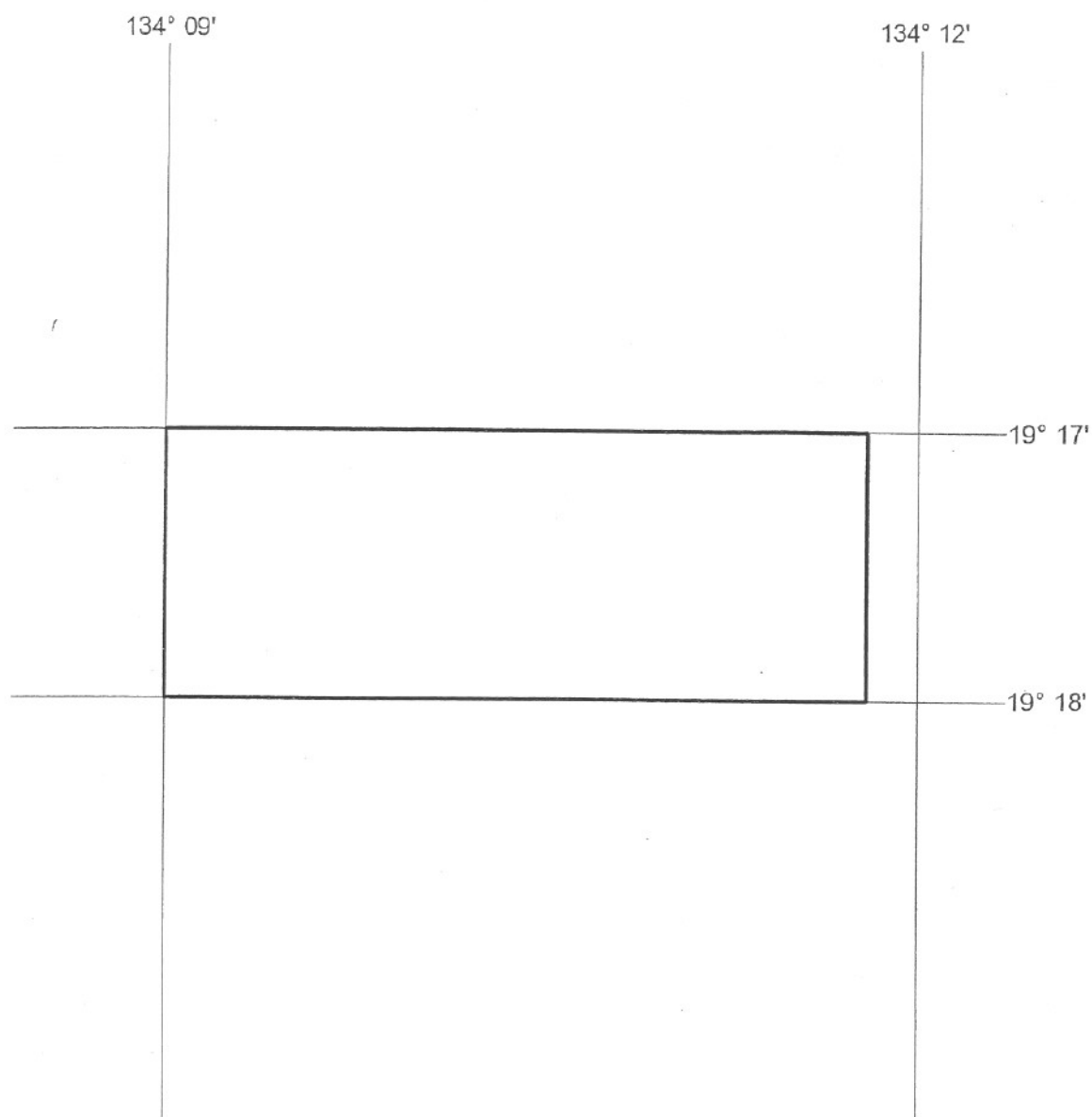

**EL 22590**  
**3 BLOCKS**  
**9.05 sq kms**

GIANTS REEF EXPLORATION PTY LTD			
TENNANT CREEK NORTHERN TERRITORY			
AREA	EL 22590 <i>Stuart Highway</i>		
MAP REF.	5759 FLYNN 1:100 000		
SUBJECT	Year 2 Licence Area <i>Extract DME SECOND SCHEDULE</i>		
DATE	AUTHOR	SCALE	
SEPT 2001	DBIRD		<b>FIGURE 7</b>



# GIANTS REEF MINING LIMITED

## ***HARD COPY REPORT META DATA FORM***

REPORT NAME:	EL 10077 <i>Whippet East</i> , EL 10101 <i>Binary</i> , EL 22165 <i>Copernicus</i> , EL 22583 <i>Morning Star</i> , EL 22589 <i>Whippet Hill</i> , EL 22590 <i>Stuart Highway</i> SECOND COMBINED ANNUAL REPORT 25 <sup>TH</sup> SEPTEMBER 2002 - 24 <sup>TH</sup> SEPTEMBER 2003
PROSPECT NAMES(s):	WHIPPET EAST, BINARY, COPERNICUS, MORNING STAR, WHIPPET HILL, STUART HIGHWAY
GROUP PROSPECT NAME:	
TENEMENT NUMBERS(s):	EL 10077, EL 10101, EL 22165, EL 22583, EL 22589, EL 22590
ANNIVERSARY DATE:	25 SEPTEMBER 2001
OWNER/JV PARTNERS:	GIANTS REEF EXPLORATION PTY LTD
AUTHOR(s):	J.L. CAHILL S.C. RUSSELL
COMMODITIES:	GOLD, COPPER
MAPS 1:250 000:	TENNANT CREEK SE53-14
MAPS 1:100 000:	FLYNN 5759
MAPS 1:25 000:	
TECTONIC UNIT(s):	TENNANT CREEK INLIER
STRATIGRAPHIC NAME(s)	WARRAMUNGA FORMATION CAMBRIAN WISO BASIN
AMF GENERAL TERMS:	
AMF TARGET MINERALS:	GOLD, COPPER, LEAD, ZINC
AMF GEOPHYSICAL:	MAGNETIC INTERPRETATION
AMF GEOCHEMICAL:	
AMF DRILL SAMPLING:	RAB DRILLING
HISTORIC MINES:	RIA'S REVENGE, MORNING STAR, QUEEN ALEXANDRIA, EDNA BERYL, GOLDEN SLIPPER
DEPOSITS:	NORTH STAR, EDNA BERYLE, WHIPPET, GECKO.
PROSPECTS:	
KEYWORDS:	WHIPPET EAST, BINARY, COPERNICUS, MORNING STAR, WHIPPET HILL, STUART HIGHWAY