

BARRICK GOLD OF AUSTRALIA LIMITED

ABN 19 008 143 137

TANAMI DISTRICT EXPLORATION

8440 – Tanami (NT) JV

BIRRINDUDU PROJECT

EL 5889 – Birrindudu

PARTIAL RELINQUISHMENT REPORT

VERIFICATION REPORT

TECHNICAL REPORT No. 1173

DISTRIBUTION:

1. BGAL – Perth 8440.333
2. BGAL – Archive 8440.333
3. Tanami Gold NL - Perth
4. Central Land Council – Alice Springs
5. NT DBIRD - Darwin

Graeme Purcell

November 2005

This Report, including all text, plans designs and photographs, is the subject of copyright and is also confidential. Save as permitted by the Copyright Act 1968, no part of the report or its contents may be reproduced, copied, used or disclosed, other than in accordance with Regulation 96 of the Mining Act without prior written permission of Barrick Gold of Australia Limited

SUMMARY

This report details the exploration activities conducted within the relinquished portion of the Birrindudu JV project, from 22 August 2002 to 21 August 2005. The Birrindudu Project comprises Exploration Licence (EL) 5889 and forms part of the Tanami (NT) JV, a Joint Venture agreement between Tanami Gold NL (TGNL) and Barrick Gold of Australia Limited (BGAL). The tenements were granted during 2002 for a period of six years.

The exploration work during this period was conducted by Barrick Gold of Australia Limited and consisted of an Aboriginal heritage survey, aeromagnetic survey, surface geochemical sampling and drilling (Vacuum, Aircore). These activities are summarised in Table 1 and illustrated in Figure 1.

BARRICK GOLD OF AUSTRALIA LIMITED

ACTIVITY SUMMARY TABLE

Project: TANAMI (NT) JV BIRRINDUDU PROJECT 8440

Tenements	Drilling					Surface Sampling				Mapping Type & Scale			Geophysics	Compilation Work		
Tenement Group Totals		DDH	RC	VAC	AC	No.	Lag	BLEG	Rock Chip	Geology	Regolith	Structure	Type	Data Reviews		
	Holes			22	12		44	33	27						Open File	Annual Report
	Metres			214	753		Ag, Al, As, Au, B, Ba, Be, Bi, Ca, Cd, Ce, Co, Cr, Cu, Fe, Ga, Hf, Hg, K, La, Mg, Mn, Mo, Na, Nb, Ni, P, Pb, Pd, Pt, S, Sb, Sc, Sr, Te, Th, Ti, U, V, W, Zn, Zr	Au								
	Elements			Ag, As, Au, Ba, Be, Bi, Cd, Ce, Co, Cs, Cu, Li, Mo, Ni, Pb, Pd, Pt, Sb, Sc, Se, Sn, Sr, Ta, Te, Th, Ti, U, V, W, Zn, Zr	Ag, As, Au, Ba, Be, Bi, Cd, Ce, Co, Cs, Cu, Li, Mo, Ni, Pb, Pd, Pt, Sb, Sc, Se, Sn, Sr, Ta, Te, Th, Ti, U, V, W, Zn, Zr								Line KM	Interpretation		
Tenement No. EL 5889 		DDH	RC	VAC	AC	No.	Lag	BLEG	Rock Chip	Geology	Regolith	Structure	Type	Data Reviews		
	Holes			See Above	See Above		See Above								Open File	Annual Report
	Metres															
	Elements														Line KM	Interpretation

7 950 000 mN

Birrindudu

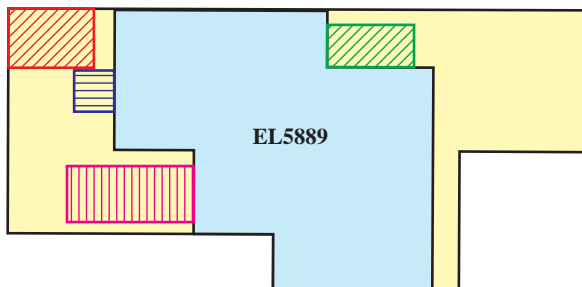

7 900 000 mN

TANAMI

DESERT

7 850 000 mN

Supplejack Downs
Station

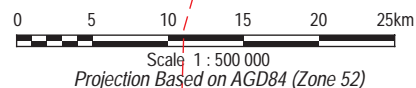

Locality Map



Legend

- Tenements Retained
- Tenements Relinquished
- Area of AC drilling
- Area of VAC drilling
- Area of LAG sampling
- Area of Rockchip sampling



BARRICK
AUSTRALIA

**BIRRINDUDU
EXPLORATION INDEX MAP**

Project: **8440 - TANAMI (NT) JV**

Originator: G.P.	Date Drawn: Feb 2004	Scale	Technical Report No.
Drawn By: D.F.B.	Revised:	1 : 500 000	1173

Ref : FILE: I:\Drafting\Tanami\Taten022.dgn
DATE: 24-Feb-05 10:38

Figure No.: 1

TEMPLATE 7 - VERIFICATION LISTING FORM

Exploration Work Type	File Name	Format
Office Studies		
Literature search		
Database compilation		
Computer modelling		
Reprocessing of data		
Report	TR1173_PR_2005.	PDF
Airborne Exploration Surveys		
Aeromagnetics		
Radiometrics		
Electromagnetics		
Gravity		
Digital terrain modelling		
Other (specify)		
Remote Sensing		
Aerial photography		
LANDSAT		
SPOT		
MSS		
Radar		
Other (specify)		
Ground Exploration Surveys		
Geological Mapping		
Regional		
Reconnaissance		
Prospect		
Underground		
Costean		
Ground geophysics		
Radiometrics	TR1173_Appendix2 (on CD)	
Magnetics	TR1173_Appendix2 (on CD)	
Gravity		
Digital terrain modelling	TR1173_Appendix2 (on CD)	
Electromagnetics		
SP/AP/EP		
IP		
AMT		
Resistivity		
Complex resistivity		
Seismic reflection		
Seismic refraction		
Well logging		
Geophysical interpretation		
Other (specify)		
Geochemical Surveying		
Surface Geochemistry	Tr1173geochem	WA SG2
Stream sediment		
Soil		
Rock chip		
Laterite		
Water		
Biogeochemistry		
Isotope		
Whole rock		
Mineral analysis		
Other (specify)		
Drilling		
Data Dictionary	Data Libraries_Acquire.mdb	
Collar	Tr1173coll.txt	WA SL2
Assay	Tr1173ass.txt	WA DG2
Survey	Tr1173surv.txt	WA DS2
Lithology	Tr1173litho.txt	WA DL1
Events	Tr1173event.txt	WA DL1
Recovery		
Magnetic Susceptibility	Tr1173mag.txt	WA DL1
Quartz		
Water		
Translation	L_Translat_Acquire.txt	
Alteration		
Vein		
Structure		
Drill	Tr1173drill.txt	WA DL1