

ANNUAL REPORT.

Year 1

EXPLORATION LICENCE 5089

1 BLOCK

VICINITY OF COPPERFIELD AND PLAYFORD CREEK
PINE CREEK AREA.

A. J. QUEST.

OPEN FILE

CR 88 / 275

Copy

14.6

E. L. 5089

A. J. QUEST,
Box 21, Pine Creek N.T.
Ph. 761345.

26th January, 1988.

The Principal Registrar,
Department of Mines and Energy
P.O. Box 2901,
Darwin, N.T. 5794.

Handwritten:
RL 10/2/88
10/5/88

Dear Sir,

RE:- exploration and Expenditure
outline and proposed Expenditure and Exploration
program for year 2, E.L. 5089, 1 Block.

Exploration and Expenditure year 1.

- | | |
|--|------------------|
| 1. Roads and crossings across
Playford and Copperfield Creeks,
Access Road from Highway. | \$2000.00 |
| 2. Stream sampling/panning off | 3000.00 |
| 3. Chip sampling of quartz veins. | <u>300.00</u> |
| | <u>\$5300.00</u> |

Year 2 E.L. 5089 will be explored in conjunction with E.L.
4701.

1. More roads and Auger sampling.
2. Ground Magnetic Survey.

At least \$5000 to be sent by myself and Mr. Bruce Hyman of
PEEL Investments.

Yours faithfully,

A J Quest

A. J. QUEST.

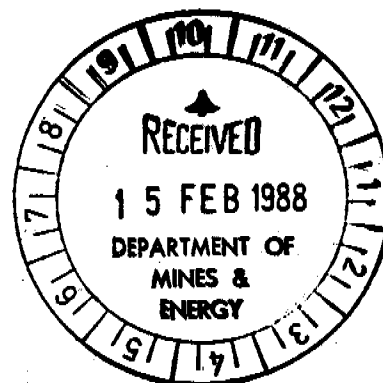

C O N T E N T S

INTRODUCTION

Location and Access

GEOLOGY

Exploration Completed

SUMMARY OF RESULTS

Conclusions

EXPENDITURE

Maps

ASSAYS

I N T R O D U C T I O N

EL 5089 was granted on the 28th January, 1987 for a period of three years. The Exploration Licence is six kilometres south of Pine Creek on the Stuart Highway, then east 6 km along Wallaroo Road, then 2 km East on track.

No comprehensive exploration programme has previously been carried out on the permit. There is no evidence of prospecting or mining.

During 1987-88 an exploration programme consisting of the following was carried out:

- (a) Costeaining
- (b) Chip sampling
- (c) Stream sediment sampling

During the year access roads were upgraded and constructed to enable much easier access throughout the Licence area.

Location and Access

Vehicular access with the EL is poor, there being only one track which extends for 6 kilometres into the western part of the area.

The topography is gently undulating and relief rarely exceeds 10m, apart from the south western corner where it is around 40 m. There has been no clearing and most of the area is covered with savannah woodland vegetation.

GEOLOGY

The area covers rocks of the Burrell Creek Formation 10 km South West of the Pine Creek Shear Zone. The south western tip of the permit extends onto the Cullen Batholith.

Outcrop on the area is generally poor but the few exposures examined would suggest that the rocks are generally steeply dipping in a complex, tight fold pattern. The principal strike direction appears to be north-north westerly although there is evidence of shear zones trending in a north easterly direction which also have small associated drag folds.

Tin ~~and~~ mineralised zones occur in part of the EL, in traces in stream sampling. Shear quartz veins showed no Gold.

EXPLORATION COMPLETED

Stream sampling/ panning off

Chip sampling

Costeaning

SUMMARY OF RESULTS

The EL 5089 has no Assays so far that indicate there could be Gold. The area requires more roads done by a grader, as the cost of stacked tyres was too great, e.g. 3 stacked tyres in 3 days. I have had 3 phase 240 volt power connected to the camp to save using generators, and the phone connected, together with access roads to make exploration in the wet easier.

CONCLUSIONS

On the EL 5089 there is ^{No} paying mineral, only a trace of Tin.

EXPENDITURE

	\$
Assays and Chip sampling	300.00
Vehicle and Grader	2000.00
Equipment Hire	
(a) Grader	
(b) Excavator	
(c) Traxcavator	
(d) Backhoe	
Labour (Sampling, stream sampling)	
Accommodation, Mess Supplies,	
Materials (stakes, flagging etc.)	
& Overheads.	<u>3000.00</u>
	<u>5300.00</u>

MAPS 2

ASSAYS 12

E. L. 5089

A. J. QUEST.

A. A. LABS
PINE CREEK

ASSAYS

	Au	Ag
P.C. 07838	.01	<1
P.C. 07273	.01	<1
	.03	<1
P.C. 06795	.01	<1
P.C. 01801	.02	
	.01	
P.C. 01731	.01	
Amdel S2	.01	
S3	<.01	
S4	<.01	
S5	<.01	

Map 1

E.L. 5088

Tracks

1 Block

Made by Grader,
trackavator, and 4x6
with grader device
Behind it.

3 sq km

A.J. QUEST

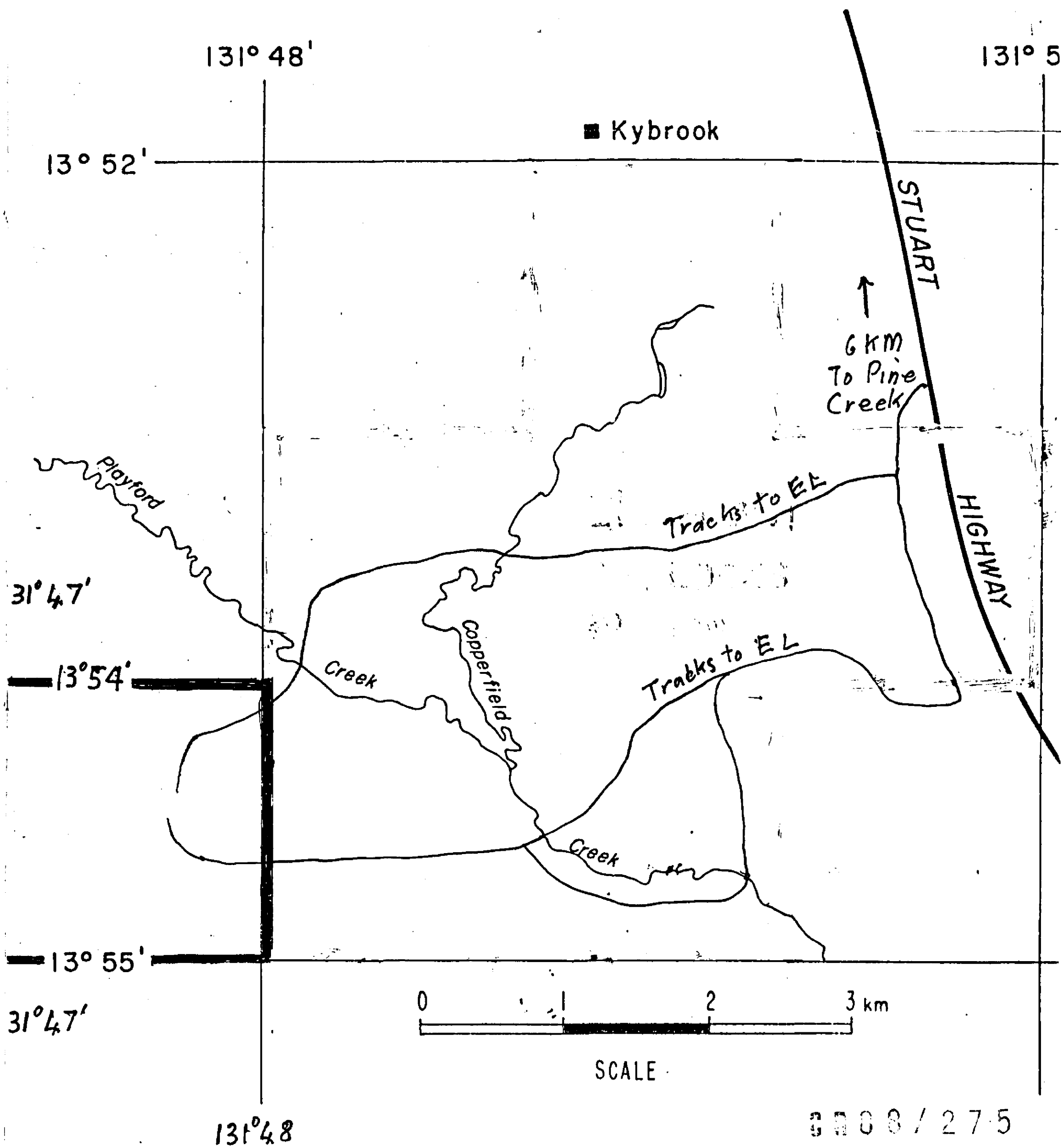

5088 / 275

POLICY

RESERVE

EL 5285

EL 5089

EL 4901

EL 4969

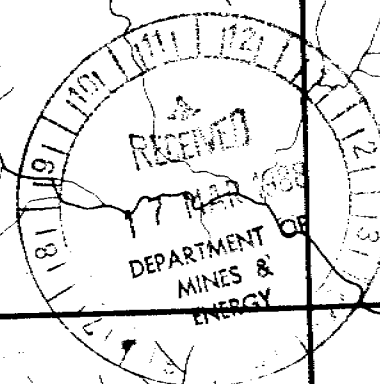

MCN 435

average height of vegetation 5 metres

MCN 1839	MCN 1803	MCN 1804	MCN 1805	MCN 1806	MCN 1800	MCN 1801	MCN 1802	MCN 1844	MCN 2045	MCN 2047
MCN 1840	MCN 1807	MCN 1808	MCN 1809	MCN 1810	MCN 16	MCN 1779	MCN 1053	MCN 1838		
MCN 1841	MCN 1811	MCN 1812	MCN 1813	MCN 1814	MCN 18	MCN 19	MCN 1754	MCN 1836		
MCN 1842	MCN 1815	MCN 1816	MCN 1817	MCN 1818	MCN 1819	MCN 1820	MCN 1821	MCN 1822	MCN 1833	MCN 1834
	MCN 2025	MCN 2027	MCN 2028	MCN 2029						

MLN 975

MCN 1088

MCN 889

MLN 58

EMP 377

MLN 549

1089

AUSTRALIA

RAILWAY

HIGHWAY

Gauge 1100m

EL 50

White Pegs Red tape

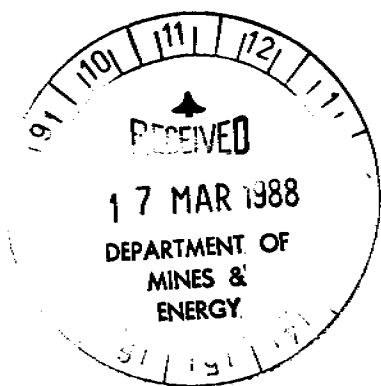
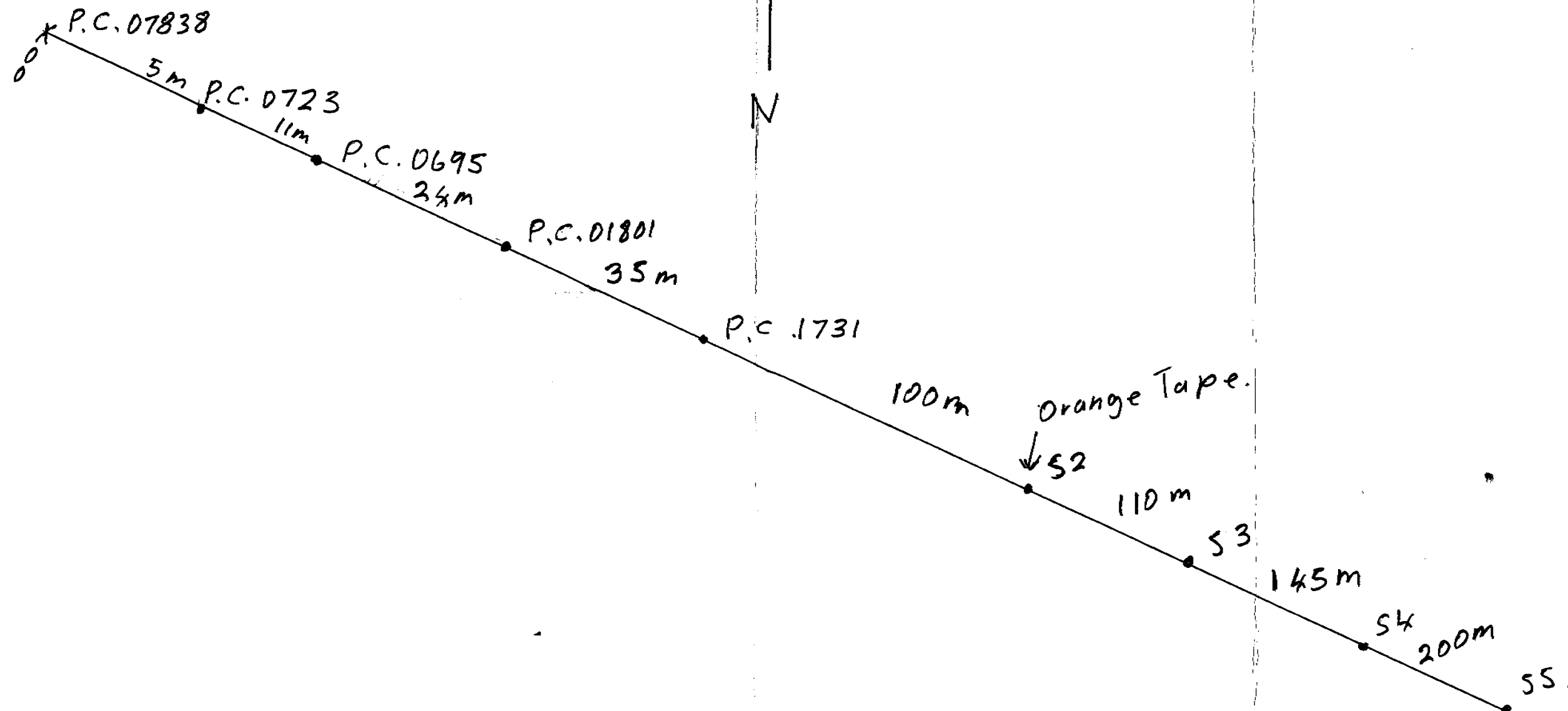

Top of Highest hill in EL 5089