

OPEN FILE

CARPENTARIA EXPLORATION COMPANY PTY. LTD.

YEURALBA PROJECT N.T.

SUMMARY OF TOTAL EXPENDITURES

<u>TENEMENT</u>	<u>NAME</u>	<u>FINAL EXPENDITURE</u>
		\$
E.L. 221) E.L.A. 3130A)	YEURALBA NO. 1	19 716
E.L. 2342	YEURALBA NO. 2	32 898
E.L. 2343) E.L.A. 3131A)	YEURALBA NO. 3	12 338
E.L. 2344	YEURALBA NO. 4	9 543
E.L.A. 2596A	YEURALBA EAST NO. 1	(WITHDRAWN)
E.L. 2595	YEURALBA EAST NO. 2	3 801
E.L. 2594	YEURALBA EAST NO. 3	9 102
E.L. 1224	HELD BY EURLBA MINING LIMITED	24 048
E.L. 2636	HELD BY EURLBA MINING LIMITED	11 725
VARIOUS ML's AND MC's	HELD BY EURLBA MINING LIMITED	84 227
	TOTAL PROJECT	207 398

knotted

DME LIBRARY

21 FEB 1996

SCANNED

CR 82/315

CARPENTARIA EXPLORATION COMPANY PTY. LTD.

EXPLORATION LICENCE NO. 2594 "YEURALBA EAST" NO. 3

FINAL REPORT AND REPORT FOR QUARTER ENDED JUNE 2, 1982

1. TENURE

Exploration Licence No. 2594 was granted for a period of 12 months from March 3, 1982.

2. LOCATION

The Licence is located on the eastern side of the Yeuralba Mineral Field approximately 60 km north-east of Katherine. The location of the Licence is shown on the attached map.

3. DISCUSSION

The geology of the Yeuralba area comprises Lower Proterozoic Burrell Creek Formation - sheared and folded sediments - which have been intruded by the Yeuralba Granite. The greisenised margin of the granite hosts quartz wolframite veins, while tin is present in quartz-tourmaline veins in the granite proper.

Carpentaria Exploration Company Pty. Ltd. undertook, as part of an option agreement with Euralba Mining Limited (formerly Secured Loans and Development), to conduct exploration in the area from early 1980. Early stream sediments and soil sampling showed encouraging results, and E.L. 2594 was applied for in the name of Carpentaria Exploration Company Pty. Ltd. to protect possible eastern extensions of any mineralization.

Subsequently, a substantial delay in processing and eventual granting of the Licence occurred, which, it is understood, was due to a conflicting Aboriginal Land Claim.

DISCUSSION (CONT.)

During this time exploration continued in the adjoining E.L.'s 2211, 1224, 2636 and 2343, and in a number of Mineral Leases and Mineral Claims within these areas. This work consisted of geological mapping and reconnaissance, soil and stream sediment surveys, in excess of 1000 m of diamond drilling, and an airborne magnetic survey.

By the time E.L. 2594 became available for granting, results of exploration in adjacent areas indicated that there was a very low probability of discovering economic mineralization in the area, and the option agreement with Euralba Mining Limited was terminated early in 1982.

Accordingly, a surrender application for E.L. 2594 was lodged with the Department of Mines and Energy in August, 1982.



for P.J. Barrett
Senior Geologist

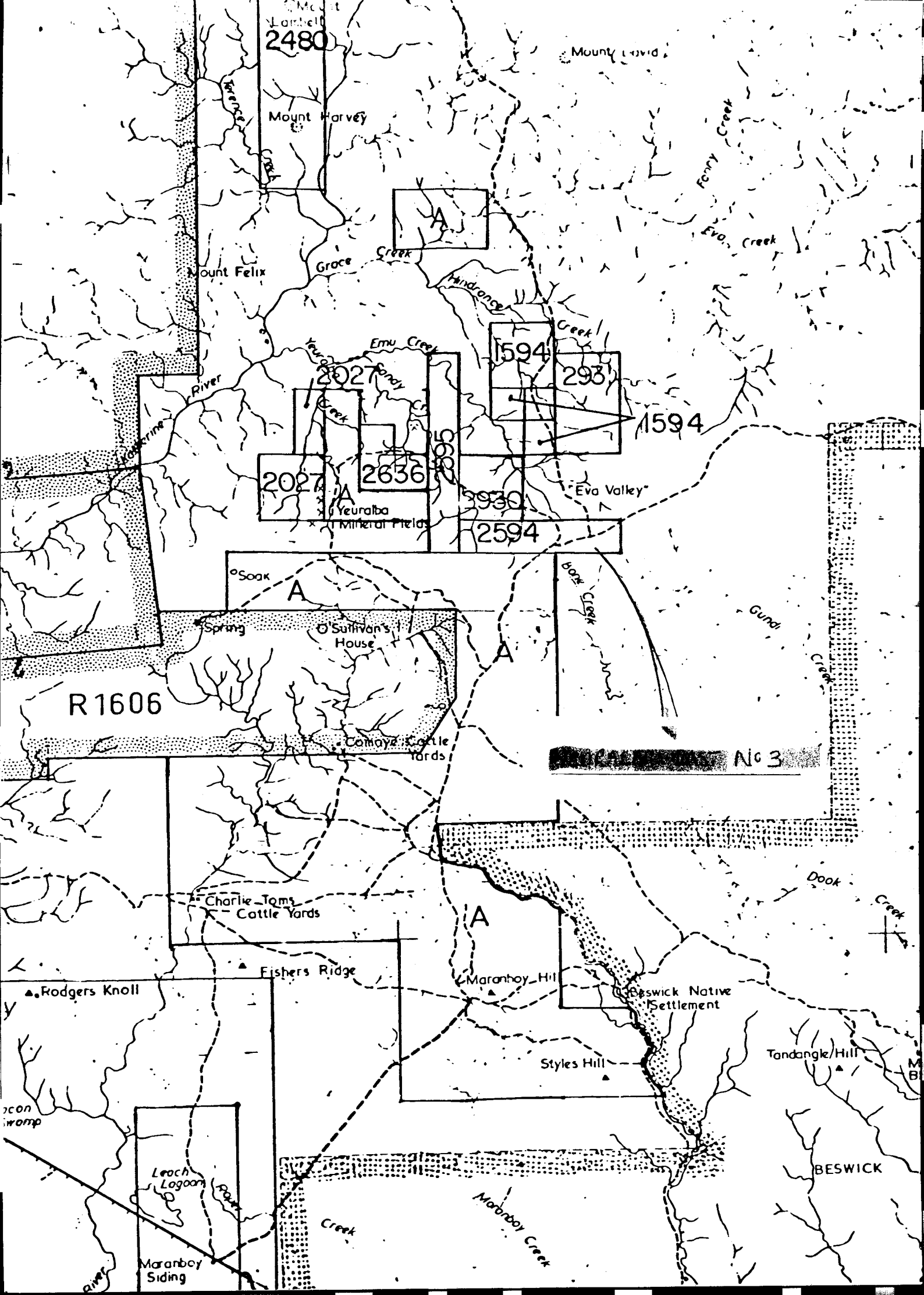

CARPENTARIA EXPLORATION COMPANY PTY. LTD.

EXPLORATION LICENCE NO. 2594 - "YEURALBA EAST" NO. 3

FINAL STATEMENT OF EXPENDITURE

	\$	\$
Administration	170	
Assaying	1171	
Aerial Surveys	7659	
Operating Labour	102	
	<hr/>	
<u>TOTAL</u>		<u>9102</u>
		<hr/>

.....
R.E. Darlington
Administration Manager