

ZAPOPAN N.L.

EXPLORATION LICENCE 5418

TANAMI REGION

NORTHERN TERRITORY

**FIRST RELINQUISHMENT REPORT
1992**

TANAMI 1:250,000 SHEET SE 52-15
THE GRANITES 1:250,000 SHEET SF 52-3
MT SOLITAIRE 1:250,000 SHEET SF 52-4

Date: August, 1992
Our Ref: 92.569-RM:AH

CR 9 2 / 5 2 0

TABLE OF CONTENTS

	<u>Page No.</u>
1. SUMMARY AND CONCLUSIONS	1
2. INTRODUCTION	1
3. GEOLOGY	1
4. EXPLORATION COMPLETED	2

FIGURES

- Figure 1. EL 5418 - Blocks Relinquished 1:250,000 Scale
- Figure 2. Sample Locations

APPENDICES

- Appendix I. Sample Descriptions
- Appendix II. Sample Results

1. SUMMARY AND CONCLUSIONS

This report is submitted as a requirement of the statutory relinquishment of 247 blocks out of Exploration Licence 5418 and summarises work carried out on the relinquished areas. This has consisted of literature searches, aerial photography acquisition, open file airborne magnetic data acquisition and subsequent image processing and interpretation and the collection of seven (7) samples from a dipole anomaly.

The results of the work in the relinquished areas did not warrant any further work being undertaken.

2. INTRODUCTION

Exploration Licence 5418 was granted on 3 May, 1989 to Harlock Pty Ltd. A 50% interest was subsequently transferred to Zapopan NL. Harlock's interest was held in trust on behalf of Kumagai Gumi Co Ltd (30%) and Kintaro Metals Pty Ltd (20%). Zapopan, Kumagai and Kintaro comprised the Tanami Joint Venture (TJV). Zapopan acquired the remaining 50% of the Tanami Joint Venture in September, 1991 and EL 5418 was transferred totally to Zapopan on 28th November, 1991.

The EL covered an area of 1,594 km², equivalent to 495 blocks, and is located 40 km - 80 km east of Rabbit Flat and 20 km - 70 km NNE of The Granites Gold Mine.

There are no access roads into the area, the nearest access being the roads from The Granites to Rabbit Flat or The Granites to Mt Davidson Outstation.

The area is generally covered by sand plains, with a monotonous cover of spinifex and small shrubs, with a few low rises and pediments covered by iron rich rubble and weathered rock. Red earth plains comprising recent alluvial and colluvial material are often covered with thick mulga scrub. A large west trending flood out occurs to the south of the licence area and few sand dunes are present along the northern boundary.

The EL lies totally on Aboriginal land within the Central Desert Land Trust area.

A total of 247 blocks was relinquished from EL 5418 effective from 3rd May, 1992 and the attached tenement plan from the Tanami, The Granites and the Mt Solitaire 1:250,000 scale sheets shows the areas relinquished.

3. GEOLOGY

The Lower Proterozoic Mt Charles Beds (Blake et al, 1975) crop out sporadically in EL 5418 forming low rubbly mounds and ridges. This unit, where exposed, comprises ferruginous quartzite.

The majority of EL 5418 is underlain by granite from interpretation of the airborne magnetic data.

Cambrian-age dolomite crops out in the north-west corners of the Mt Solitaire Sheet and is continuous with the Montejinni Limestone and Hooker Creek Formation of the adjoining Tanami East Sheet. Sandstone and claystone of the Lothari Hill Sandstone overlie the dolomites.

A veneer of Cainozoic sediments covers most of the area and reduces outcrop to small, low areas of generally weathered rock. These sediments include areas of silcrete, ferricrete, gravel, calcrete, lacustrine clays, alluvium, colluvium and aeolian sand. The latter covers most of the EL and forms dunes to the north.

The area forms part of an old land surface in an advanced stage of planation known as the Tennant Creek surface (Hays, 1967).

The landforms in the area are typical of an arid environment with relics from a wetter tropical period.

4. EXPLORATION COMPLETED

All relevant open file, geological, geophysical and historical data for the region has been obtained. This data included the regional airborne magnetic survey compiled by the Northern Territory Geological Survey for the Ptilotus and Davidson 1:100,000 sheets. The portion of EL 5418 falling on the Tanami 1:250,000 Sheet areas was covered by an airborne magnetic survey.

Colour aerial photography at 1:50,000 scale was flown by Airesearch Mapping and these photographs were used to interpret relevant landforms, outcrop extent, drainage, lineaments, etc to assist in target selection for initial exploration sampling.

Landsat images at 1:250,000 scale and black and white NASA photography covering The Granites - Tanami region were purchased and used to assist in target selection.

During Year 2 of the licence, as part of an overall sampling programme, seven (7) samples were collected from a 4 km x 2 km diphole anomaly in the north eastern section of the relinquished areas. No anomalies were detected in the samples collected. Sample locations are shown on Figure 2 and sample descriptions and results are at Appendices I and II.

Following evaluation of the sample results no further ground work was undertaken on the relinquished areas.

FIGURE 1

EL 5418 - BLOCKS RELINQUISHED 1:250,000 SCALE

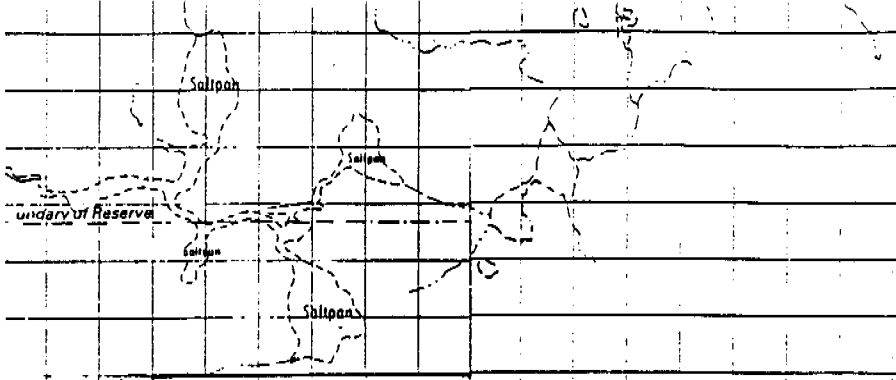

EL 5418

56/1

EL 5418

EL 5418

130°32'

170°34'

20°12'

20°24'

20°10'

20°17'

Clayton
Clayton

10°12'

10°

FIGURE 2

SAMPLE LOCATIONS

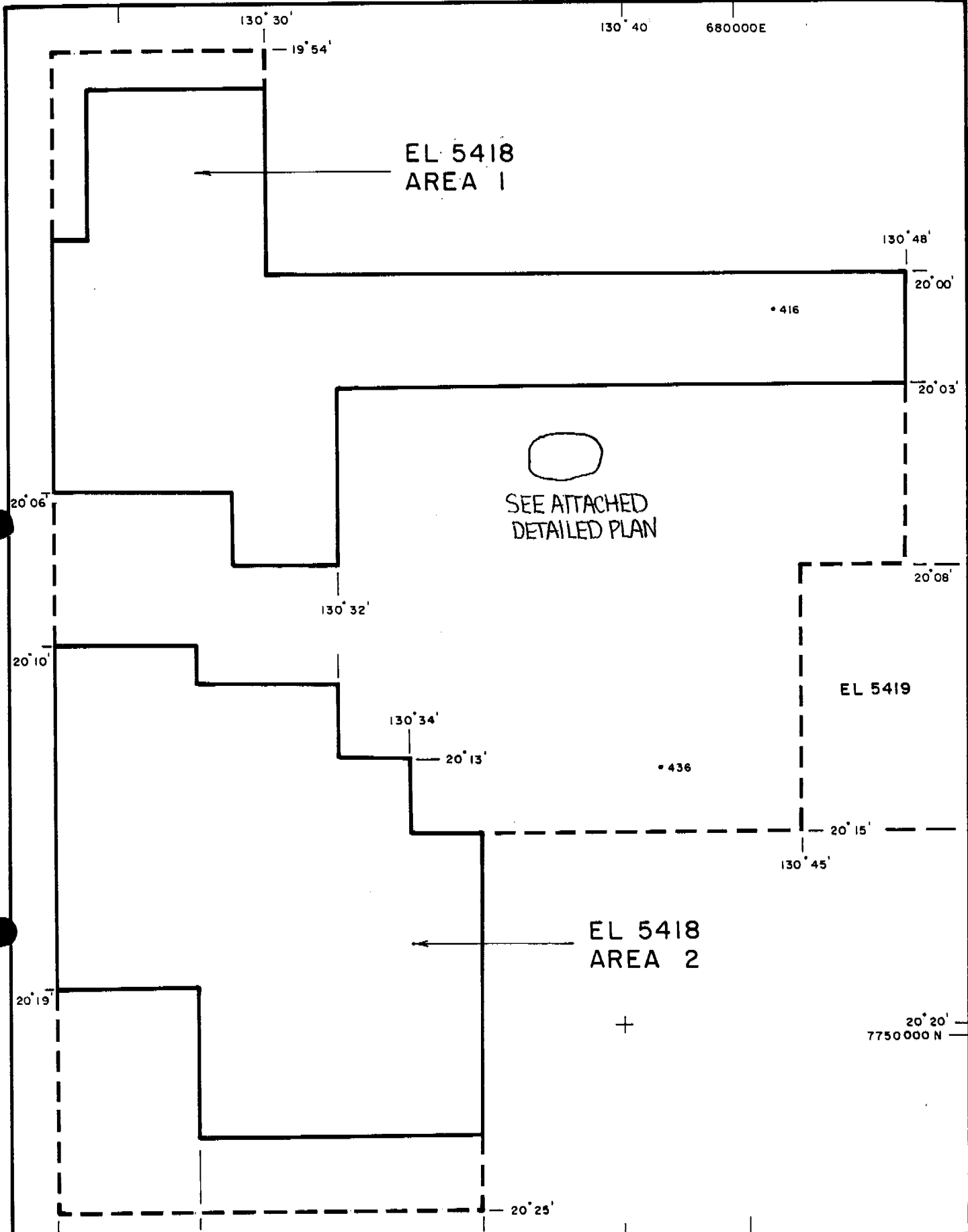

EL 5418
 248 blocks
 799 sq. km.

ZAPOPAN N.L.		
Scale: 1 : 250000	Compiled:	Date:
	Drawn:	
EXPLORATION LICENCE 5418		

650000E

779000N

778000N

777000N

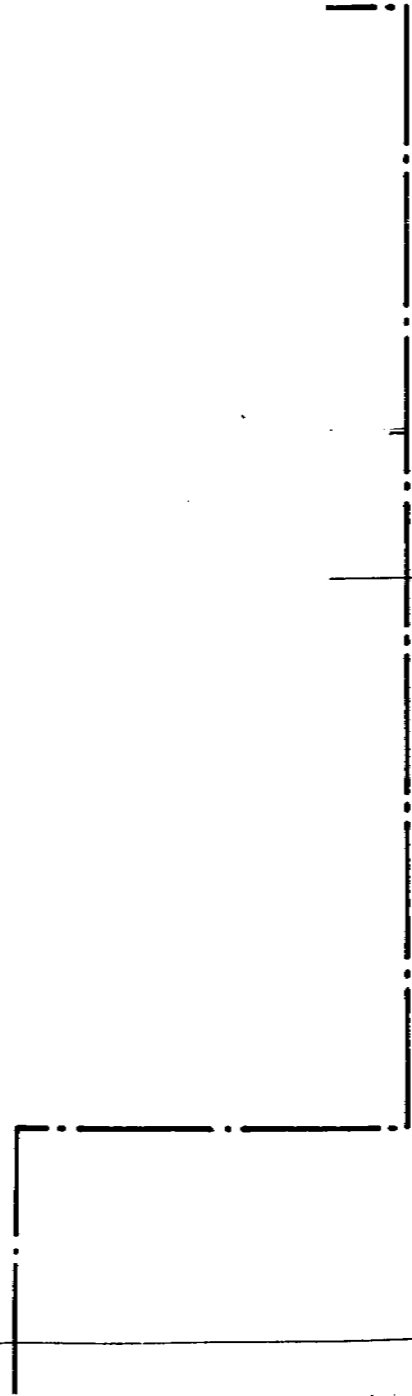
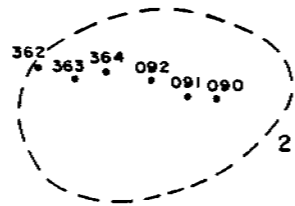

APPENDIX I

SAMPLE DESCRIPTIONS

TENEMENT NO: EL 5418

Sample Number	Type	Run No./Photo No.	Coordinates	Description	Comments
80090	LAT	13/164		coarse, some cemented	
80091	LAT	13/164		nodular lat; M-C;	small 105° quartz vein nearby
80092	LAT	13/164		M-C	
80362	LAT	14/174		M-C; good sample	
80363	LAT	14/174		M-C; good sample	
80364	LAT	14/174		M-C; "gritty"	
80365	LAT	14/174		M-C; "gritty"	

APPENDIX II

SAMPLE RESULTS

ANALABS

A Division of Inchcape Inspection and Testing Services Australia Pty. Ltd.

ANALYTICAL DATA

SAMPLE PREFIX REPORT NUMBER REPORT DATE CLIENT ORDER No. PAGE

999.16.21.04531 26/09/90 DN 50388 1 OF 8

TUBE No.	SAMPLE No.	Sc	Cr	Fe	Co	Ni	Cu	Zn	Zn	As
1										
2										
3										
4										
5										
6										
7										
8										
9										
10										
11										
12										
13										
14										
15	80090	33.5	480	34.10	6	10	12	2	<100	48
16	80091	34.1	501	36.50	7	<5	10	2	<100	32
17	80092	36.2	420	39.90	9	5	6	2	<100	19
18										
19										
20										
21										
22										
23										
24										
25										

Results in ppm unless otherwise specified
 T = element present; but concentration too low to measure
 X = element concentration is below detection limit
 - = element not determined

AUTHORISED OFFICER

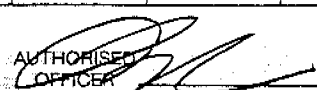

ANALABS

A Division of Inchope Inspection and Testing Services Australia Pty. Ltd.

ANALYTICAL DATA

SAMPLE PREFIX

REPORT NUMBER

REPORT DATE

CLIENT ORDER No.

PAGE

999.16.21.04531

26/09/90

DN 50388

2 OF 8

TUBE No.	SAMPLE No.	Sc	Cr	Fe	Co	Ni	Cu	Zn	Zn	As
1										
2										
3										
4										
5										
6										
7										
8										
9										
10										
11										
12										
13										
14	80362	30.1	589	41.80	5	<5	10	<2	<100	35
15	80363	38.9	756	34.20	7	20	12	<2	<100	29
16	80364	31.0	625	39.00	7	5	8	<2	<100	37
17	80365	34.2	270	36.80	4	5	12	<2	<100	16
18										
19										
20										
21										
22										
23										
24										
25										

Results in ppm unless otherwise specified
 T = element present; but concentration too low to measure
 X = element concentration is below detection limit
 - = element not determined

AUTHORIZED OFFICER

