

FIRST RELINQUISHMENT REPORT  
ON  
EXPLORATION LICENCE 2452  
ALICE SPRINGS, NORTHERN TERRITORY

Date Relinquished  
1 August, 1982

**IMAGED**

DME LIBR

- 1 FEB 1993

SCANN

AUGUST, 1982

PERTH

CR82/280

SUMMARY

EL 2452 was halved on the second anniversary date of 1 August, 1982.

Work carried out by UAL on the portion relinquished included regional mapping and the geological relogging of all holes previously drilled by AGIP.

1. INTRODUCTION

EL 2452 is the most northerly of a group of exploration licences held by Uranerz Australia Pty Ltd (UAL) in the Alice Springs area. It was granted on 1 August, 1980 with an area of 124 blocks (388.62 km<sup>2</sup>).

The tenements are worked in a joint venture partnership with Carpentaria Exploration Company (CEC); UAL being the operator, with a regional office at Alice Springs. A renewal application has been submitted for a third year of tenure, for a reduced area of 62 blocks (194.31 km<sup>2</sup>). This report details the work carried out on the relinquished portion.

2. LOCATION

EL 2452 is situated approximately southwest of Alice Springs on the HERMANNSBURG and ALICE SPRINGS 1:250,000 Sheets SF 53-13 and SF 53-14.

3. GEOLOGY

EL 2452 covers part of the Devonian sequence of sandstones that form the Undandita Member of the Pertnjara Group within the Missionary Syncline which is located along the northern margin of the Amadeus Basin.

The Undandita Member sandstone was deposited in a fluvial, braided channel environment and contains a regionally reduced tongue of sandstone over a distance of 70 km in the generally oxidized Undandita Member sandstone. The redox boundary is observed as a colour change from the red-coloured oxidized

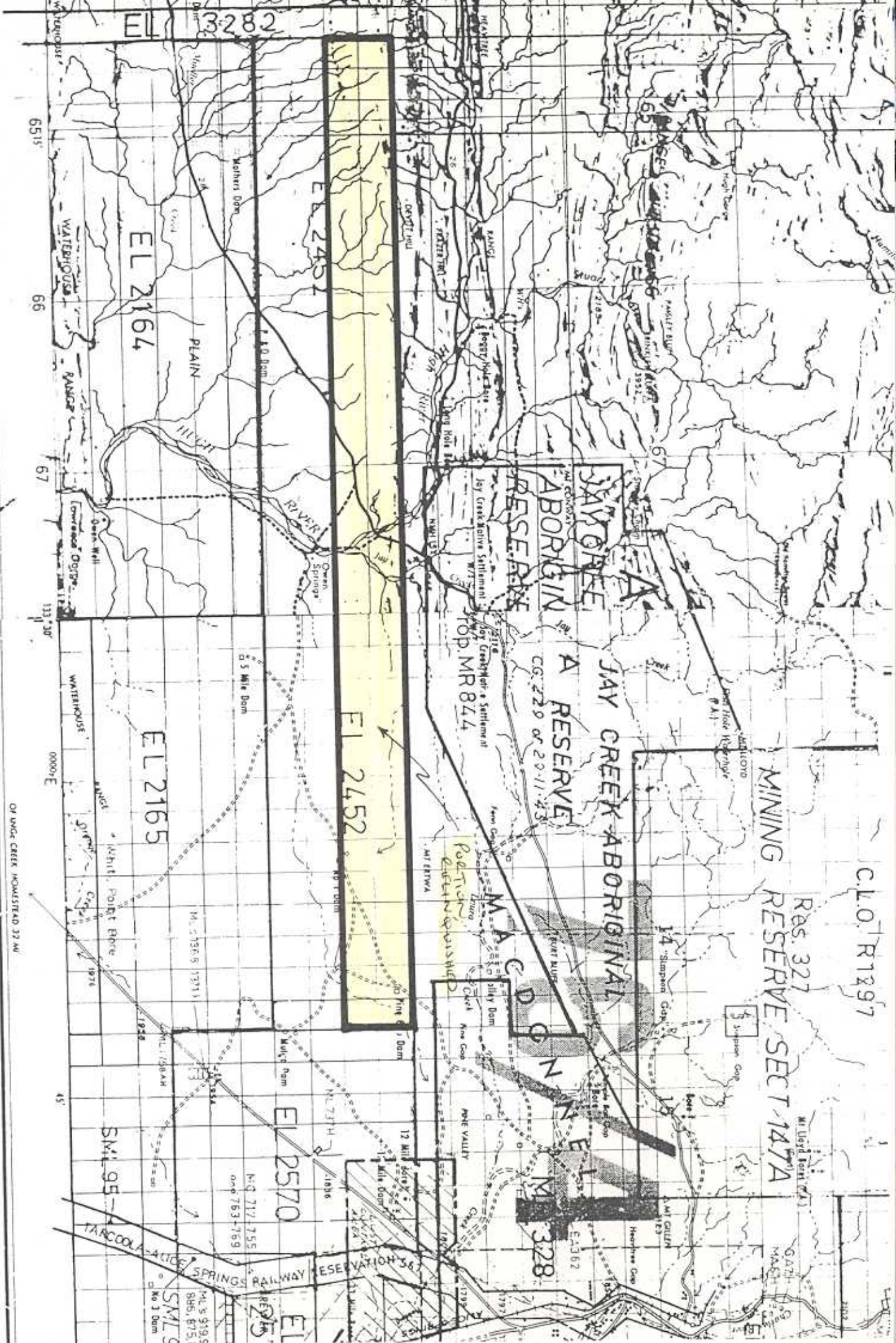

sandstone to the grey colour of the reduced sandstone.

#### 4. INVESTIGATION AND RESULTS

EL 2452 was formerly worked as EL 1415 by AGIP Nucleare Pty Ltd (AGIP), who drilled a number of diamond/percussion holes over the tenement. The lithological logs of these holes were studied and a re-interpretation carried out of the lithologies, as part of a regional sedimentological study covering all of UAL's tenements in the Alice Springs Project.

Regional mapping was the only other field activity carried out by UAL during its two years of tenure on the portion relinquished.

#### 5. TECHNICAL DETAILS

##### 5.1 Personnel

Chief Geologist -----J. Borshoff  
 Project Geologist -----K. Ferguson  
 Geologist -----B. Wygrala  
 Geologist -----I. Faris  
 Field Supervisor -----J. Wilkie

##### 5.2 Instruments

2 SRAT SPP.2 scintillometers  
 1 McPhar TV5 downhole logging unit  
 1 Sokkisha TM-20c theodolite

5.3 Vehicles

- 2 Toyota F45 four-wheel-drive
- 1 Caravan
- 1 Water Trailer