

CR 73/161

FINAL REPORT ON E.L. 104
TAYLOR WELL
BY: KEWANEE AUSTRALIA PTY LTD

KEWANEE AUSTRALIA PTY. LTD.

N.T. EXPLORATION LICENCE

FINAL REPORT

E.L. 104 TAYLOR WELL

PROJECT 16

APPENDIX I - Location Plans

CONTENT

1. General Information
2. Work Carried Out
3. Expenditure
4. Geology
5. Geochemistry
6. Maps & Plans
7. Conclusions

E.L. 104 TAYLOR WELL

Area 490 square miles. Work commitment \$20,000.
Granted to Phillip Edmond Cogár, 28th April, 1972. Converted
from A.P. 2742 of 545 square miles granted to P.E. Cogar 11th
October, 1970.

GENERAL INFORMATION

1. Location

E.L. 104, Taylor Well, is located about 220 miles by road
north-east of Alice Springs. The location is indicated in
figures 1 and 2.

2. Access and Services

The Stuart Highway runs through the north-western corner
of the E.L. The unsealed Hatches Creek road leaves the
Stuart Highway just north of Taylor Well and passes through
the northern part of the E.L. The Elkedra Homestead track
passed through the eastern margin of the E.L. Two small
tracks to Government bores run southward from the Hatches Creek
road. The nearest landing strip is at Murray Downs Homestead
with two others to the south near Home of Bullion Mine and
close to Barrow Creek township.

Warrabri Mission, with a school and a policeman is about
8 miles to the north of the E.L. The nearest township is
Barrow Creek, about 25 miles south on the Stuart Highway.

Two Government bores are on the E.L. and several are in
the general area.

WORK CARRIED OUT

Air photograph interpretation work was carried out and field
overlay sheets were prepared. Access roads were bulldozed.
Soil, stream sediment and rock chip samples were collected and
later analysed.

A geologic report was prepared.

EXPENDITURE

Costs for the 12 month period to April, 1973 were
approximately \$14,000.

GEOLOGY

Regional Geology

The B.M.R. has indicated an Archaean Basement, consisting of mica schist, gneiss and amphibolites, is overlain by Lower Proterozoic Hatches Creek Group, consisting of sandstones, siltstones greywackes, quartzites and various lavas. Relatively flat - lying Mt. Stuart Beds unconformably overlie the Lower Proterozoic and the Archaean rocks. These, in turn, are unconformably overlain by Palaeozoic sediments.

Only two small areas of Archaean Arunta Complex were recognized within the general area of E.L. 104. These were at the Ivy Mine and at the Home of Bullion Mine.

Outcrops of Lower Proterozoic Hatches Creek Group were found on this and adjacent E.L.s

Intrusive granites and dolerites have been mapped on adjacent E.L.s

Local Geology

About 80% of the area is covered by soil, wind-blown sand and sand ridges and thus prospecting operations were limited to soil, stream sediment and rock chip sampling. A 200' diameter quartz - blow adjacent to a quartz - feldspar porphyry and a green hornfels was designated Prospect A. No grids were put in.

No Archaean rocks were recognised. Several outcrops of Lower Proterozoic rocks were recognised. At the eastern end of the E.L. is a large outcrop of quartz porphyry with some shales. The shales are locally schistose in strongly folded sections. Two ridges of quartzite appear as marker beds.

The main outcrops are in the north-east corner of the E.L. to the west of the Elkedra road. There are low hills of NW - SE trending Hatches Creek Group sediments. Some quartz blows form isolated hillocks about 200' in diameter, but appearing to have no preferred orientation.

Outcrops of palaeozoic rocks were found to the west of the Hatches Creek Group rocks and to the west of Blue Bush Well. These are thought to be Tomahawk Beds comprised of red sandstones with numerous ripple marks and a variety of siltstones. Limestone crops out around Blue Bush Well and is known to be about 100' thick at the well.

Prospect A

The Prospect was sited over a 200' diameter quartz - blow near the Elkedra road. The quartz - blow and the feldspar porphyry appear to be intrusive into folded Hatches Creek sandstone. A section of the porphyry appears to be slightly mineralized. Small gossanous band or bed and some limonitic bands were found.

GEOCHEMISTRY

A total of six rock chip samples were taken from the porphyry, the quartz - blow, the gossanous band and a hornfels. All were analysed for Cu, Pb, Zn, Co, Ni, Au and W but no significant results were obtained. Two soil samples taken from a 2' and a 3' depth were analysed for Cu, Pb, Zn, Ni, Co, Au and W but no significant results were obtained.

Four stream sediment samples were taken in Prospect A and four creeks were sampled, all for copper lead and zinc. No significant values were obtained.

MAPS AND PLANS

No geologic map nor any plans were produced.

CONCLUSIONS

There is no record of any mineral occurrence within the E.L. and most of the area is covered in wind blown sand. Work done over the E.L. has not indicated any economic mineralization.

Signed on behalf of
Kewanee Australia Pty. Limited

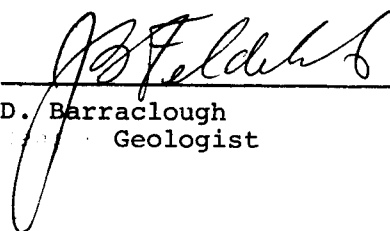
BY: 
FO D. Barraclough
Geologist

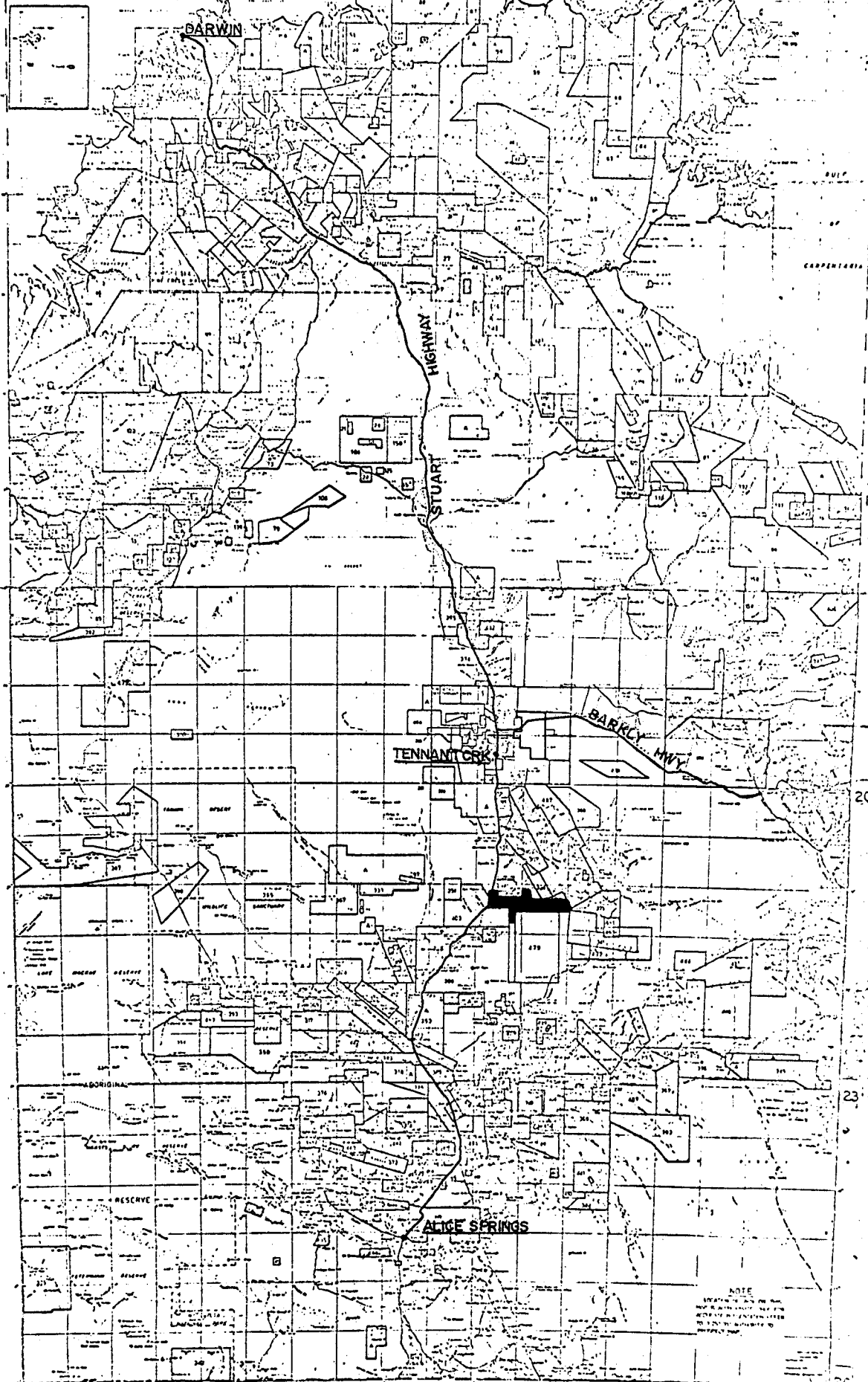

NOTE
SYMBOLS FOR THE
NEW SOUTH WALES
ROADS DEPARTMENT
ARE SHOWN IN
THIS MAP

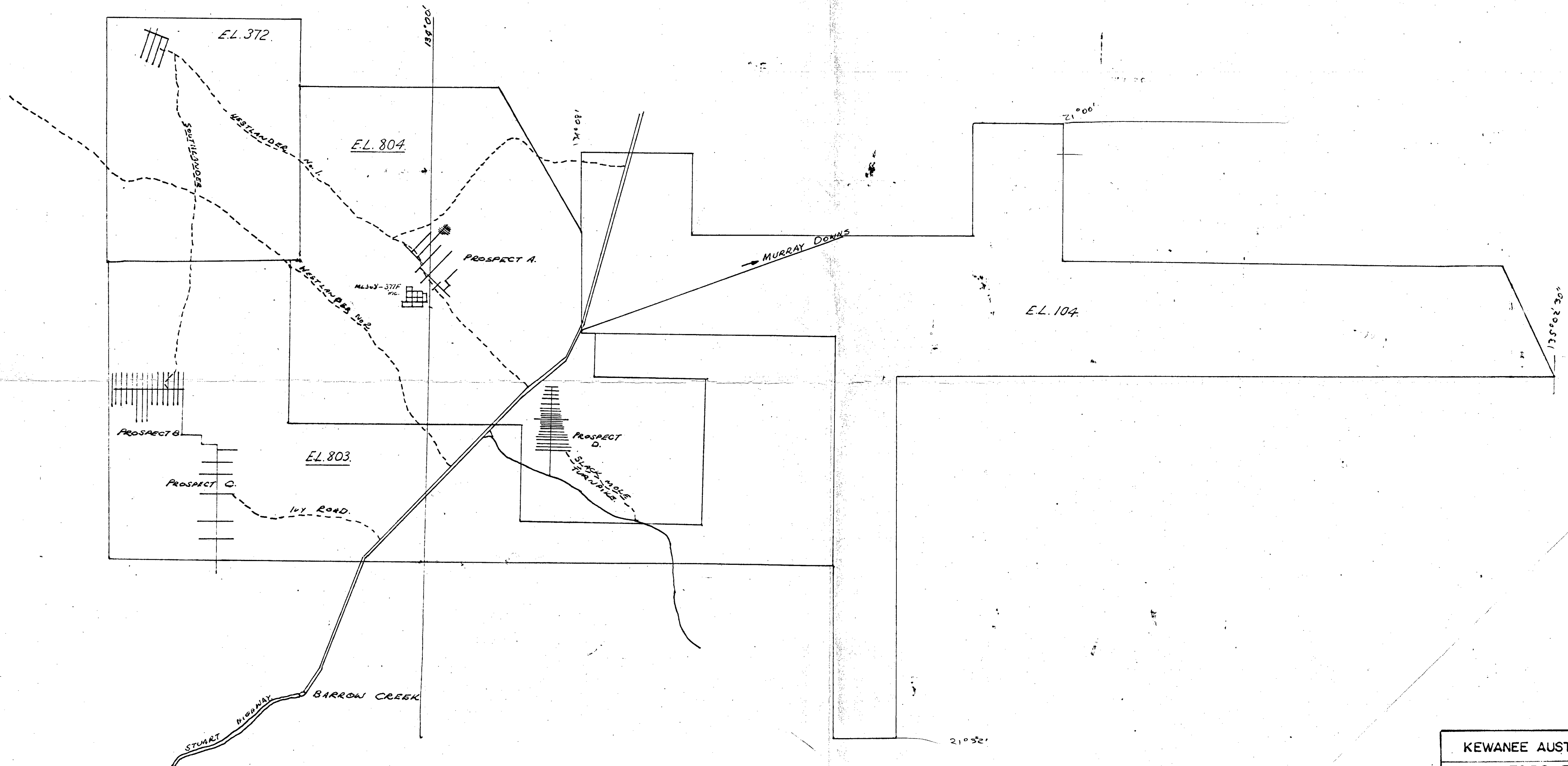

KEWANEE AUSTRALIA PTY. LTD.	
CRAWFORD RANGE AREA	
LOCATION PLAN	
PROSPECTS, ROADS, PROJECTS	
SCALE:	PROJECT: 1, 6, 16
DRAWN SALLY	PROSPECT: A, B, C, D
DATE: 16-12-71	2651
DRG. NO. 6-431D-103	