

URANERZ AUSTRALIA PTY. LTD.

INCORPORATED IN W.A.

FOR THE
URANERZ AUSTRALIA PTY LTD/CARPENTARIA EXPLORATION COMPANY
50:50 AMADEUS JOINT VENTURE

FINAL REPORT

EXPLORATION LICENCE 4506

ALICE SPRINGS

NORTHERN TERRITORY

OPEN FILE

COVERING THE PERIOD

06 NOVEMBER 1984 - 05 NOVEMBER 1990

Compiled by
K.S. TAYLOR

PERTH
NOVEMBER 1990

CR90/689

SUMMARY

EL 4506 covers the Angela deposit at Alice Springs, which is an indicated/
inferred resource of 6,000 tonnes, grading 01.-0.13% U_3O_8 .

Field exploration ceased in 1982; full details of reports covering this
work are given in the 'Final Report on part of EL's 2163, 2570 and 2571'
dated December 1983.

TABLE OF CONTENT

	<u>Page No.</u>
SUMMARY	i
LIST OF FIGURES	ii
1. INTRODUCTION	1
2. LOCATION	1
3. GEOLOGY	1
4. INVESTIGATIONS	2
STATEMENT OF EXPENDITURE	3
 <u>LIST OF FIGURES</u>	
FIGURE 1 230D78 Tenement Status	

1. INTRODUCTION

Exploration Licence 4506 covers an area of 12 blocks (38.5m²) at Alice Springs. It was granted on 06 November 1984 with an area of 24 blocks and included parts of former EL's 2163, 2570 and 2571.

The project has been worked in a joint venture partnership with Carpentaria Exploration Company (CEC) since 1977, with UAL as operator.

This report covers all work done during the tenure of EL 4506.

2. LOCATION

EL 4506 is situated approximately 25km south-southeast of Alice Springs on the ALICE SPRINGS 1:250,000 Sheet SF 53-14 and 1:100,000 Sheet 5650 (Figure 1).

3. GEOLOGY

The tenement is located in the northeastern part of the intracratonic Amadeus Basin in Central Australia covering the Missionary Syncline. The host rock of uranium mineralisation is the Undandita Member.

Sandstone which is part of the Devonian-Carboniferous Brewer Conglomerate being a molasse deposit derived from Lower Proterozoic Aurnta basement and later marine sediments along the northern margin of the Amadeus Basin during the Alice Springs Orogeny. The sediment was deposited in a braided channel, fluvial environment.

Exploration has outlined a family of spatially and genetically related ore zones - Angela I-V, 30km from Alice Springs. These are located on the upper boundary of a stratigraphically controlled wedge of reduced sediments with the generally oxidised Undandita.

23°50'

24°00'

133°40'

133°50'

134°00'



Stuart Highway

Railway Reserve

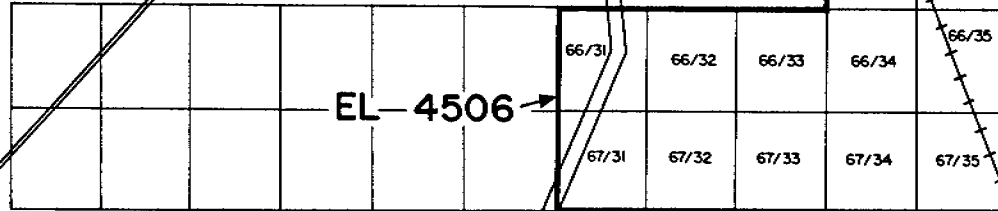

EL-4506

Area relinquished

67/31 Block identification number

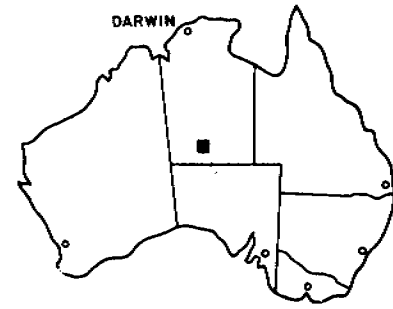

LOCATION MAP

URANERZ AUSTRALIA PTY. LTD.

ALICE SPRINGS AREA
PROJECT 8230
TENEMENT STATUS

DATE DRAWN Oct 87	FIGURE No.
PLAN No. 230D78	REPORT No.

4. INVESTIGATIONS

The licence covers the Angela and Pamela deposits, which were first located in 1973; exploration was carried out in succeeding years and by the end of 1981, had outlined a deposit of 6,000 tonnes grading 0.1 - 0.13% U_3O_8 . The project has been on a care-and-maintenance basis since 1983, due to the Federal Government policy with regard to uranium mining and, apart from efforts to attract a third joint venture partner, no exploratory work has been carried out during the life of EL 4506.

The ground was formerly held under EL's 2163 and 845 and details of reports covering work done on this project can be found in the report entitled 'Final Report on part of EL's 2163, 2570 and 2571' by S. Morete and K.S. Taylor, dated December 1983 and lodged with the department.

URANERZ AUSTRALIA PTY. LTD.

INCORPORATED IN W.A.

EXPLORATION LICENCE: 4506

STATEMENT OF EXPENDITURE

covering the period: 06 Nov. 1989 - 05 Nov. 1990

SALARIES & WAGES _____ \$1,367

DRILLING CONTRACTORS _____ \$ -

FIELD OPERATION COSTS INCLUDING
CONSUMABLES, VEHICLE OPERATING &
REPAIRS, AIRFARES, FREIGHT ETC. _____ \$ 623

DEPRECIATION OF VEHICLES AND
GEOPHYSICAL EQUIPMENT, MANAGEMENT &
DISTRIBUTION OF HEAD OFFICE COSTS _____ \$ 200

\$2,190

=====